

CHELSEA LOGISTICS CENTER

150 EASTERN AVENUE

CHELSEA, MA



**OFFICE SUITES
MOVE IN
READY**

FOR LEASE
OFFICE: 1,564-7,337 SF

URBAN AIRPORT & 3PL OFFICE SPACE AVAILABLE

PROPERTY HIGHLIGHTS

150 Eastern Avenue is a 58,064 RSF, two-story industrial/flex building in Chelsea, MA. The property is situated within Chelsea's industrial/airport overlay district (AROD), allowing for quick access to Logan Airport, Boston CBD, and Boston's major roadways (Rt. 1, Rt. 1A, I-90, and I-93). The property features 30,996 RSF of distribution/logistic space on the first floor and 27,068 RSF of high-quality office space on the second floor.

BUILDING SPECS

Year Built:	1987 / Renovated 2015
Building Size:	58,064 RSF - 1st floor: 30,996 SF - 2nd floor: 27,068 SF
Office Space Available:	Suite 1: 7,337 SF (Divisible to 3,080 SF) Suite 2: 1,564 SF Suite 3: 3,385 SF
Site Area:	3.4 Acres
Parking:	1/1,000 SF
Sprinkler:	Wet system
Power:	800-Amps, 3 phase
Zoning:	Industrial / Airport Related Overlay District (AROD)



CURRENT AVAILABILITIES

SECOND FLOOR: 1,564 SF - 7,337 SF AVAILABLE

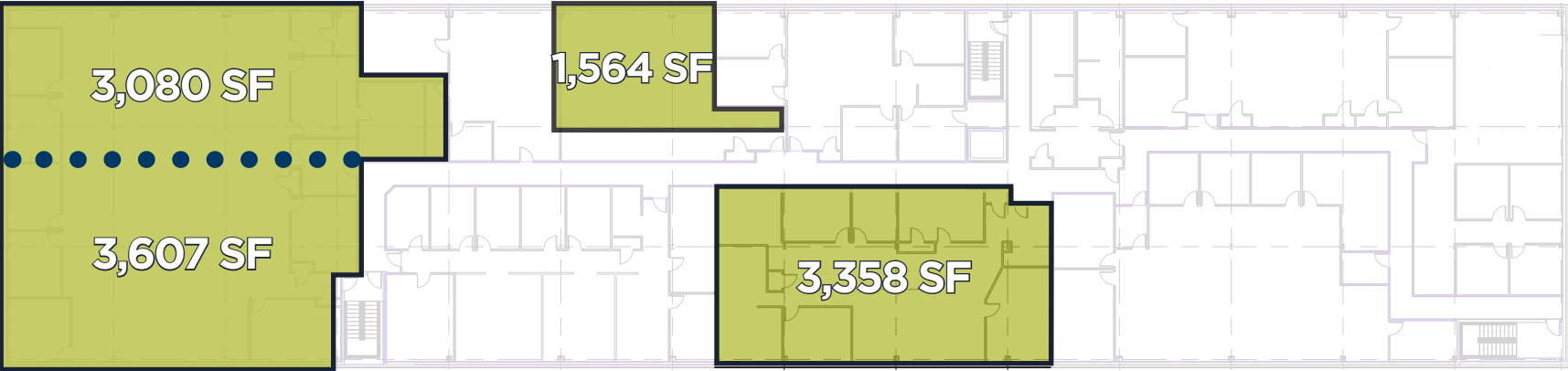



A DRIVING WORKFORCE



803,907
POPULATION
Within 10 Miles



\$83,489
AVG. INCOME
Within 10 Miles



\$665,948
AVG. HOME VALUE
Within 10 Miles



33
AVG. AGE
Within 10 Miles

3,911,415
POPULATION
Within 20 Miles

\$84,409
AVG. INCOME
Within 20 Miles

\$662,370
AVG. HOME VALUE
Within 20 Miles

38
AVG. AGE
Within 20 Miles



1.5 MILES
TO ROUTE 1

1.7 MILES
TO ROUTE 1A

2 MILES
TO MASS PIKE

2 MILES
TO LOGAN AIRPORT

3 MILES
TO BOSTON

4 MILES
TO INTERSTATE 93

CONTACT INFORMATION

PHILIP VERRE

philip.verre@cushwake.com
+1 617 204 4124

SCOTT GREDLER

scott.gredler@cushwake.com
+1 617 204 5975

JIM MURPHY

jim.r.murphy@cushwake.com
+1 617 204 4168

