

SKETCH ADDENDUM

File No. 25039640m
Case No.

Borrower						
Property Address 2548 Broadway Street						
City New Albany	County	Floyd	State	IN	Zip Code	47150
Lender/Client		Address				

INTERIOR WALLS ARE APPROXIMATE

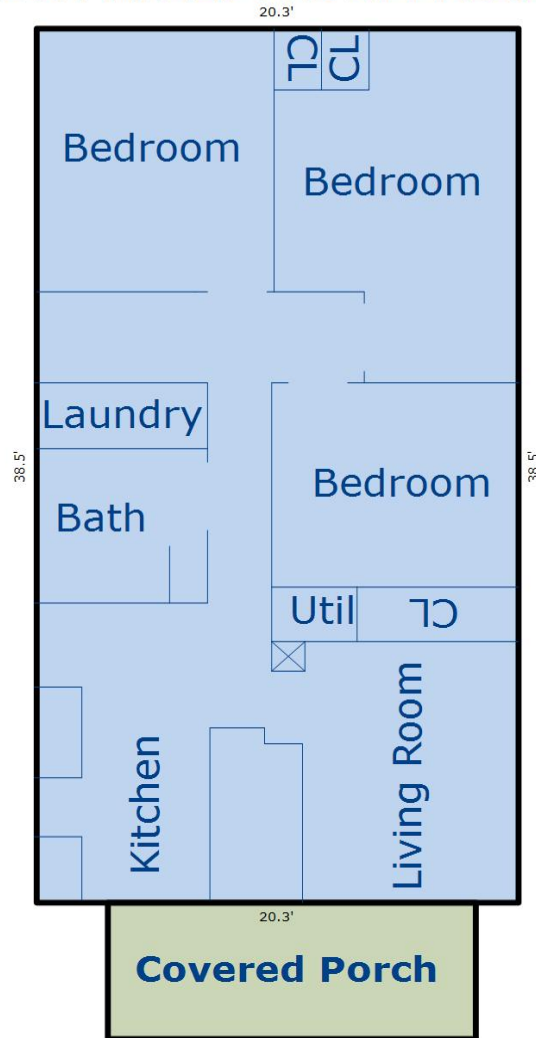

Sketch by ApexSketch

AREA CALCULATIONS SUMMARY						AREA CALCULATIONS BREAKDOWN				
Code	Description	Factor	Net Size	Perimeter	Net Totals	Name	Base x	Height x	Width =	Area
GLA1	First Floor	1.0	781.6	117.6	781.6	First Floor		38.5 x	20.3 =	781.6
Net LIVABLE						1 total items			(rounded)	782

© iLOOKABOUT (US) Inc. dba Apex Software