



FOR LEASE

1801 S Ocean Drive - Unit K&J
HALLANDALE BEACH, FL 33009



FOR LEASE

Apex Capital Realty is thrilled to offer an outstanding opportunity to lease prime commercial space on the ground floor of Imperial Towers, a prestigious 420-unit luxury condominium in one of Hallandale Beach’s most sought-after locations. Just steps from the ocean and minutes from an array of other upscale condos and hotels, this space is perfectly positioned to attract a steady flow of high-end clientele. Its strategic location provides unparalleled visibility and brand exposure, making it an ideal spot for businesses looking to capitalize on the vibrant, affluent community and the steady influx of visitors drawn to the area.



1801 S OCEAN DR - UNIT K&J, HALLANDALE BEACH, FL 33009

Building SF	9,354 SF
Units	7
Units Available	1
GLA Available	2,432 SF
Allowable Uses	House of worship, public/private schools, public facilities/utilities, food store, beauty shop, restaurant, lounges, medical and professional offices.
Asking Rent	\$35 Modified Gross



FLOOR PLAN

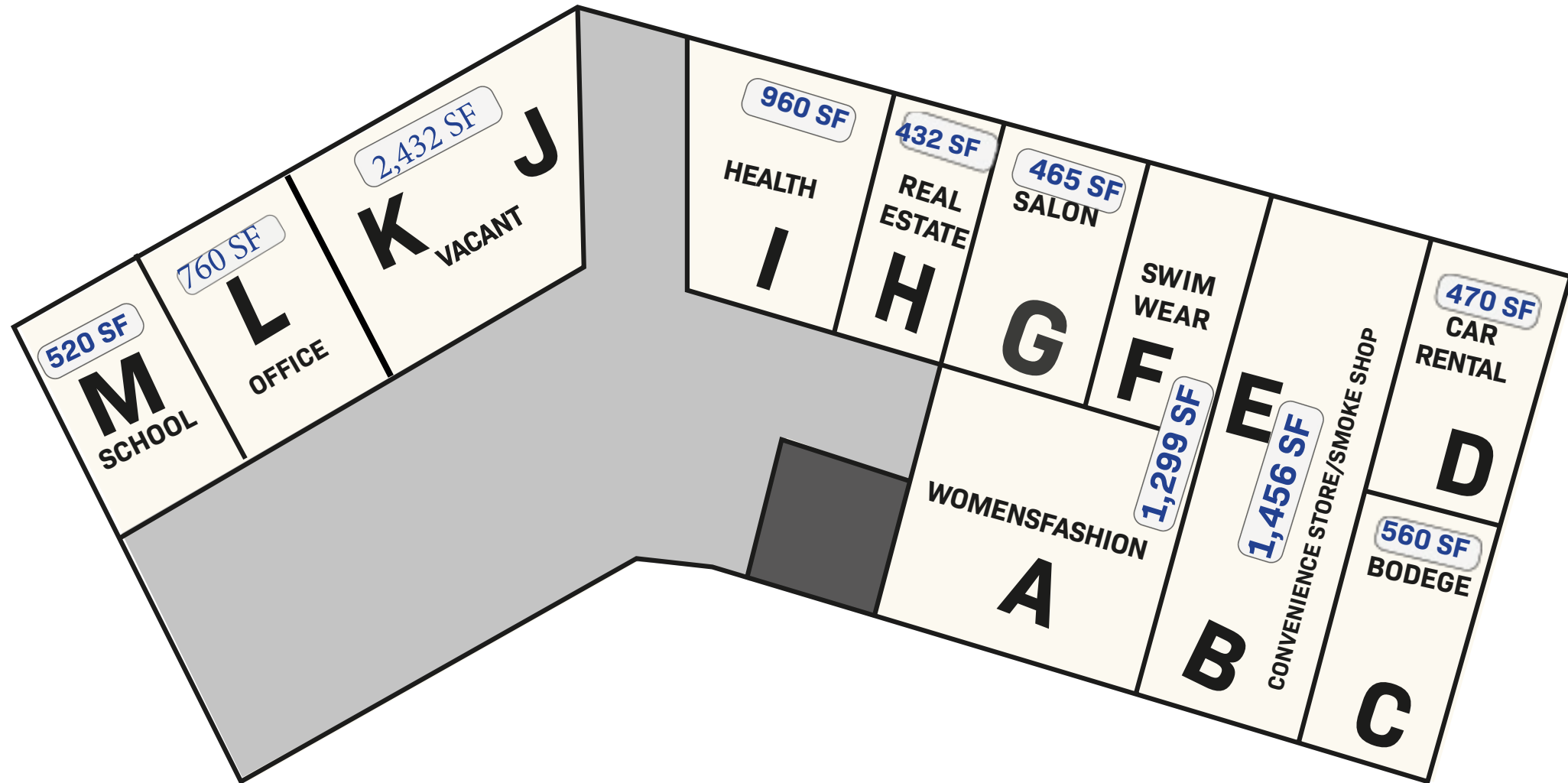



INTERIOR PHOTOS







APEX
CAPITAL REALTY

CONTACT US

YONI SUNSHINE

COMERCIAL ADVISOR

(216) 973-9534

YONI@APEXCAPITALREALTY.COM

JASON ABITBOL

COMERCIAL ADVISOR

(561) 542-3704

JASON@APEXCAPITALREALTY.COM

APEXCAPITALREALTY.COM

