



RETAIL  
LEASE

# BONNEY LAKE VILLAGE SHOPPING CENTER

21107 - 21291 State Route 410 E | Bonney Lake, WA

**Jack Rosen**

425.289.2221

jack@rosenharbottle.com

**Stossi Tsantilas**

425.279.7943

stossit@rosenharbottle.com

425.454.3030  
rosenharbottle.com

PO Box 5003  
Bellevue, WA 98009 - 5003





# SAFEWAY ANCHORED RETAIL SHOPPING CENTER

## 607 SF Available

### LOCATION FEATURES:

- Other Anchored Retailers include Goodwill, Ben Franklin, Taco Bell, US Bank, and Round Table
- Neighboring Retailers: Costco, Walmart, Fred Meyer, and Target
- Close Proximity to the New and Growing Tehaleh Residential Development
- Abundant Parking



### DEMOGRAPHICS:

	1 Mile	3 Miles	5 Miles
2023 Population	6,621	49,637	210,067
2028 Population Projection	6,842	49,939	216,117
2023 Avg. HH Income	\$98,767	\$106,666	\$102,993

The information provided herein has been obtained from sources believed to be reliable, but no representation or warranty, express or implied, is made with respect to the accuracy or completeness of any such information. Each prospective buyer or tenant should independently investigate, evaluate and verify all information provided herein and any other matters deemed material. Please consult your attorney, tax advisor or other professional advisor. The terms of sale or lease set forth herein are subject to change or withdrawal at any time and without notice.

# BUILDING B-E FLOOR PLAN

Suite	Square Feet	Rent	Notes
B3 (21191)	607 SF	\$1,950/Month, NNN	Rare small in-line retail space with great exposure and one restroom. <b>Available with 60 days' notice.</b>

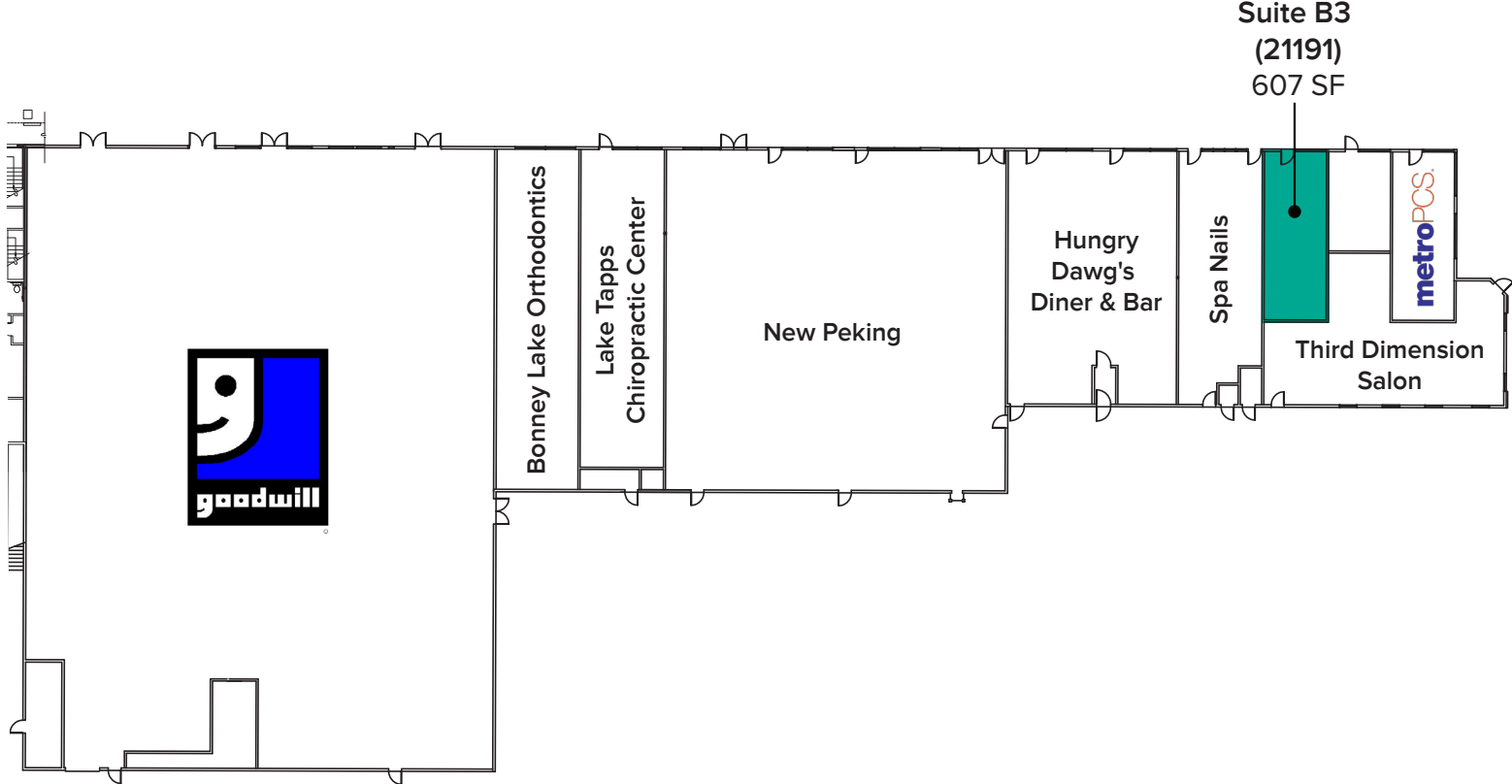

The information provided herein has been obtained from sources believed to be reliable, but no representation or warranty, express or implied, is made with respect to the accuracy or completeness of any such information. Each prospective buyer or tenant should independently investigate, evaluate and verify all information provided herein and any other matters deemed material. Please consult your attorney, tax advisor or other professional advisor. The terms of sale or lease set forth herein are subject to change or withdrawal at any time and without notice.

# SITE PLAN

Suite B3  
(21191)  
607 SF



The information provided herein has been obtained from sources believed to be reliable, but no representation or warranty, express or implied, is made with respect to the accuracy or completeness of any such information. Each prospective buyer or tenant should independently investigate, evaluate and verify all information provided herein and any other matters deemed material. Please consult your attorney, tax advisor or other professional advisor. The terms of sale or lease set forth herein are subject to change or withdrawal at any time and without notice.

# LOCATION MAP

