

## MIXED-USE - MULTI-TENANT



### Property Highlights

Available	2,650 SF ± Office/Showroom 3,350 SF ± Warehouse/Storage 6,000 SF Total ±
Lease Rate	\$0.70/SF/Month
Lease Type	NNN Est. \$0.17/SF/Month
Building Size	12,000 SF Total
Zoning	City of Boise C-3D
Power	3 Phase
Clear Height	12 Feet
Overhead Doors	1 - 12'X10' Grade-Level
Availability	June 1st, 2020
LockBox	No, Contact Agents to Schedule

### Listing Features

- Mixed use multi-tenant flex building available for lease in southeast Boise
- Available space consists of reception area, private offices, open work areas, kitchenette, conference/showroom, storage area warehouse & four private restrooms one with shower
- Large on-site parking area provides ample space for customers and staff - 24 stalls +/-
- Excellent visibility from Interstate 84 near exit 53
- Easily accessible from Vista Avenue and Airport Way
- Surrounding businesses include Jackson Jet Center, Boise Airport, Chevron, Rodeway Inn, Best Western, Copper Kitchen, Denny's, McDonald's & Quality Inn



**Rhonda Garland, CCIM**  
Director  
Investment/Land Specialist  
+1 208 287 8905  
rhonda.garland@paccra.com

999 West Main Street, Ste 1300  
Boise, Idaho 83702  
Main +1 208 287 9500  
Fax +1 208 287 9501  
**paccra.com**

# Wright Street Industrial-Flex Space

3555-3559 West Wright Street, Boise, Idaho 83705

3559 West Wright St - 6,000 SF Available - \$0.70/SF/Month NNN (Est. \$0.17/SF/Month)

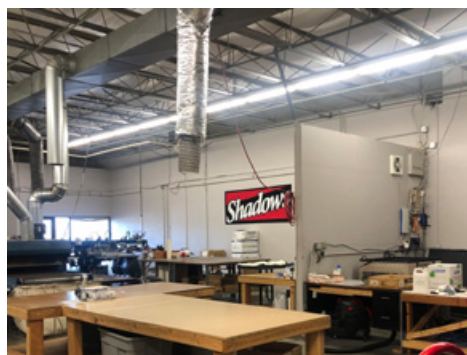

# Wright Street Industrial-Flex Space

3555-3559 West Wright Street, Boise, Idaho 83705

3559 West Wright St - 6,000 SF Available - \$0.70/SF/Month NNN (Est. \$0.17/SF/Month)

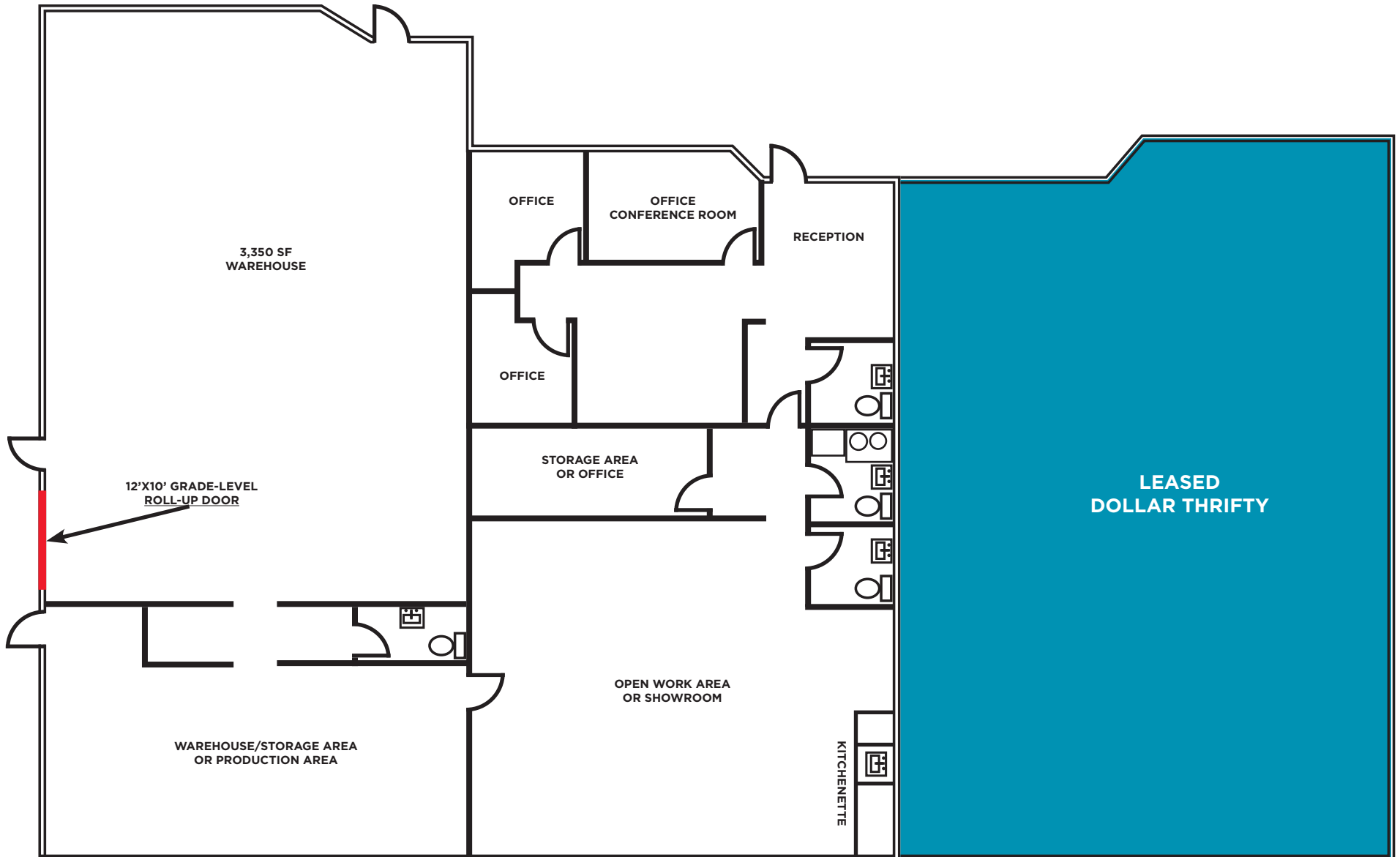

FOR LEASE

# Wright Street Industrial-Flex Space

3555-3559 West Wright Street, Boise, Idaho 83705

DEMOGRAPHICS	1 MILE	3 MILE	5 MILE
<b>POPULATION</b>			
2018 Estimated Population	7,158	64,560	168,017
2023 Projected Population	7,502	68,292	180,177
<b>HOUSEHOLDS</b>			
2018 Estimated Households	3,119	29,168	71,613
2023 Projected Households	3,272	31,016	76,980
2018 Est. Average HH Income	\$60,006	\$61,919	\$72,205
2023 Est. Average HH Income	\$68,643	\$71,455	\$83,280
<b>BUSINESSES / EMPLOYEES</b>			
Total Businesses	257	3,363	9,328
Total Employees	4,432	52,330	157,431

SOURCE: U.S. BUREAU OF THE CENSUS, 2010 CENSUS OF POPULATION AND HOUSING. ESRI FORECASTS FOR 2018 AND 2023. ESRI CONVERTED CENSUS 2000 DATA INTO 2010 GEOGRAPHY.



Independently Owned and Operated / A Member of the Cushman & Wakefield Alliance

Cushman & Wakefield Copyright 2015. No warranty or representation, express or implied, is made to the accuracy or completeness of the information contained herein, and same is submitted subject to errors, omissions, change of price, rental or other conditions, withdrawal without notice, and to any special listing conditions imposed by the property owner(s). As applicable, we make no representation as to the condition of the property (or properties) in question.