



FOR SUBLEASE

Former Walgreens

40 Chester Avenue, Bakersfield, CA 93301



Former Walgreens

40 Chester Avenue, Bakersfield, CA 93301

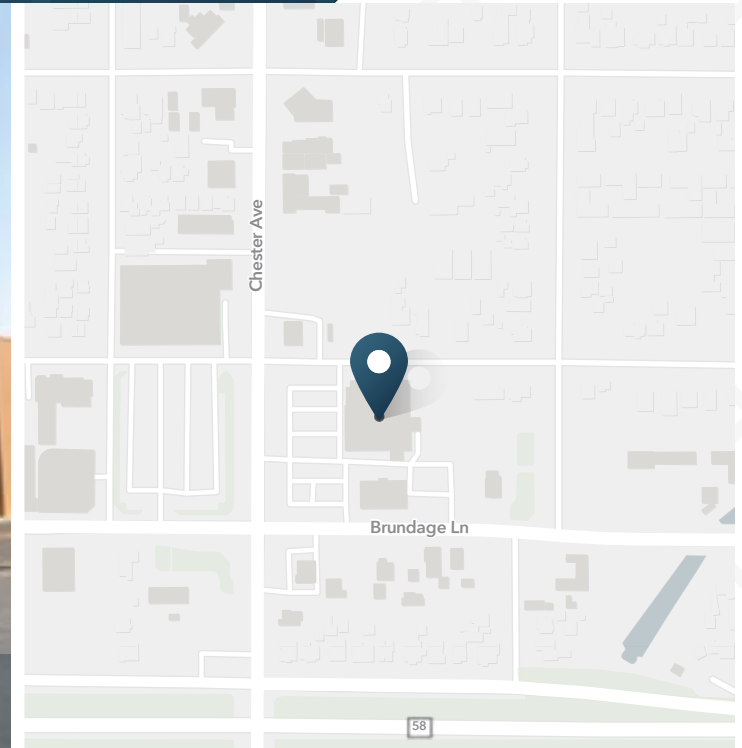

14,750 SF
Available

9/30/2029
Lease End Date

\$14 PSF/yr (MG)
Asking Base Rent

DESCRIPTION

Former Walgreens. All offers are subject to approval by Walgreens Real Estate Committee.

- Central Bakersfield location
- Easy access to Highway 58
- Surrounded by daily needs users
- Large pylon sign available

TRAFFIC COUNTS

Chester Ave	18,347 VPD
Brundage Ln	14,468 VPD
Year: 2022 Source: Costar	

NEARBY RETAILERS



Former Walgreens

40 Chester Avenue, Bakersfield, CA 93301



Former Walgreens

40 Chester Avenue, Bakersfield, CA 93301



Chester Ave

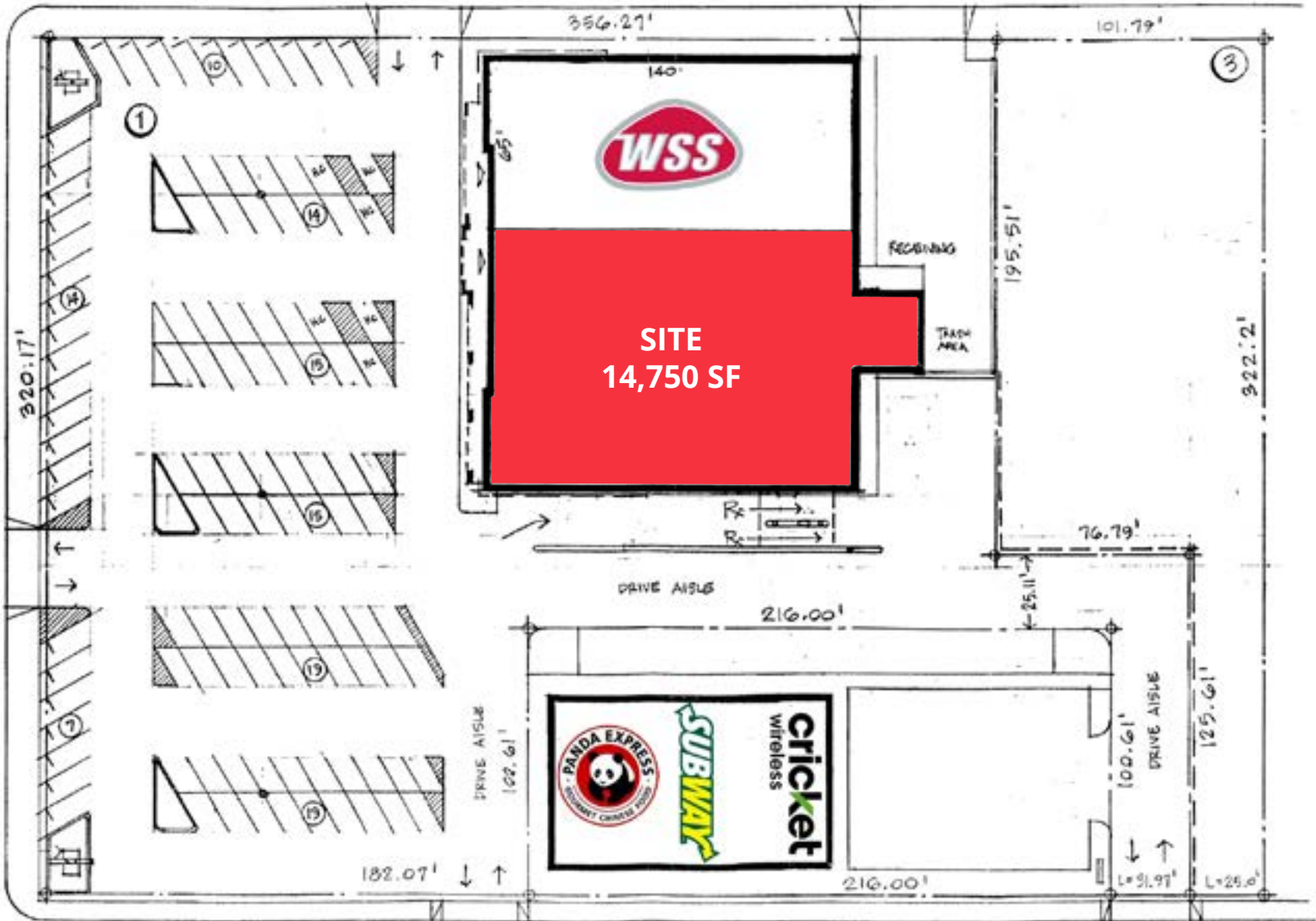

Brundage Ln

Former Walgreens

40 Chester Avenue, Bakersfield, CA 93301

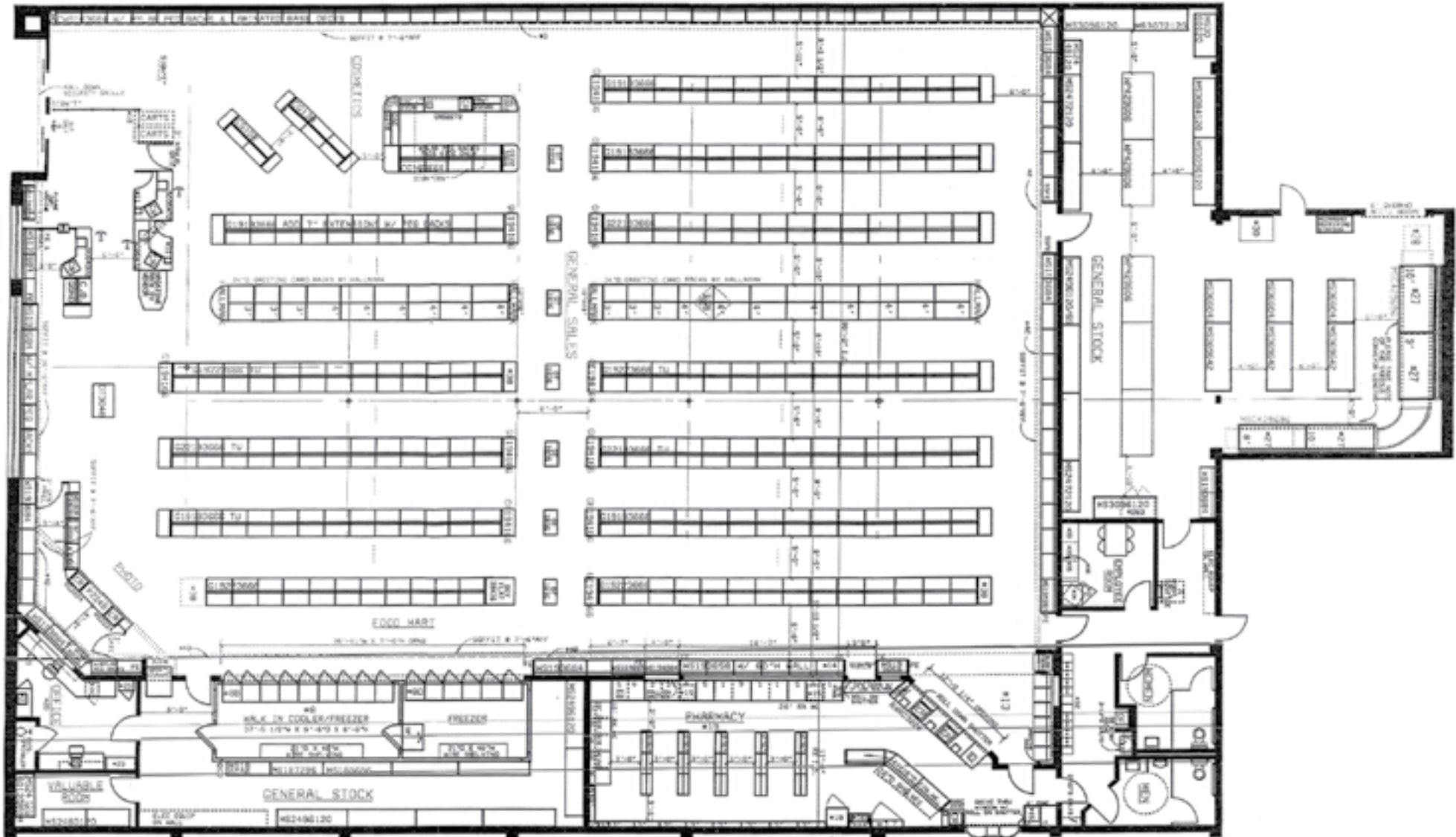

Former Walgreens

40 Chester Avenue, Bakersfield, CA 93301



DEMOGRAPHIC HIGHLIGHTS

1 MILE

20,474 Population	18,759 Total Daytime Population	\$55,773 Average Household Income	6,792 Total Households
----------------------	---------------------------------------	---	------------------------------

3 MILES

140,853 Population	177,283 Total Daytime Population	\$57,580 Average Household Income	45,791 Total Households
-----------------------	--	---	-------------------------------

5 MILES

337,007 Population	363,525 Total Daytime Population	\$69,894 Average Household Income	106,737 Total Households
-----------------------	--	---	--------------------------------

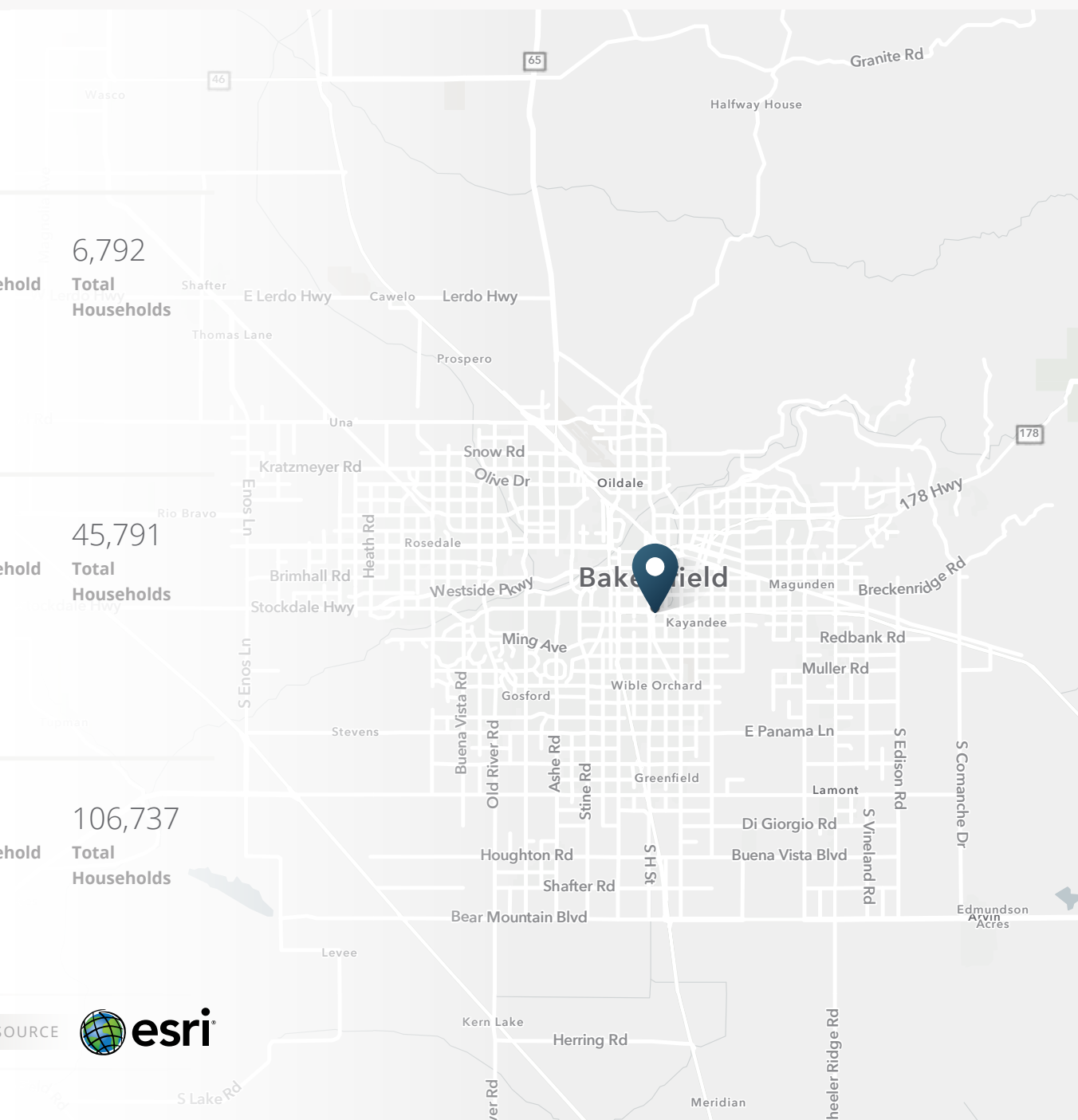

> **Want more?** Contact us for a complete demographic, foot-traffic, and mobile data insights report.





Matthew Alexander

EVP & Partner

415.908.4938

matt.alexander@srsre.com

CA License No. 00883993



Garret Tuckness

Sr. Vice President & Principal

661.631.3811

garret.tuckness@colliers.com

CA License No. 001323185

SRSRE.COM

© SRS Real Estate Partners

The information presented was obtained from sources deemed reliable;
however SRS Real Estate Partners and Colliers do not guarantee its completeness or accuracy.