

SPACE FOR LEASE Retail, Office and Medical Office Space

GATLIN SQUARE



1449 SW Gatlin Boulevard, Port St. Lucie, FL 34953

BRAY REALTY ADVISORS

PROPERTY STATS:

Building Space: 17,900 +/- GSF
Bay Depth: 60—70 ft +/-
Bay Width: 20—30 ft +/-
Land: 1.92 +/- Acres
Parking: 89 Spaces

DESCRIPTION: This new center is a 17,900 SF +/- retail, office and medical office building in the heart of Port St. Lucie. Space can be divided into 13 bays and configured to meet your needs.

AVAILABLE UNITS:

\$44.00 NNN—\$8.00 psf

Unit 12: 2,471 SF +/- (partially built out)

\$34.00 NNN—\$8.00 psf

Unit 7: 1,184 SF +/-

Unit 9: 1,077 SF +/-

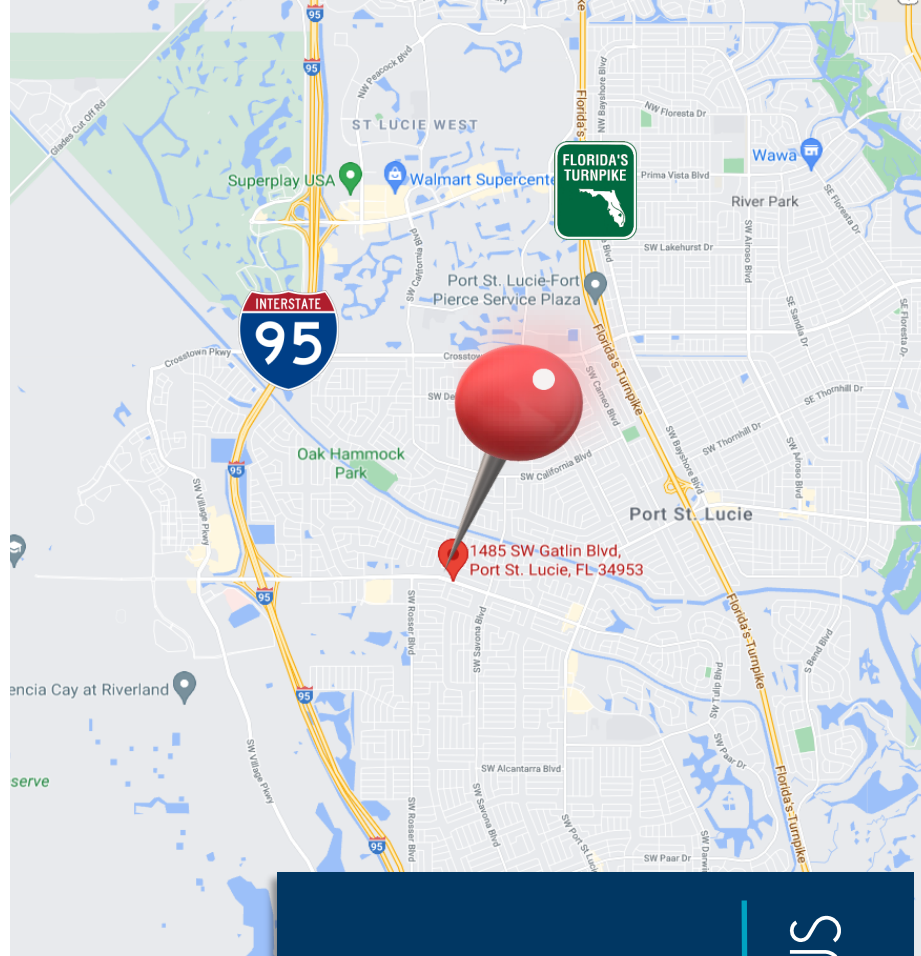

NATE BRAY
ADEMIL CASTRILLO
(561) 510-2225

CALL US



SPACE FOR LEASE

Retail, Office and Medical Office Space

GATLIN SQUARE



1449 SW Gatlin Boulevard, Port St. Lucie, FL 34953

BRAY REALTY ADVISORS

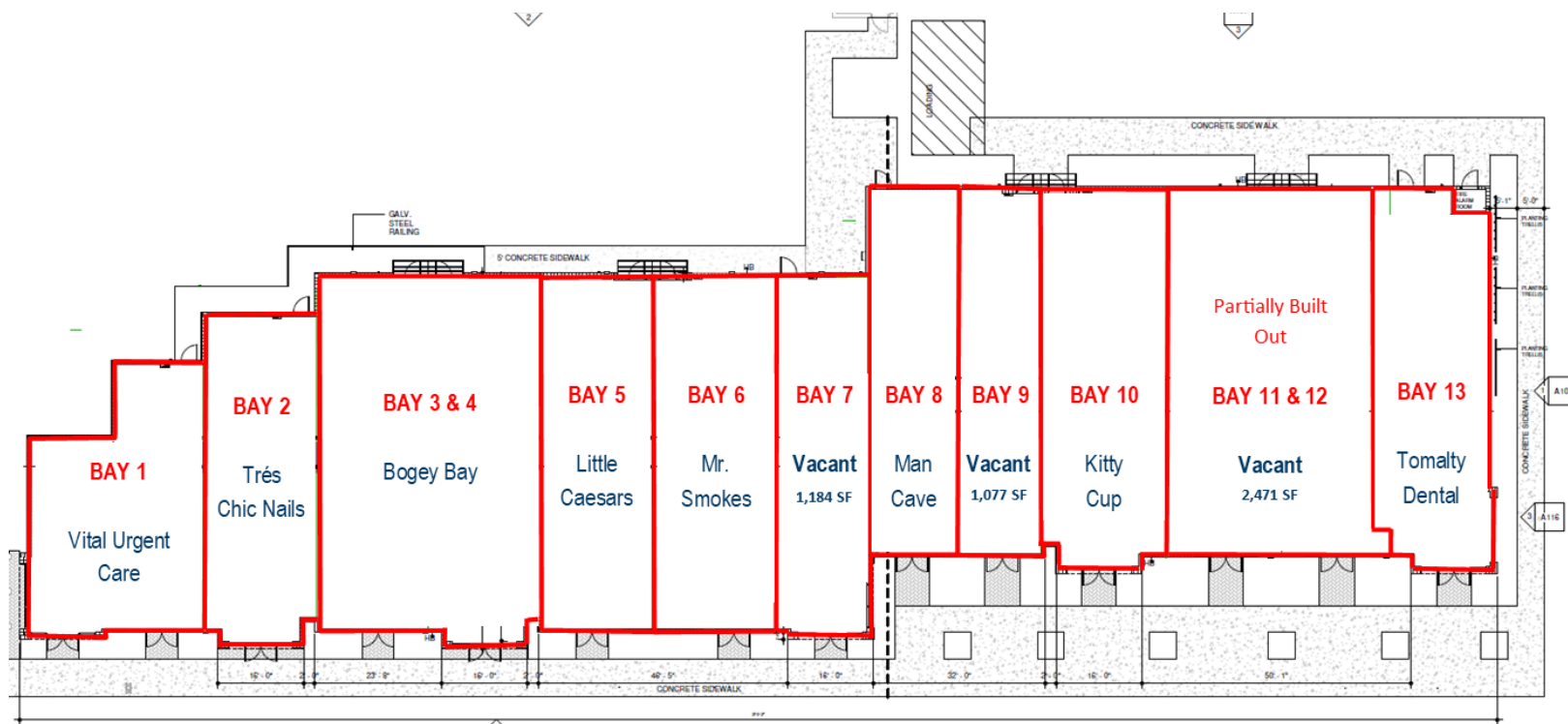

BRAY REALTY ADVISORS