



FLEX SPACE FOR LEASE

4705 NW 59TH AVE JOHNSTON, IA | 50131

MATT LUNDBERG, SIOR, CCIM
Senior Vice President
+1 515 556 8088
mlundberg@iowaca.com

ALEC WILCOX, CCIM
Vice President
+1 515 210 9446
awilcox@iowaca.com



**CUSHMAN &
WAKEFIELD**

Iowa Commercial Advisors



PROPERTY HIGHLIGHTS

- New construction
- Landlord will build-to-suit office space
- Excellent visibility on Beaver Ave
- 18' clear height
- 12' x 12' drive-in door
- Corner suite available
- Zoned M-1: Light Industrial

DEMOGRAPHICS	1 Mile	3 Miles	5 Miles
Population	3,476	41,605	158,281
AVG. HH Income	\$98,584	\$111,367	\$119,041
Total Households	1,529	16,636	62,994

LOCATION

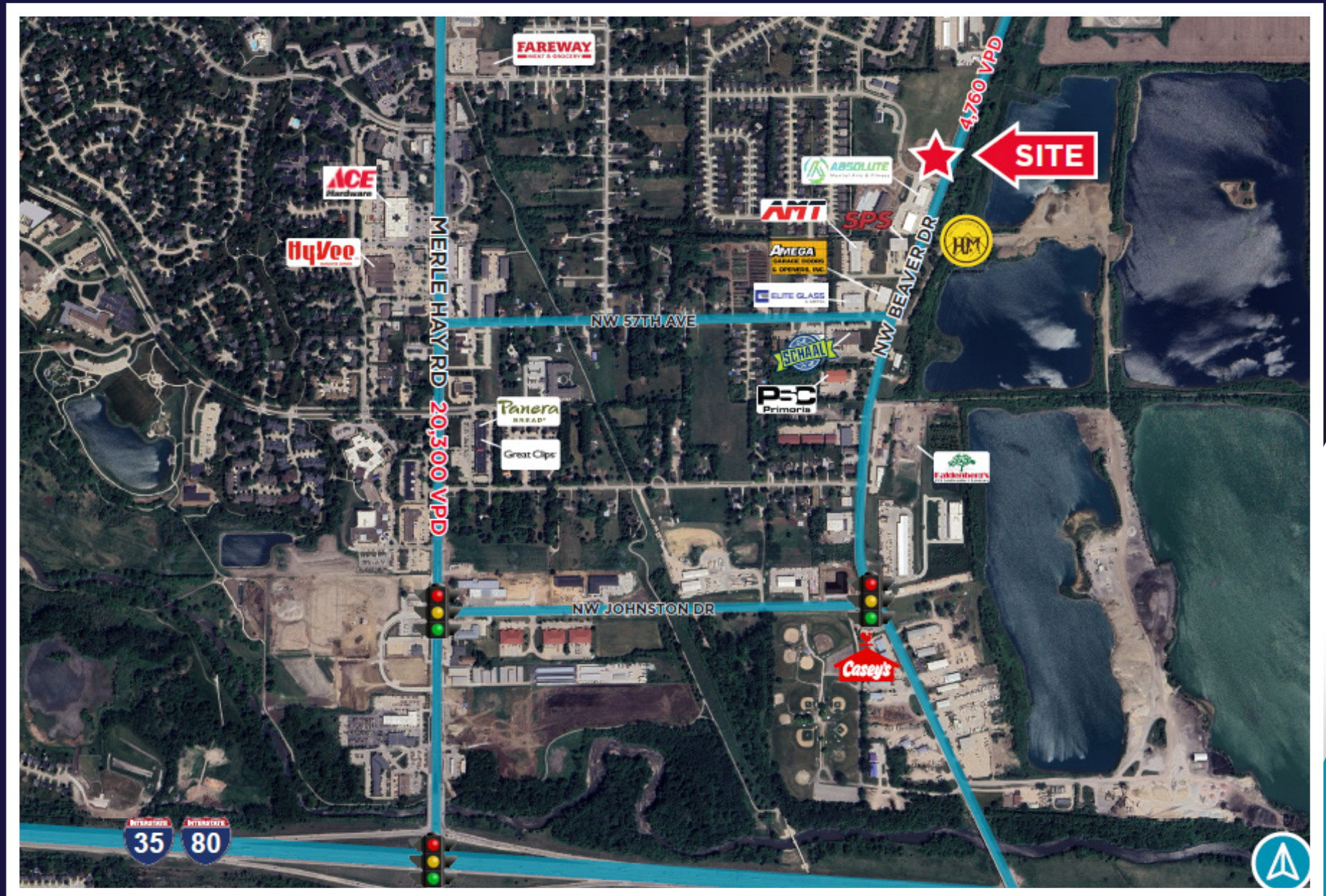



CONTACT

MATT LUNDBERG, SIOR, CCIM

Senior Vice President

+1 515 556 8088

mlundberg@iowaca.com

ALEC WILCOX, CCIM

Vice President

+1 515 210 9446

awilcox@iowaca.com



**CUSHMAN &
WAKEFIELD**

Iowa Commercial Advisors

Independently Owned and Operated / A Member of the Cushman & Wakefield Alliance

©2025 Cushman & Wakefield. All rights reserved. The information contained in this communication is strictly confidential. This information has been obtained from sources believed to be reliable but has not been verified. No warranty or representation, express or implied, is made as to the condition of the property (or properties) referenced herein or as to the accuracy or completeness of the information contained herein, and same is submitted subject to errors, omissions, change of price, rental or other conditions, withdrawal without notice, and to any special listing conditions imposed by the property owner(s). Any projections, opinions or estimates are subject to uncertainty and do not signify current or future property performance.

3737 Woodland Avenue, Suite 100
West Des Moines, IA 50266
Main +1 515 309 4002
iowacommercialadvisors.com