

CLASS A SPACE FOR SUBLEASE UNTIL 10.31.21

# THE FORUM AT GILBERT RANCH

1528 E. WILLIAMS FIELD ROAD  
GILBERT, AZ 85295



**MICHAEL WAXMAN**  
Partner  
480.294.6004  
mwaxman@levrose.com

**FOSTER BUNDY**  
Advisor  
480.289.4505  
fbundy@levrose.com

**LEVROSE**  
COMMERCIAL REAL ESTATE

**TCN**  
COMMERCIAL REAL ESTATE SERVICES

# PROPERTY SUMMARY

AVAILABLE FOR SUBLEASE

**±5,164 SF**

LEASE RATE

**\$28.00/SF FS**

PARKING

**5/1,000 SF**

ZONING

**C-C**

# PROPERTY FEATURES

- 5 Restaurants Located within The Project
- Easy Access to Loop 202
- Underground Garage Parking Available
- Affluent Neighborhood
- Heavy-Traffic Intersection
- Growing Gilbert Community
- Upscale Mixed Use Project
- Val Vista 31,053 VPD
- Variety of Building Signage Opportunities
- Williams Field 20,683 VPD



# FLOOR PLAN

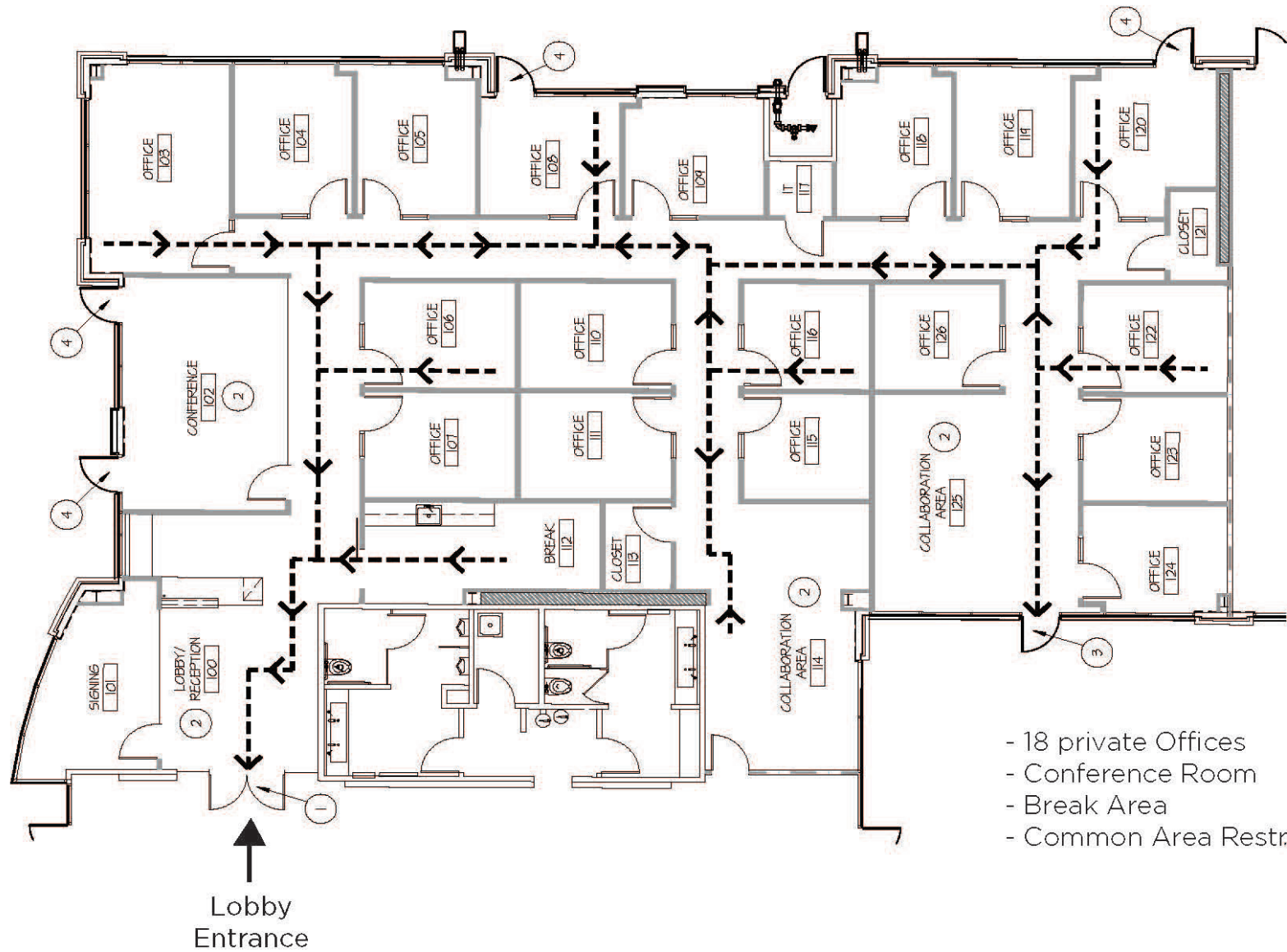

- 18 private Offices
- Conference Room
- Break Area
- Common Area Restrooms

# VIRTUAL TOUR





# AERIAL



SAN TAN VILLAGE MALL

FULL DIAMOND INTERCHANGE

LOOP 202

**THE FORUM**  
1528 E WILLIAMS FIELD RD

LOOP 202

SPECTRUM AT VAL VISTA SHOPPING CENTER

FULL DIAMOND INTERCHANGE

SANTAN VILLAGE PKWY

WILLIAMS FIELD ROAD

VAL VISTA DRIVE

VAL VISTA DRIVE

# AERIAL

1528 E. WILLIAMS  
FIELD ROAD

E. WILLIAMS FIELD ROAD - 22,000 VPD

**KOHL'S**  
**CVS pharmacy**  
**BMO**  
**BURGER KING**  
**SONIC**  
**SUBWAY**  
**Blue 32**  
**Sodalicious**  
**EINSTEIN BREADS**  
**PET CLUB**  
**Filiberto's**  
**SPROUTS FARMER MARKET**  
**Starbucks COFFEE**  
**Isabel's AMOR**  
**COBBLESTONE AUTO SPA**  
**Tuesday Morning**  
**BARBIO'S**  
**elements massage**  
**Cane's CHICKEN FINGER**  
**PATA JUNGLE**  
**DOLLAR TREE**

**NATURAL GROCERS**  
**FirstWatch The Daytime Cafe**  
**TONI&GUY HAIRDRESSING**  
**Panera BREAD**

**BIG LOTS!**  
**USbank**  
**OLD NAVY**  
**ME Massage Envy**  
**Wendy's**  
**Marshalls**  
**KIRKLAND'S**  
**JO-ANN fabric and craft stores**  
**ULTA BEAUTY**  
**MATTRESS FIRM**  
**CARRABBA'S ITALIAN GRILL**  
**hi-health**  
**GameStop**  
**T-Mobile**  
**OfficeMax**

**noodles company**  
**menchie's frozen yogurt**  
**National Bank OF ARIZONA**  
**PET DEPOT**  
**MIDFIRST BANK**  
**the Habit BURGER GRILL**  
**Arby's**  
**Cafe Rio MEXICAN GRILL**  
**COSTCO WHOLESALE**  
**Great Clips**  
**WinCo FOODS**  
**Starbucks COFFEE**  
**LOUISIANA HOTCHES**  
**MOD PIZZA**  
**TACO BELL**  
**LONG JOHN SILVER'S**

**DICK'S SPORTING GOODS**  
**BEST BUY**  
**macy's**  
**Dillard's**  
**BARNES & NOBLE BOOKSELLERS**  
**H&M**  
**Starbucks COFFEE**  
**at&t**  
**GRIMALDI'S COAL BRICK-OPEN PIZZERIA**  
**RED ROBIN BOLDLY DIFFERENT**  
**Panera BREAD**  
**tropical smoothie CAFE**  
**BRIO tucan grille**  
**G&B**  
**CHIPOTE MEXICAN GRILL**  
**Harkins Theatres**

**WAL-MART**  
**Sams CLUB**  
**Bank of America**  
**DISCOUNT TIRE**  
**Chick-fil-Ste**  
**SUPERCUTS**  
**Sprint**  
**IN-N-OUT BURGER**

S VAL VISTA DR - 32,200 VPD

LOOP 202