



RETAIL OPPORTUNITY

567 SF

645 MARKET STREET
SAN FRANCISCO | CA

maven
RETAIL

FEATURES



- 567 SF in the busy intersection of New Montgomery and Market Street
- Located in the historical Palace Hotel
- Steps from the Montgomery/Powell BART and MUNI stations
- Beautiful historic facade
- Soaring Ceilings
- Daily exposure to hotel guests, office workers, and tourists
- Noteworthy neighbors: SFMOMA, Museum of African Diaspora, The Contemporary Jewish Museum. World class hotels including: The Four Seasons, St. Regis, The W Hotel and the historic Palace Hotel. Additionally nearby great bars/restaurants: Benu, Taksim, Yokai, Dawn Club, House of Shields, Sentinel, Shoji Café, Novela and more.

FLOOR PLAN

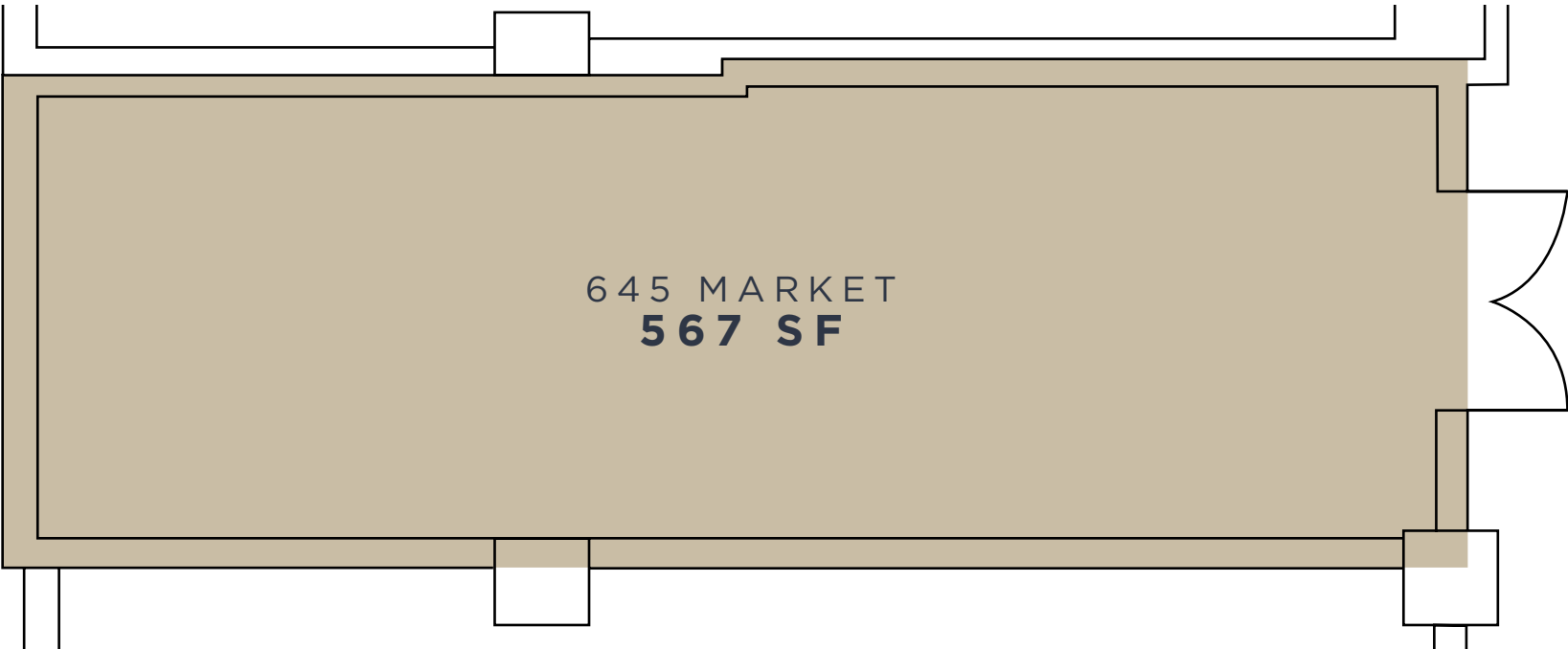

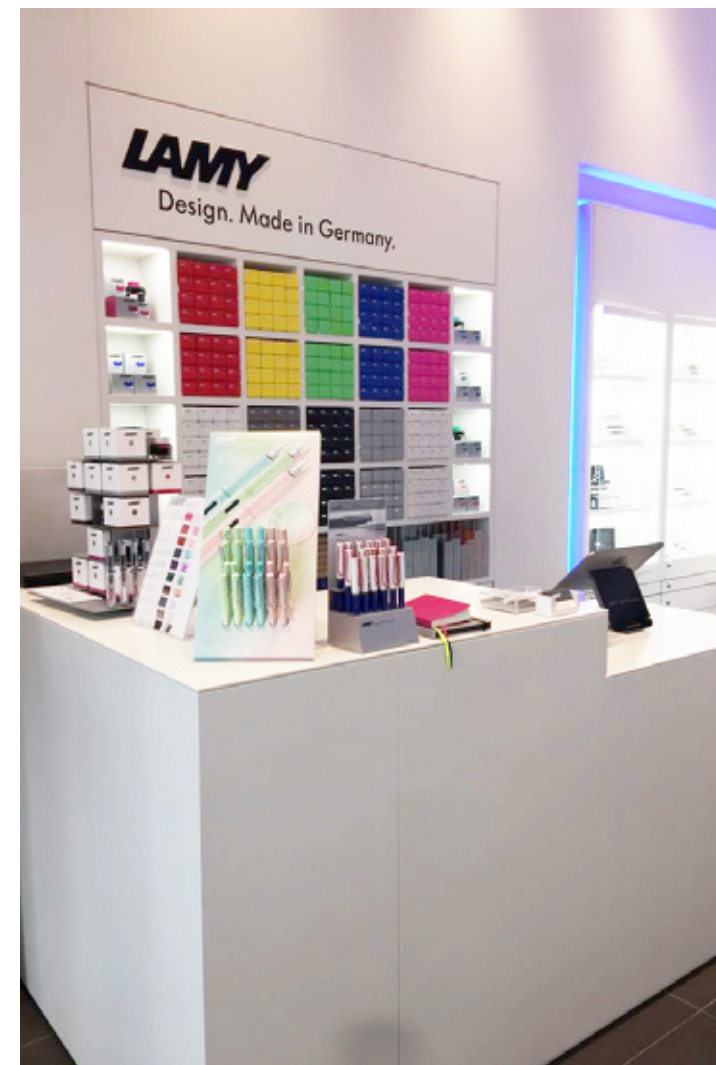



645 MARKET ST

645 MARKET is located in the historic Palace Hotel, one of the city's oldest and most iconic hotels. Steps from San Francisco's Union Square shopping district, this stunning hotel is known for its grand architecture, opulent interiors, and luxurious amenities, including the famous Garden Court and Pied Piper Bar.



FOUR SEASONS



MOLESKINE



ACNE STUDIOS



YSL



SF MOMA



GOYARD



BOTTEGA VENETA



BRUNELLO CUCINELLI

UNION SQUARE

San Francisco's Union Square retail district is one of the most coveted retail destinations in the United States. Known for its vibrant entertainment, shopping & dining culture, Union Square is brimming with the city's finest specialty stores, art galleries, designer boutiques, and many well-known, national retailers.

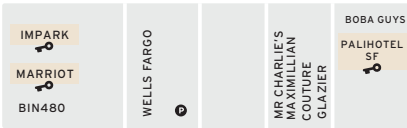

SUTTER

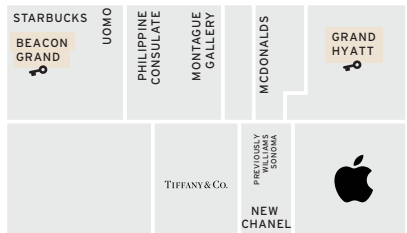

POST



GEARY

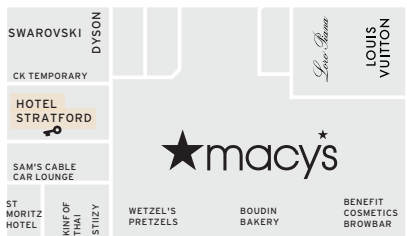

O' FARRELL

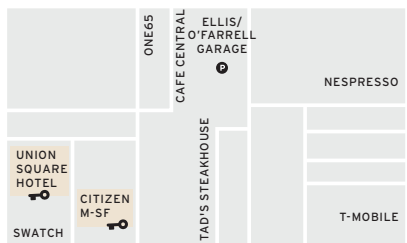

ELLIS



POST



GEARY

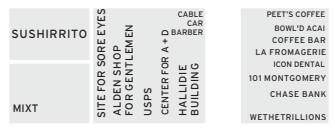
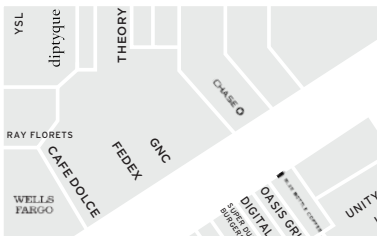

SUTTER

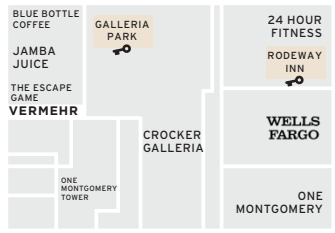

POST



SUTTER

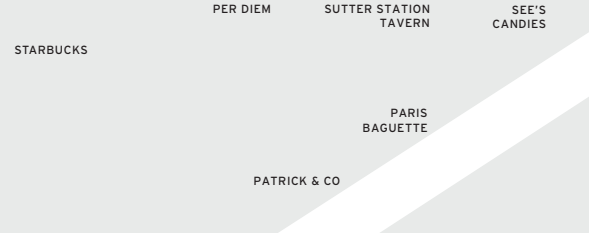

POST

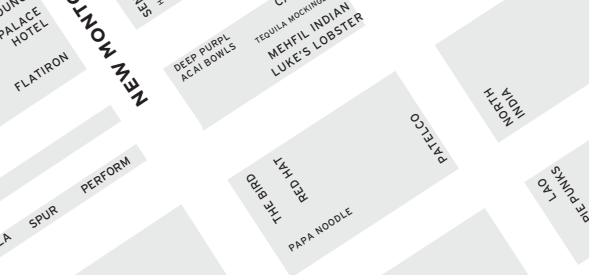
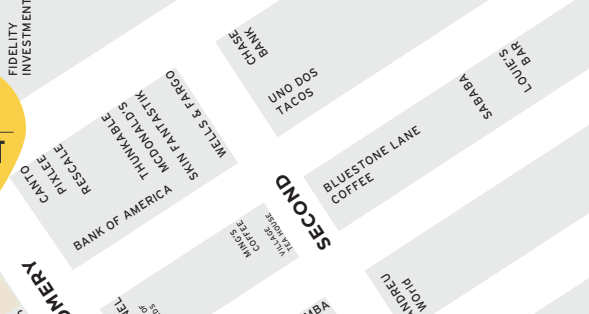

GEARY

UNION SQUARE BY THE NUMBERS

TOURISM



25+ Million

Visitors annually

40%

Retail sales are accounted by 1/3 of all visitors

90.6%

Average hotel Occupancy

60%

of San Francisco's hotels are within 5-minute walk

\$10.7B

Were the annual amount spent by visitors and tourists in San Francisco

\$276

Average daily hotel rate

DEMOGRAPHICS



4,729,484

San Francisco Metropolitan Area population

\$149,589

Average resident HH income

70+

Events are hosted annually near Mid-Market

RESIDENTIAL/OFFICE



727,701

Total daytime employees (3 miles)

41,757

Total business establishments (3 miles)

12,000

New residential units between Mid-Market and Van Ness

TRANSPORTATION



158,000

Average daily BART riders

20 Minutes

from Montgomery station

327,269

Average riders from Montgomery station

(Steps from Montgomery Street Bart Station)



maven
RETAIL • OFFICE • INDUSTRIAL

645 MARKET ST

- FOR LEASE -

**ALI
MCEVOY**

415.404.7343
ali@mavenproperties.com
DRE #01930635

**PAM
MENDELSON**

415.404.6650
pam@mavenproperties.com
DRE #00953050

**GLORIA
NORDBAKK**

415.225.0626
gloria@mavenproperties.com
DRE #02207407

**SAGE
MIRSKY**

907.821.1049
sage@mavenproperties.com
DRE #02238781

NOTICE: This information has been secured from sources we believe to be reliable but we make no representations, warranties, express or implied, as to the accuracy of the information. Listing broker has been given enough information to provide only a preliminary interest in the property. The materials are not to be considered fact. The information contained herein is not a substitute for thorough due diligence investigation. References to square footage, zoning, use, or age are approximate. Please contact the San Francisco Planning Department to verify zoning at (415) 558-6378, as neither broker or landlord represent that this space is suitable for your use. Tenant or Buyer must verify the information at their own expense and bears all the risk for any inaccuracies. By receiving these materials you are agreeing to the disclaimers set forth herein. DRE#01878802