

SECTION 20  
TOWNSHIP 27 SOUTH  
RANGE 18 EAST  
HILLSBOROUGH COUNTY, FLORIDA

NORTH BOUNDARY OF NW 1/4 OF SW 1/4 OF SEC. 20-27-18

1344.18'

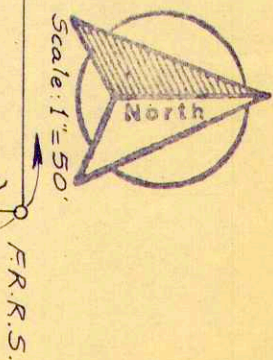

673

674

675

317' (P)

660' (P) 658.61' (F)

343' (P)

30° 08' 30" (F)

F.R.R.S.

638

TRACT 637

TRACT 636

635' (P) 635.10' (F)

635' (P) 633.94' (F)

38P STREET  
22.5' SLAG

EAST BOUNDARY OF NW 1/4 OF SW 1/4 OF SEC. 20-27-18  
(317.81')

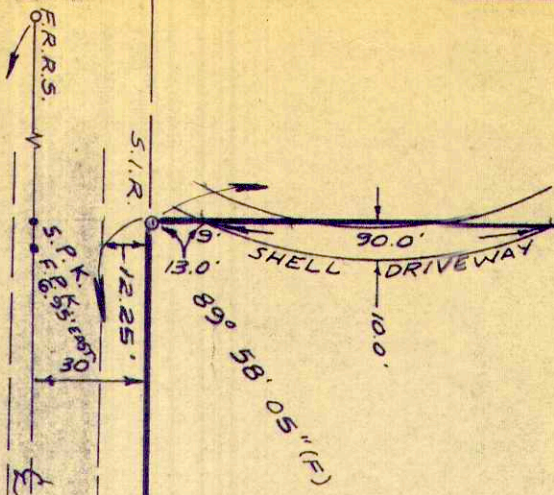

317' (P)

660' (P) 657.17' (F)

343' (P)

7th AVENUE  
24.2' ASPHALT  
1338.32'

SOUTH BOUNDARY OF NW 1/4 OF SW 1/4 OF SEC. 20-27-18

317' (P)

F.R.R.S.

DESCRIPTION:

Tracts 636 and 637, RUSKIN COLONY FARMS  
SECOND EXTENSION, as recorded in Plat  
Book 6, Page 37 of the Public Records  
of Hillsborough County, Florida.

LEGEND

- F.I.P. - Found Iron Pipe
- F.I.B. - Found Iron Rod
- S.I.P. - Set Iron Pipe
- F.C.M. - Found Concrete Monument
- S.C.M. - Set Concrete Monument
- (P) - PLAT
- S.P.K. - FIELD
- F.P.K. - FOUND P.K. MAIL
- F.R.K. - FOUND P.K. MAIL

BOUNDARY SURVEY 4-24-81  
I CERTIFY THIS PLAT TO TRULY AND CORRECTLY  
REPRESENT THE LANDS SHOWN AND DESCRIBED  
HEREON TO THE BEST OF MY KNOWLEDGE AND  
BELIEF.  
*[Signature]*  
Registered Land Surveyor  
Florida Certificate 1569  
Date 5-18-81

NOT VALID UNLESS  
EMBOSSED WITH SURVEYORS SEAL

CLIENT: MARGARET WILLIS	JOB NO: 3-81-164	DELTA ENGINEERING COMPANY civil engineers land surveyors - consultants 5611 40th St. TAMPA, FL 33610 telephone 621-9147
SCALE: 1"=50'	DATE: 4-28-81	
DRAWN: D.D.	DATE: 4-30-81	SHEET OF SHEETS
CKD: DCS	DATE: 4-30-81	
FIELD BOOK: HILLS 150	PAGE 71, 72	C. of P. J. G.