



SPECIAL PURPOSE PROPERTY FOR SALE

EDUCATION PROPERTY FOR SALE

260 BOARDMAN RD, POUGHKEEPSIE, NY 12603

BRIAN MOSSEY

Real Estate Salesperson

D. 845.288.4367

bmossey@bhhshudsonvalley.cc



BERKSHIRE HATHAWAY
HomeServices

Hudson Valley Properties



TABLE OF CONTENTS

- 1. PROPERTY INFORMATION** **3**
- Executive Summary 4
- Property Description 5
- Additional Photos 6
- 2. LOCATION INFORMATION** **7**
- Regional Map 8
- Location Map 9
- Site Plans 10
- Demographics Map & Report 11

All materials and information received or derived from Berkshire Hathaway HomeServices Hudson Valley Properties its directors, officers, agents, advisors, affiliates and/or any third party sources are provided without representation or warranty as to completeness, veracity, or accuracy, condition of the property, compliance or lack of compliance with applicable governmental requirements, developability or suitability, financial performance of the property, projected financial performance of the property for any party’s intended use or any and all other matters.

Neither Berkshire Hathaway HomeServices Hudson Valley Properties its directors, officers, agents, advisors, or affiliates makes any representation or warranty, express or implied, as to accuracy or completeness of the any materials or information provided, derived, or received. Materials and information from any source, whether written or verbal, that may be furnished for review are not a substitute for a party’s active conduct of its own due diligence to determine these and other matters of significance to such party. Berkshire Hathaway HomeServices Hudson Valley Properties will not investigate or verify any such matters or conduct due diligence for a party unless otherwise agreed in writing.

EACH PARTY SHALL CONDUCT ITS OWN INDEPENDENT INVESTIGATION AND DUE DILIGENCE.

Any party contemplating or under contract or in escrow for a transaction is urged to verify all information and to conduct their own inspections and investigations including through appropriate third party independent professionals selected by such party. All financial data should be verified by the party including by obtaining and reading applicable documents and reports and consulting appropriate independent professionals. Berkshire Hathaway HomeServices Hudson Valley Properties makes no warranties and/or representations regarding the veracity, completeness, or relevance of any financial data or assumptions. Berkshire Hathaway HomeServices Hudson Valley Properties does not serve as a financial advisor to any party regarding any proposed transaction. All data and assumptions regarding financial performance, including that used for financial modeling purposes, may differ from actual data or performance. Any estimates of market rents and/or projected rents that may be provided to a party do not necessarily mean that rents can be established at or increased to that level. Parties must evaluate any applicable contractual and governmental limitations as well as market conditions, vacancy factors and other issues in order to determine rents from or for the property.

Legal questions should be discussed by the party with an attorney. Tax questions should be discussed by the party with a certified public accountant or tax attorney. Title questions should be discussed by the party with a title officer or attorney. Questions regarding the condition of the property and whether the property complies with applicable governmental requirements should be discussed by the party with appropriate engineers, architects, contractors, other consultants and governmental agencies. All properties and services are marketed by Berkshire Hathaway HomeServices Hudson Valley Properties in compliance with all applicable fair housing and equal opportunity laws.



BERKSHIRE HATHAWAY
HomeServices
Hudson Valley Properties

PROPERTY INFORMATION / 3



PRIVATE SCHOOL PROPERTY FOR SALE

260 BOARDMAN RD, POUGHKEEPSIE, NY 12603

EXECUTIVE SUMMARY



OFFERING SUMMARY

Sale Price:	\$9,800,000
Building Size:	80,635 SF
Lot Size:	34 Acres
Price / SF:	\$121.54
Zoning:	IN - Institutional
Market:	New York
Submarket:	Hudson Valley

PROPERTY OVERVIEW

This incredible ±34.17-acre property, previously an IBM research and briefing center and now the location of an independent private day school, features 80,635 sqft of learning space distributed across two buildings and recreational fields. The property also boasts solar panels to assist with energy efficiency and a cellular tower lease that produces income.

The buildings offer a wide range of room types, from standard classrooms and science labs to specialty rooms for the arts and libraries. They also include a 300-seat theater, indoor basketball court, kitchen, cafeteria, and more. The permitting zoning includes, but is not limited to, education, training centers, hospitals, clinics, laboratories, medical facilities, libraries, offices, and schools.

LOCATION OVERVIEW

This Dutchess County property is centrally located in the beautiful Hudson Valley, surrounded by a tremendous workforce and educational base. The transportation options available via I-84 and I-87, Stewart International Airport, Metro-North, and Amtrak make it a highly desirable area, allowing businesses to support local, regional, and global operations.

Local industries include advanced manufacturing, education, health sciences, information technology, logistics, food and beverage manufacturing, and agricultural businesses. Notable educational institutions and businesses in the area include Vassar College, the Culinary Institute of America, Bard College, Marist College, IBM, Dorsey, ON Semiconductor, Nuvance Health, GAP, Amazon, and Frito-Lay.



PRIVATE SCHOOL PROPERTY FOR SALE

260 BOARDMAN RD, POUGHKEEPSIE, NY 12603

PROPERTY DESCRIPTION



Add text here...

PROPERTY DESCRIPTION

Nestled within ±34.17 acres of scenic landscape, this property boasts two main buildings with a combined area of 80,635 sqft. Currently serving as an independent private day school, it was once home to an IBM research and briefing center. The layout is optimized for educational purposes and could easily be transformed into a corporate training center, office space, laboratory, or medical facility.

The Kenyon House, a Mediterranean-style former mansion spanning 24,510 square feet, is located adjacent to the athletic fields and green spaces. It comprises standard and specialty classrooms, a library, and administrative offices. The three-story building with a walkout basement is primarily used by upperclassmen and the administrative class. It is fully air-conditioned and equipped with a full wet sprinkler system, elevator, and underwent several renovations, the latest being in 2013 when the music room was upgraded.

The Gilkeson Center spans 56,125 square feet and houses the campus's 300-seat performing arts theater, indoor basketball court, library, kitchen and dining hall, and a combination of classrooms, offices, and specialty science, art, dance, and music rooms. The building is also fully air-conditioned and has a wet sprinkler system throughout, except in the gym. Significant renovations were completed in 2011 and 2012, enhancing the atrium, classrooms, and main learning center.

The property features multiple recreational fields designed for baseball and soccer, a basketball court, and a playground. Additionally, solar panels help offset the electricity usage of the Gilkeson Center, while a leased cell tower generates additional income from a corner of the property.

There are three designated parking areas with ample parking spaces - 119 paved spots and 30 gravel spots - totaling 149 spaces.

Permitting zoning allows for various uses, including education, training centers, hospitals, clinics, laboratories, medical facilities, libraries, offices, and schools.

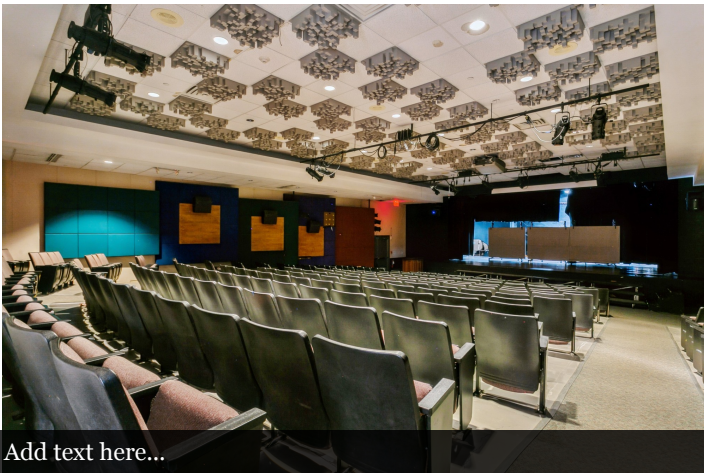

Add text here...

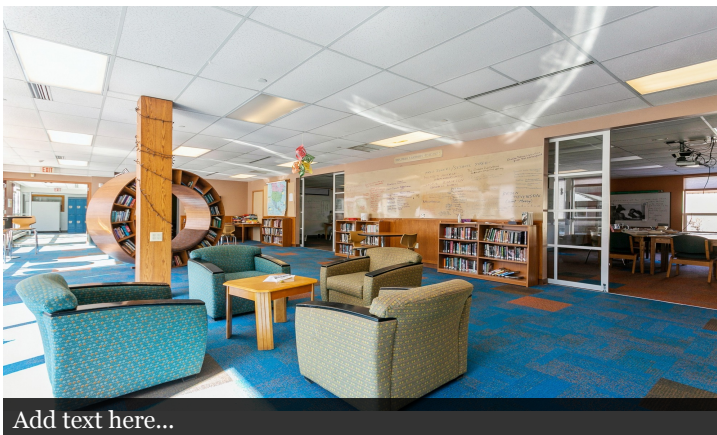

Add text here...



PRIVATE SCHOOL PROPERTY FOR SALE

260 BOARDMAN RD, POUGHKEEPSIE, NY 12603

ADDITIONAL PHOTOS





BERKSHIRE HATHAWAY
HomeServices
Hudson Valley Properties

LOCATION INFORMATION

/ 7



PRIVATE SCHOOL PROPERTY FOR SALE

260 BOARDMAN RD, POUGHKEEPSIE, NY 12603

REGIONAL MAP

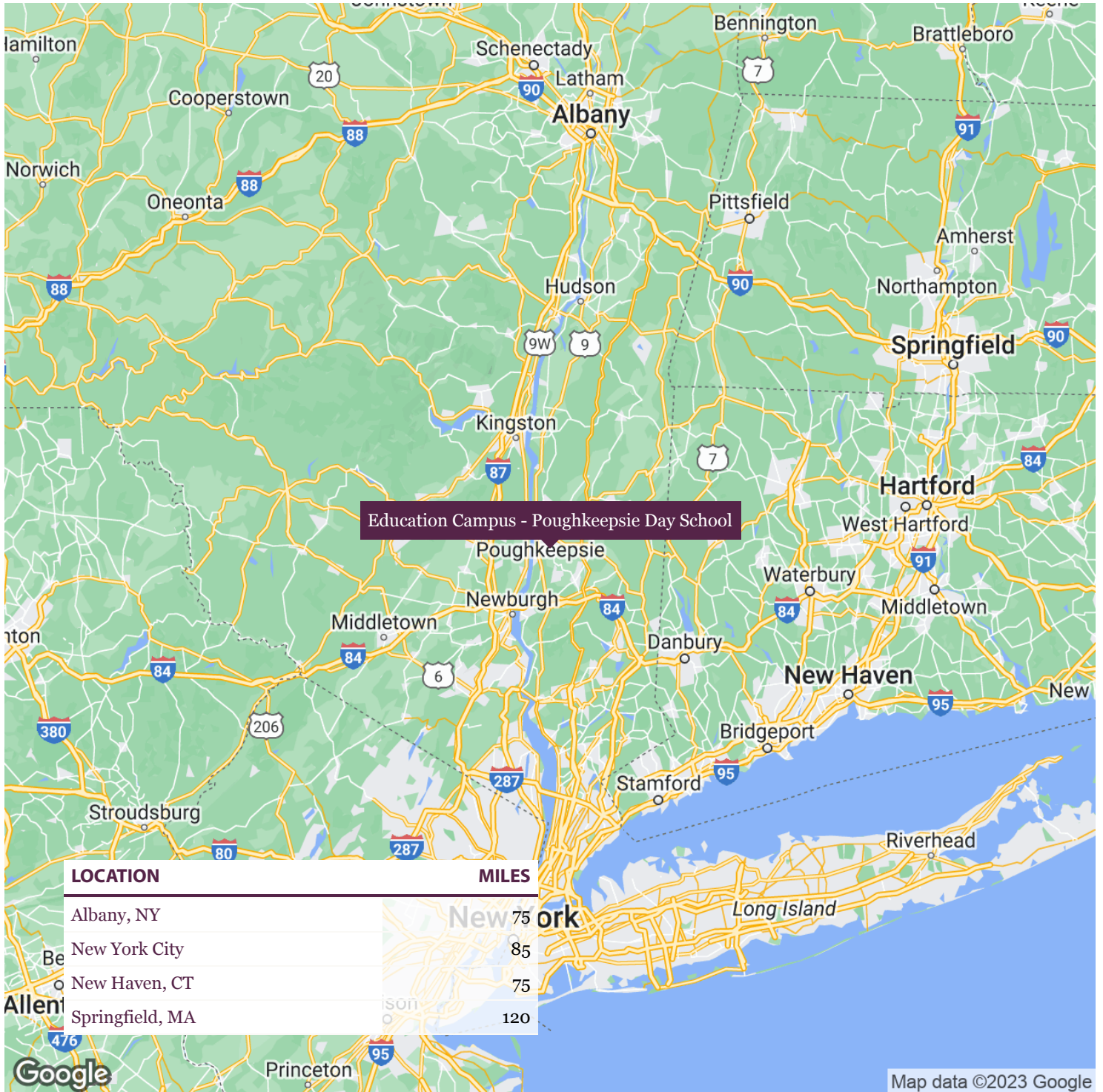



PRIVATE SCHOOL PROPERTY FOR SALE

260 BOARDMAN RD, POUGHKEEPSIE, NY 12603

LOCATION MAP





PRIVATE SCHOOL PROPERTY FOR SALE

260 BOARDMAN RD, POUGHKEEPSIE, NY 12603

SITE PLANS

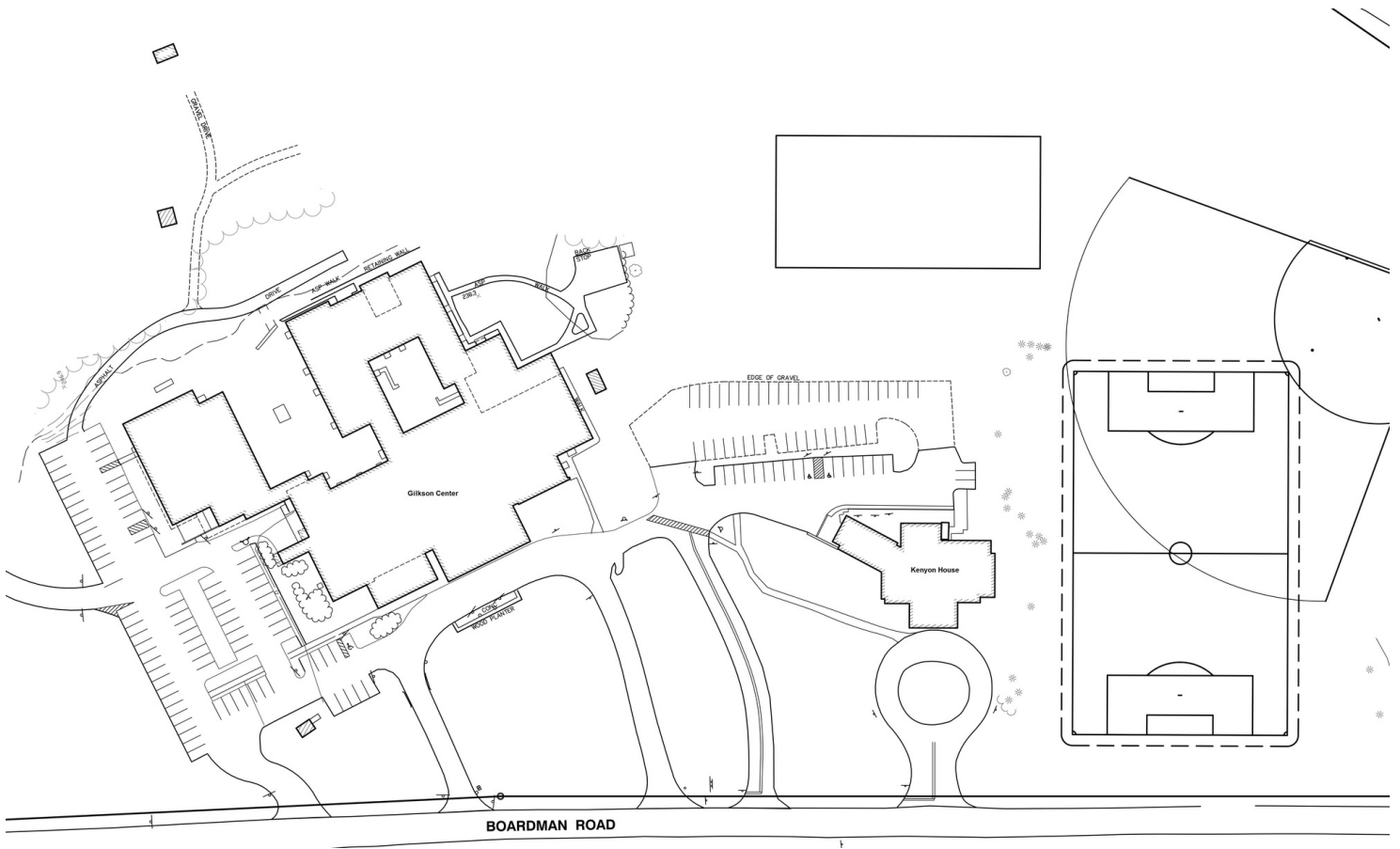



PRIVATE SCHOOL PROPERTY FOR SALE

260 BOARDMAN RD, POUGHKEEPSIE, NY 12603

DEMOGRAPHICS MAP & REPORT

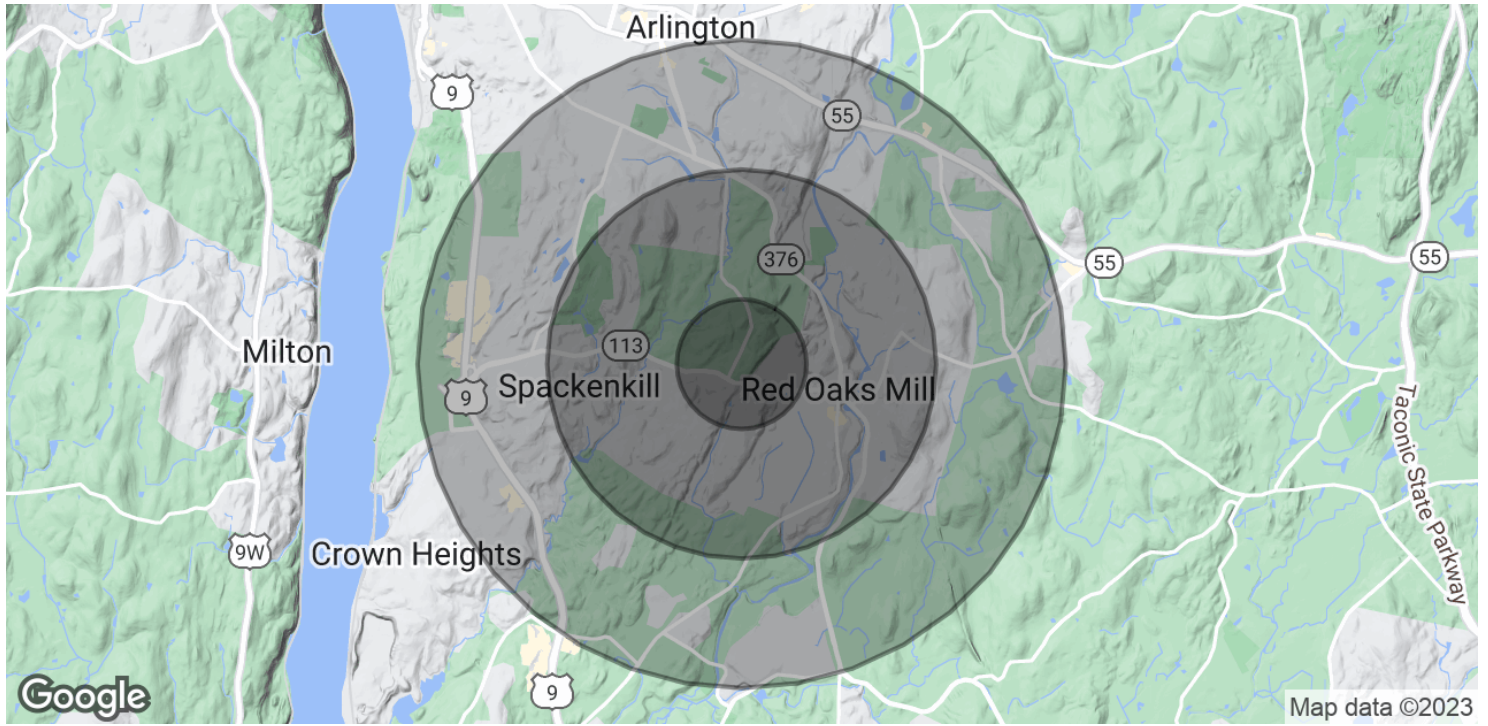

POPULATION	0.5 MILES	1.5 MILES	2.5 MILES
Total Population	1,231	9,874	30,020
Average Age	52.0	49.2	44.0
Average Age (Male)	48.2	47.0	42.8
Average Age (Female)	54.9	50.3	45.3
HOUSEHOLDS & INCOME	0.5 MILES	1.5 MILES	2.5 MILES
Total Households	457	3,801	11,400
# of Persons per HH	2.7	2.6	2.6
Average HH Income	\$157,661	\$138,835	\$118,900
Average House Value	\$556,308	\$414,469	\$305,502

* Demographic data derived from 2020 ACS - US Census