

# NEXUS

COWORKING & PRIVATE OFFICES

## MEETING ROOMS AVAILABLE

**THE MILL**  
4-5 PERSON  
(ROUND TABLE)  
HOURLY = \$45  
HALF DAY = \$125  
FULL DAY = \$275

**THE GEORGIAN**  
25 PERSON  
HOURLY = \$100  
HALF DAY = \$350  
FULL DAY = \$550



**THE CHATTAHOOCHEE**  
14 PERSON  
(BOARDROOM)  
HOURLY = \$75  
HALF DAY = \$275  
FULL DAY = \$450

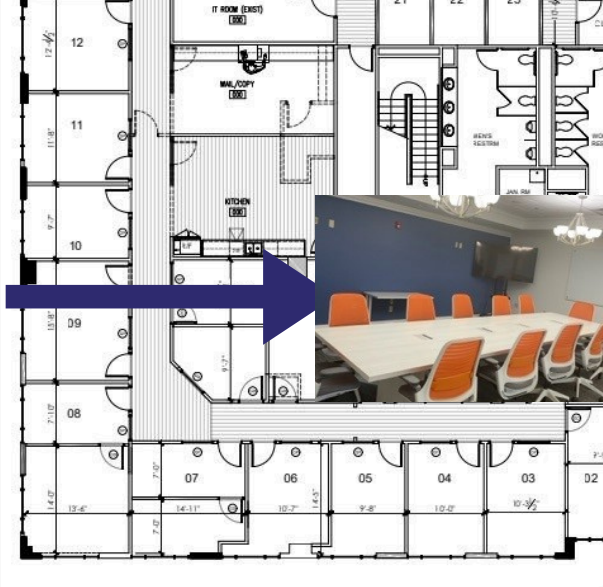

- INVITING RECEPTION/ WAITING AREA
- ALL TYPES OF LEASES AVAILABLE
- DAY OFFICES AVAILABLE
- PORTABLE SCREEN
- WHITEBOARDS

- AMPLE PARKING
- COFFEE/TEA AVAILABLE
- CLOSE TO 400 AND MANY RESTAURANTS

**675 MANSELL ROAD  
SUITE 115  
ROSWELL, GA 30076**

**TO RESERVE, EMAIL LAUREN MCCONNELL  
LMCCONNELL@NEXUS1201.COM  
404-795-5024**

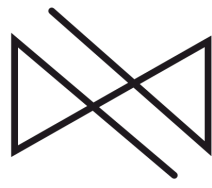

# NEXUS

COWORKING & PRIVATE OFFICES

Everything in GREEN is available  
 Availability as of May 23, 2024  
 Contact: 404-795-5024 or email [Lmccconnell@nexus1201.com](mailto:Lmccconnell@nexus1201.com)



675 Mansell Road  
 Suite 115  
 Roswell, GA 30076

- Inviting reception/waiting area
- All types of leases available
- Day offices available
- Portable Screen
- Whiteboards
- Ample parking
- Coffee/Tea available
- Close to 400 and many restaurants
- Notary on site