

Washington Business Park

5328-5330 E Washington Street, Phoenix, AZ

For Lease



Isy Sonabend

Executive Managing Director

(602) 989-5761 • isy.sonabend@naihonorizon.com

Andrew Agresta

Associate

(540) 808-5402 • andrew.agresta@naihonorizon.com

All information furnished regarding property for sale, rental or financing is from sources deemed reliable, but no warranty or representation is made to the accuracy thereof and same is submitted subject to errors, omissions, change of price, rental or other conditions prior to sale, lease or financing or withdrawal without notice. No liability of any kind is to be imposed on the broker herein.

NAIHorizon

2944 N 44th St, Suite 200,
Phoenix, AZ 85018

+1 (602) 955-4000 • naihonorizon.com

Property Information

Industrial warehouse/flex buildings located in the center of Phoenix



Washington Business Park incorporates a total of $\pm 139,196$ SF. The four-building business park property was completed in 1985.

The Park is oriented to industrial uses and warehousing with the utilities in place for office and flexible spaces.

Building C Highlights

- $\pm 15,303$ SF Available Now
- Fully HVAC Warehouse Spaces
- 14' - 15' Clear Height

Building D Highlights

- 90,000 SF Available (Divisible)
- Power: 2400 Amps of 120/208
- Fully HVAC Warehouse Spaces
- 4 Dock Positions and 1 GL Door
- 20' Clear Height
- Heavy Parking
- Parking ratio: 9.92/1,000 SF

Isy Sonabend

Executive Managing Director

(602) 989-5761 • isy.sonabend@naihonorizon.com

Andrew Agresta

Associate

(540) 808-5402 • andrew.agresta@naihonorizon.com

NAIHorizon

Property Information



Location: 5328-5330 E Washington St (Bldg C & D), Phoenix, AZ 85034

Rental Rate: Contact Agent

Size: Building C – ±15,303 SF
Building D – ±90,000 SF

Zoning: A-1

Primary Use: Warehouse, service, light manufacturing/assembly

Parcel APNs: 124-14-023 & 124-14-024

Property Highlights:

- Central location
- Easy Freeway Access
- Freeway Visibility
- Signage on Washington Street
- Lot Size: 10.99 Acres, Heavy Parking
- Zoning: A-1



Isy Sonabend

Executive Managing Director

(602) 989-5761 • isy.sonabend@naihonorizon.com

Andrew Agresta

Associate

(540) 808-5402 • andrew.agresta@naihonorizon.com

NAIHorizon

Location

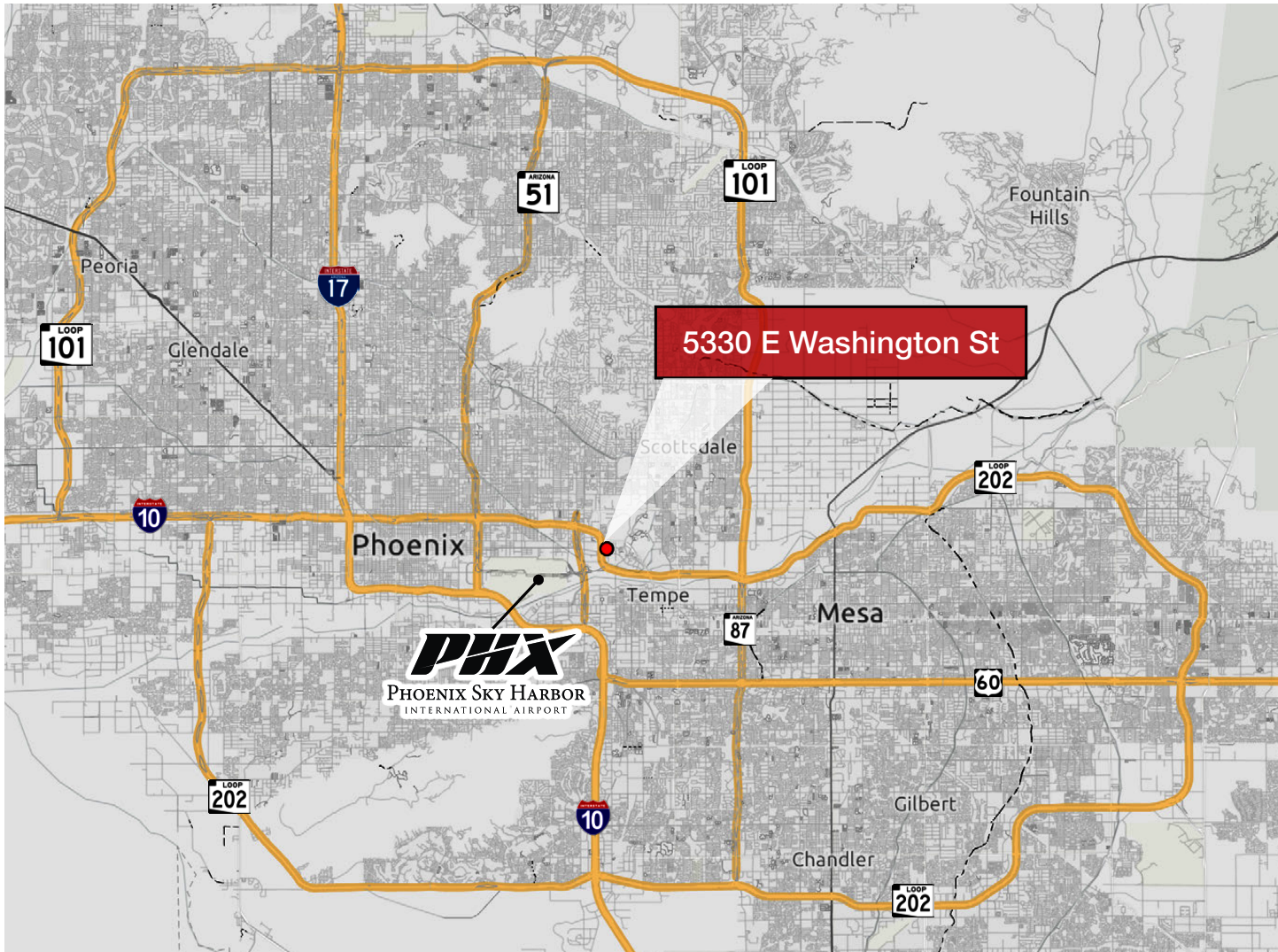

5,235,181
Est. Population



\$111,655
Average HH Income



6.6%
Industrial Vacancy



5,069,353
Total Population



5,016,603
Daytime Employment

Isy Sonabend
Executive Managing Director
(602) 989-5761 • isy.sonabend@naihonorizon.com

Andrew Agresta
Associate
(540) 808-5402 • andrew.agresta@naihonorizon.com



Floor Plan | Building C, ±15,303 SF

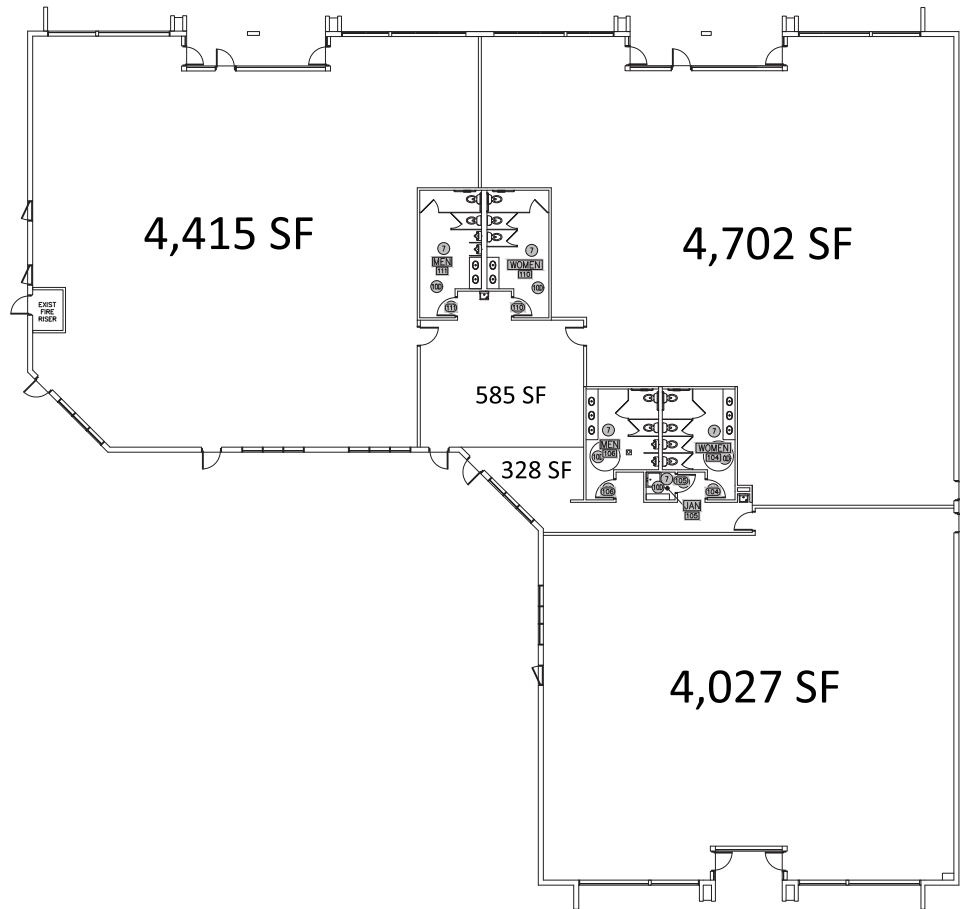

Isy Sonabend

Executive Managing Director

(602) 989-5761 • isy.sonabend@naihorizon.com

Andrew Agresta

Associate

(540) 808-5402 • andrew.agresta@naihorizon.com



Floor Plan | Building D, 90,000 SF

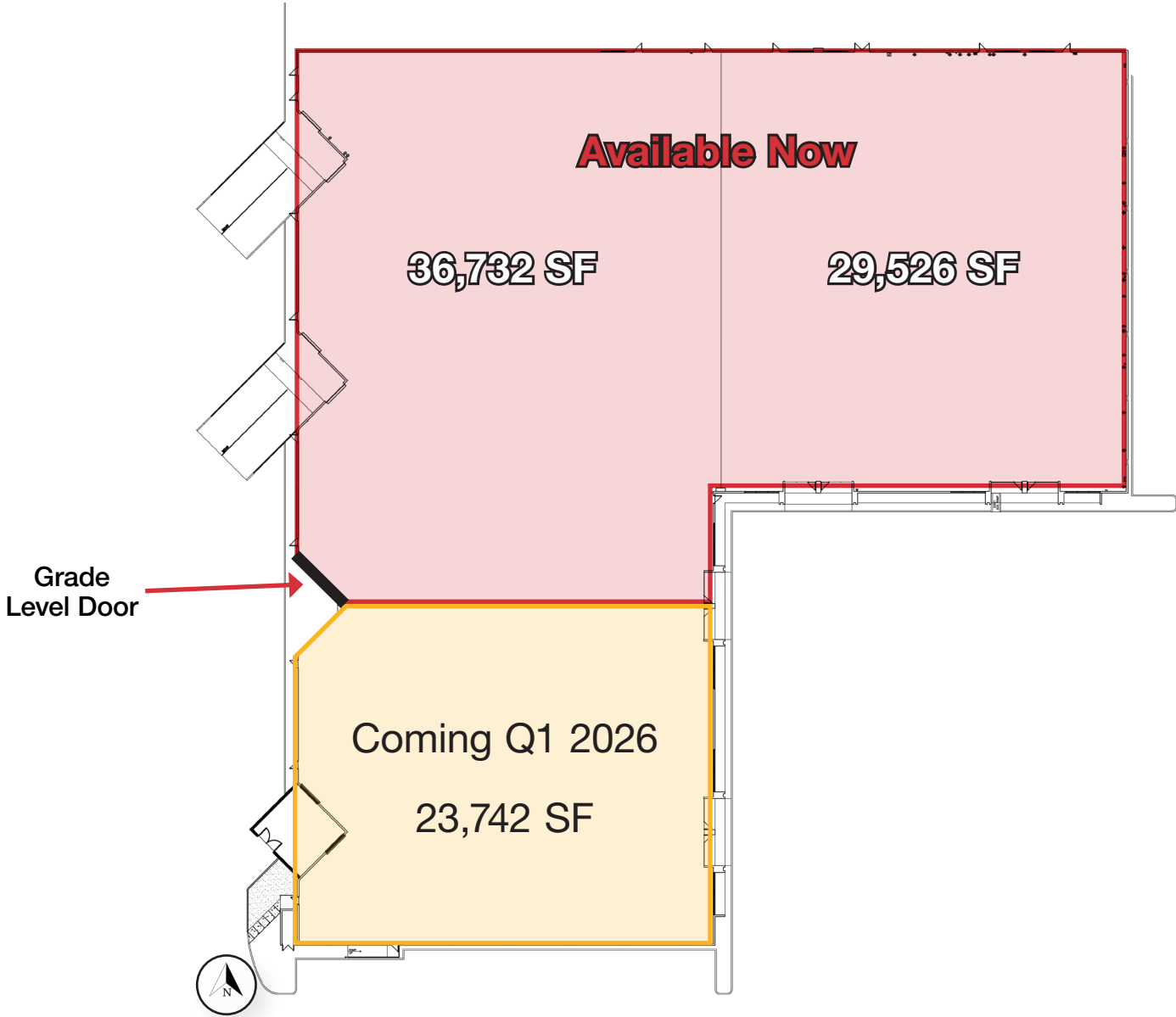

Isy Sonabend
Executive Managing Director
(602) 989-5761 • isy.sonabend@naihonorizon.com

Andrew Agresta
Associate
(540) 808-5402 • andrew.agresta@naihonorizon.com



Property Photos



Isy Sonabend
Executive Managing Director
(602) 989-5761 • isy.sonabend@naihorizon.com

Andrew Agresta
Associate
(540) 808-5402 • andrew.agresta@naihorizon.com



Property Photos



Isy Sonabend

Executive Managing Director

(602) 989-5761 • isy.sonabend@naihorizon.com

Andrew Agresta

Associate

(540) 808-5402 • andrew.agresta@naihorizon.com

NAIHorizon