

TEMECULA CORPORATE PARK

43391-43397 BUSINESS PARK DRIVE, TEMECULA, CA 92590

FOR LEASE
INDUSTRIAL / FLEX SPACE



FOR MORE INFORMATION, PLEASE CONTACT:

CAREY PASTOR | Senior Vice President

(951) 297-7434 | cpastor@cbcsocalgroup.com

CalDRE License # 01403298



**COLDWELL
BANKER
COMMERCIAL
SC**

TEMECULA CORPORATE PARK

43391-43397 BUSINESS PARK DRIVE, TEMECULA, CA 92590

FOR LEASE
INDUSTRIAL / FLEX SPACE



PROJECT HIGHLIGHTS

- High image industrial/flex space for lease
- Located in the Rancho California Business Park
- Close proximity to the I-15 freeway via Rancho California Road
- Ample parking
- Rear loading 10' x 12' roll up doors
- Flexible floor plans

TEMECULA CORPORATE PARK

43391-43397 BUSINESS PARK DRIVE, TEMECULA, CA 92590

FOR LEASE
INDUSTRIAL / FLEX SPACE

AVAILABILITY

SUITE	UNIT SIZE (SF)	MONTHLY BASE RENT	2025 ESTIMATED MONTHLY COMMON AREA OPERATING EXPENSES (CAOE)	DESCRIPTION
43391 C-9	±1,950 SF	\$1,950.00 per month	\$878.00 per month	Reception area, 2 private offices, wet bar, restroom, balance of space warehouse w/ 10'w x 12' h rear loading roll up door and man door
43397 D-7	±1,920 SF	\$1,920.00 per month	\$864.00 per month	Reception area, 2 private offices, wet bar, restroom, balance of space warehouse w/ 10'w x 12' h rear loading roll up door and man door

SITE PLAN

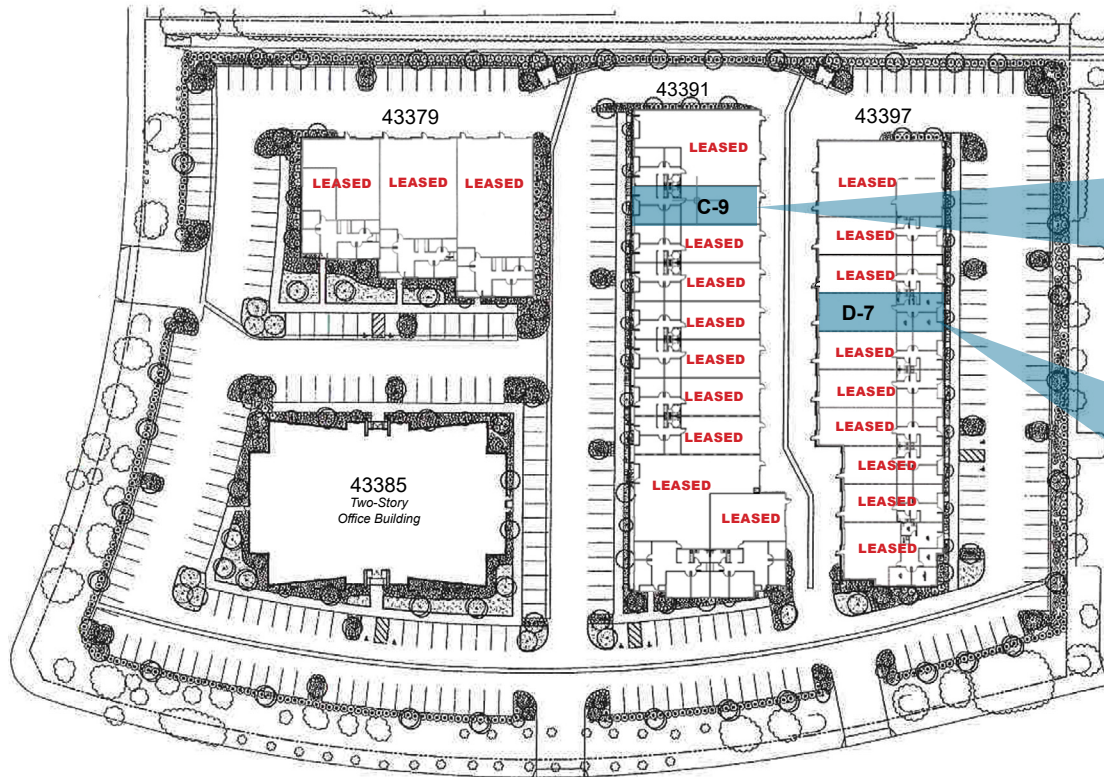

C-9 FLOOR PLAN

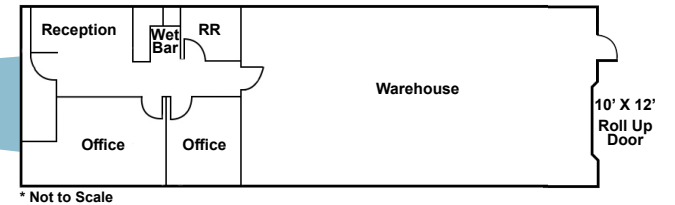

D-7 FLOOR PLAN

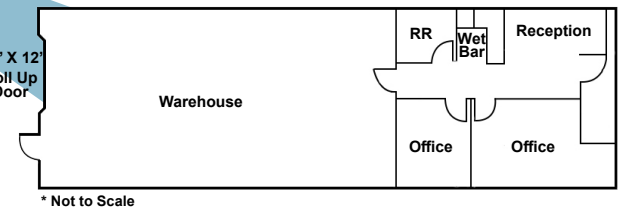

TEMECULA CORPORATE PARK

43391-43397 BUSINESS PARK DRIVE, TEMECULA, CA 92590

FOR LEASE
INDUSTRIAL / FLEX SPACE

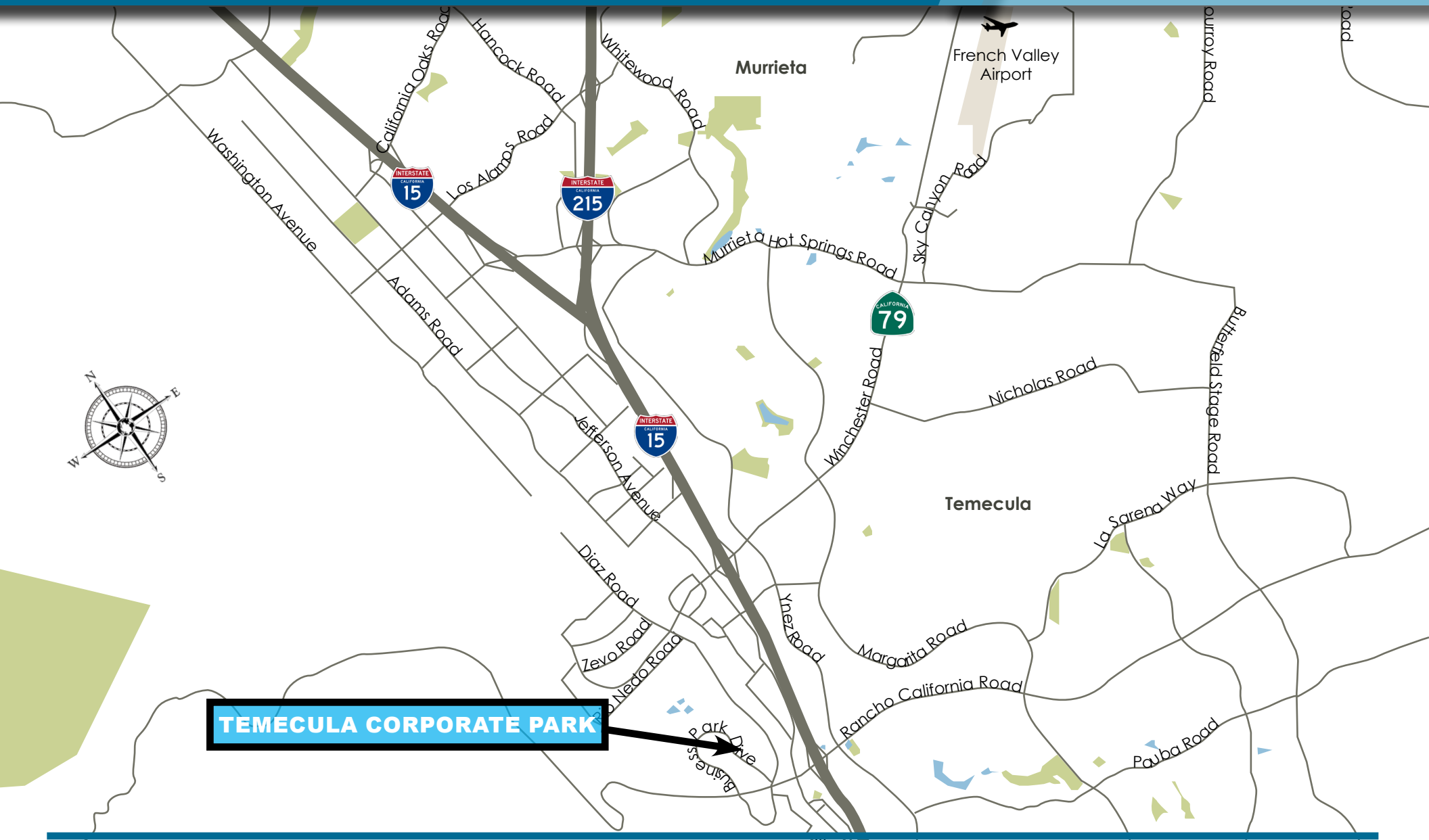

TEMECULA CORPORATE PARK

43391-43397 BUSINESS PARK DRIVE, TEMECULA, CA 92590

FOR LEASE
INDUSTRIAL / FLEX SPACE



FOR MORE INFORMATION, PLEASE CONTACT:

CAREY PASTOR

Senior Vice President

951.297.7434

cpastor@cbcsocalgroup.com

CalDRE # 01403298

27368 Via Industria | Suite 102
Temecula | California | 92590
t 951.200.7683 | f 951.239.3147
cbcsocalgroup.com



**COLDWELL
BANKER
COMMERCIAL**
SC