



Riverfront Industrial Building 1

3678 S. 700 W.
SOUTH SALT LAKE, UT 84119

For Lease
25,000 SF

Property Highlights

- 25,000 SF available
 - 1,534 SF office
 - 23,466 SF warehouse
- Clear height 26'
- Column spacing: 46' x 60'
- One (1) ground level door (12'x14')
- Eight (8) dock high doors
 - All equipped with bumpers
 - Two equipped with bumpers, levelers and seals
- Power: 400 amps / 480/277 V / 3-phase
- Heating: gas forced air
- Loading: rear load configuration
- Zoning: Industrial- Light Manufacturing
- Fire suppression: ESFR fire suppression system
- Truck court: 122'x377'
- LED lighting
- Skylights: throughout the warehouse
- Construction type: concrete tilt-up
- Depth: 180'
- Unisex restroom
- Located just one mile off the 3300 South exit of I-15

For information, please contact:

Eli Priest

Senior Managing Director
t 801-746-4746
eli.priest@nrmk.com

Kelsie Akiyama

Senior Associate
t 801-578-5504
kelsie.akiyama@nrmk.com

Lucas M. Burbank

Executive Managing Director
t 801-578-5522
lucas.burbank@nrmk.com

376 E. 400 S.
Suite 120
Salt Lake City, UT 84111

NEWMARK

The information contained herein has been obtained from sources deemed reliable but has not been verified and no guarantee, warranty or representation, either express or implied, is made with respect to such information. Terms of sale or lease and availability are subject to change or withdrawal without notice.

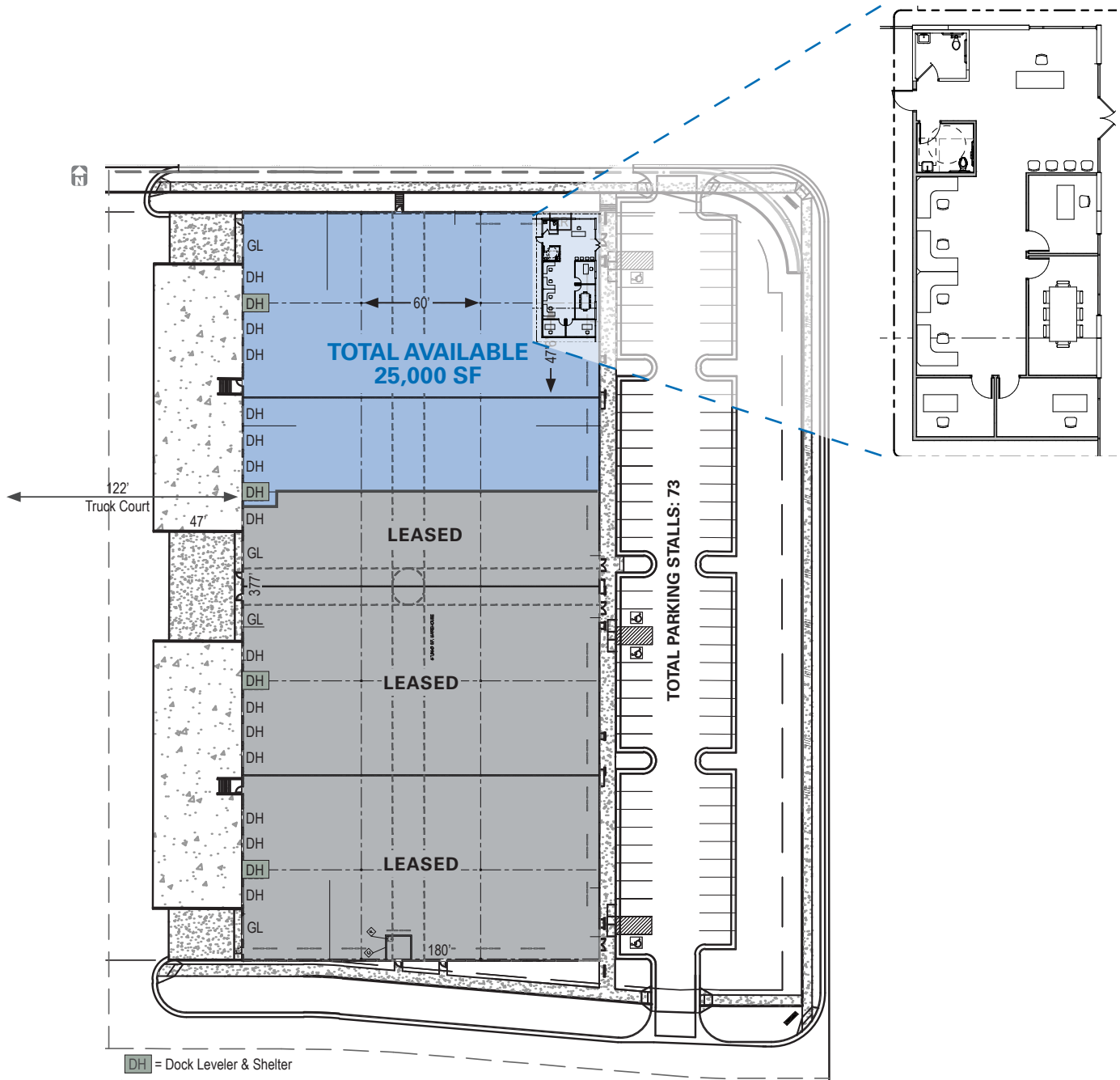

For information, please contact:

Eli Priest
Senior Managing Director
t 801-746-4746
eli.priest@nrmk.com

Kelsie Akiyama
Senior Associate
t 801-578-5504
kelsie.akiyama@nrmk.com

Lucas M. Burbank
Executive Managing Director
t 801-578-5522
lucas.burbank@nrmk.com

376 E. 400 S.
Suite 120
Salt Lake City, UT 84111



For information, please contact:

Eli Priest
 Senior Managing Director
 t 801-746-4746
 eli.priest@nrmk.com

Kelsie Akiyama
 Senior Associate
 t 801-578-5504
 kelsie.akiyama@nrmk.com

Lucas M. Burbank
 Executive Managing Director
 t 801-578-5522
 lucas.burbank@nrmk.com

376 E. 400 S.
 Suite 120
 Salt Lake City, UT 84111