



**COBURG PLACE - 1777 COBURG RD - EUGENE, OR 97401**

## For Lease - New Retail at Coburg Place

- NEW RETAIL BUILDING ON COBURG RD.
- LAST AVAILABLE SPACE: 1,393 SQUARE FEET
- ZONING: C-1
- LOCATED NEAR HIGH TRAFFIC INTERSECTION

*Lease Rate: \$32.00/SF, NNN*

*For more information contact:*

**TIM CAMPBELL**

timc@campbellre.com | (541) 484-2214

Licensed in the State of Oregon

**Campbell**  
COMMERCIAL  
REAL ESTATE

701 High Street, Suite 300  
Eugene, Oregon 97401  
www.campbellre.com

# COBURG PLACE SPACE PLAN

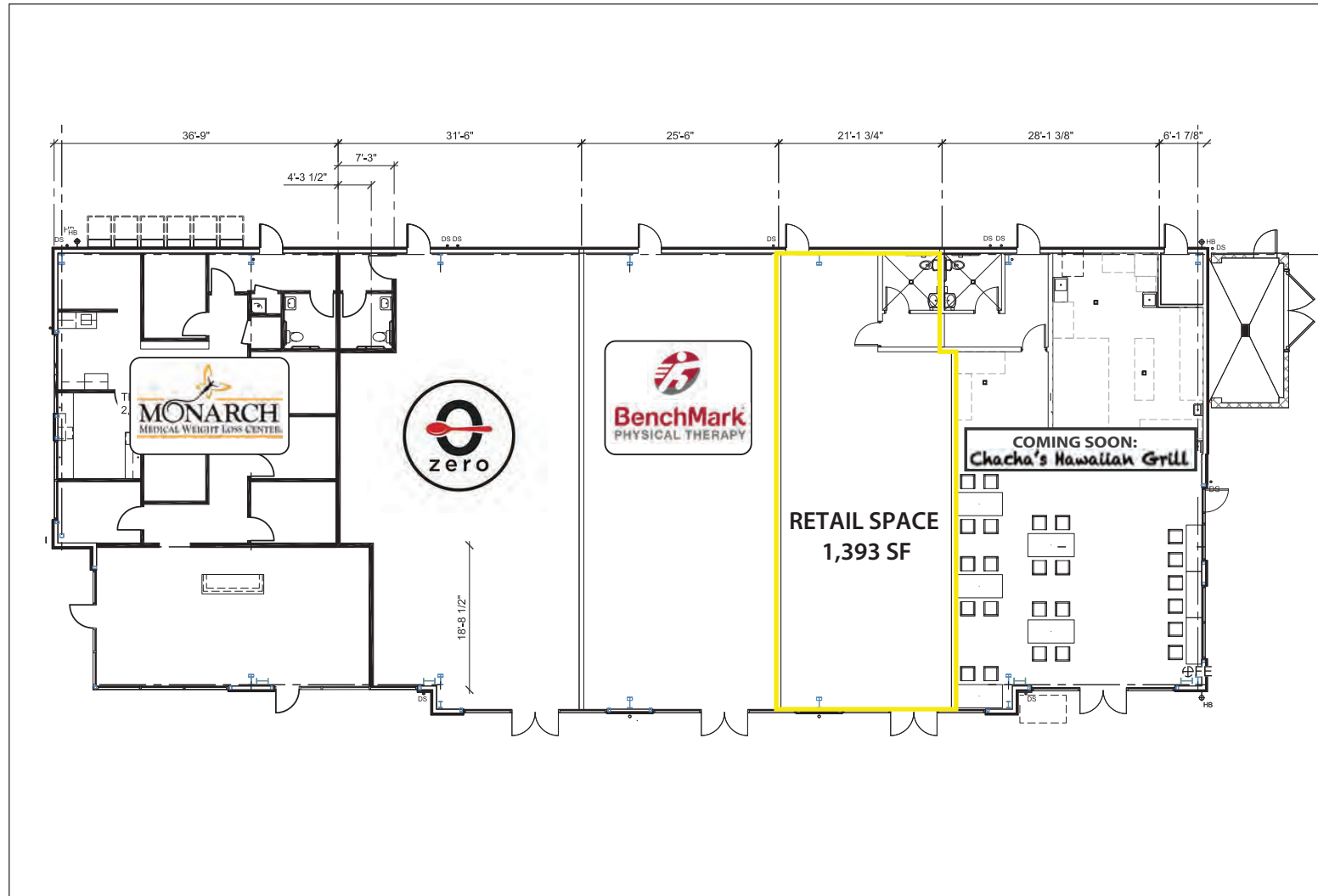

The information in this package was obtained from sources deemed reliable, and is not guaranteed by agent. Package is subject to change, error or omission, prior sale or lease, correction or withdrawal. Any party contemplating purchase is urged to conduct their own independent study and inspection.

# AREA RETAIL TENANT MAP

## *Coburg Rd. Corridor Tenants (with-in 1.5 mile distance of property site)*



- BI-MART
- MARKET OF CHOICE
- SAFeway
- WALGREENS
- COSTCO
- SHOPCO
- TRADER JOES
- STARBUCKS
- POTTERYBARN
- PF CHANGS
- NIKE
- TJ MAXX HOME GOODS
- PIER 1 IMPORTS
- OLD NAVY
- SLEEP TRAIN
- OAKWAY FITNESS
- CHIPOLTE
- NATURAL GROCERS
- PETSMART
- OFFICE DEPOT
- BED BATH & BEYOND
- NORDSTROM RACK
- ALBERTSONS
- DSW

# COBURG PLACE - 1777 COBURG RD

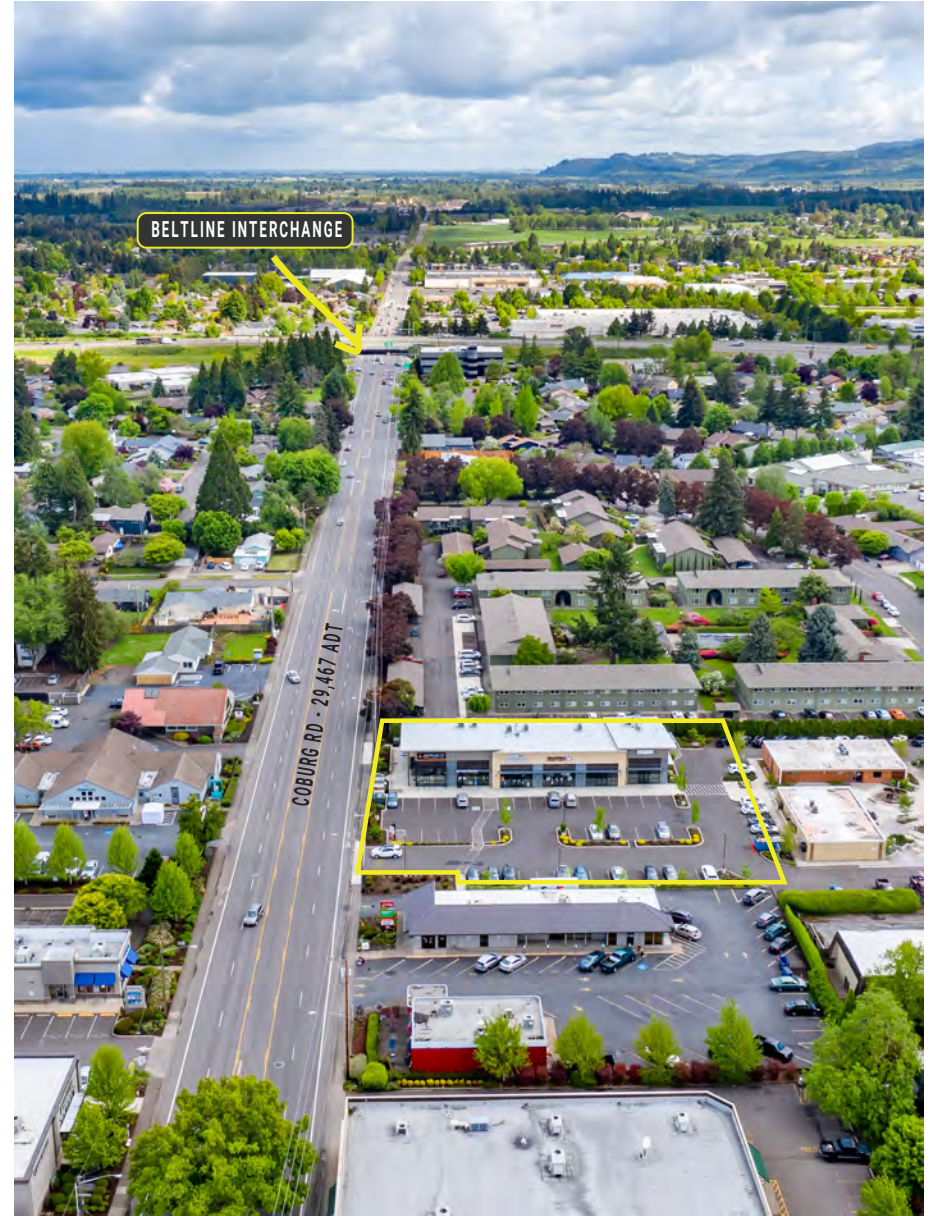

The information in this package was obtained from sources deemed reliable, and is not guaranteed by agent. Package is subject to change, error or omission, prior sale or lease, correction or withdrawal. Any party contemplating purchase is urged to conduct their own independent study and inspection.