

401 THORNTON ROAD

LITHIA SPRINGS, GA 30122

88,731 sq. ft.
AVAILABLE

6
DOCK DOORS

5,000 sq. ft.
OFFICE AREA

1
DRIVE-IN DOOR

24'
CLEAR HEIGHT

Brick/Block
CONSTRUCTION

Features

88,731 sq. ft. stand alone industrial building with \pm 5,000 sq. ft. office on a 5.27 acre lot.

6 dock high doors and 1 drive-in door with ramp.

1 acre of paved/lit/fenced parking and storage lot adjacent to building.

Recent renovations include LED lighting, interior/exterior paint, and office renovations.

Frontage on Thornton Road less than 2 miles from I-20.



Building Specifications

Building Size	88,731 sq. ft.
Available	88,731 sq. ft.
Office Space	±5,000 sq. ft.
Lot Size	5.27 acres
Outside Storage	1 acre
Clear Height	24'
Column Spacing	40' x 30'
Dock Doors	6 (9' x 10')
Drive-ins	1
Levelers	6
Format	Side load
Automobile Parking	50 spaces
Sprinklers	Wet sprinklers
Lighting	LED
Power	800 AMP, 480 volt, 3-phase
Year Built/Renovated	1980/2024

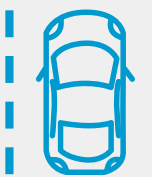
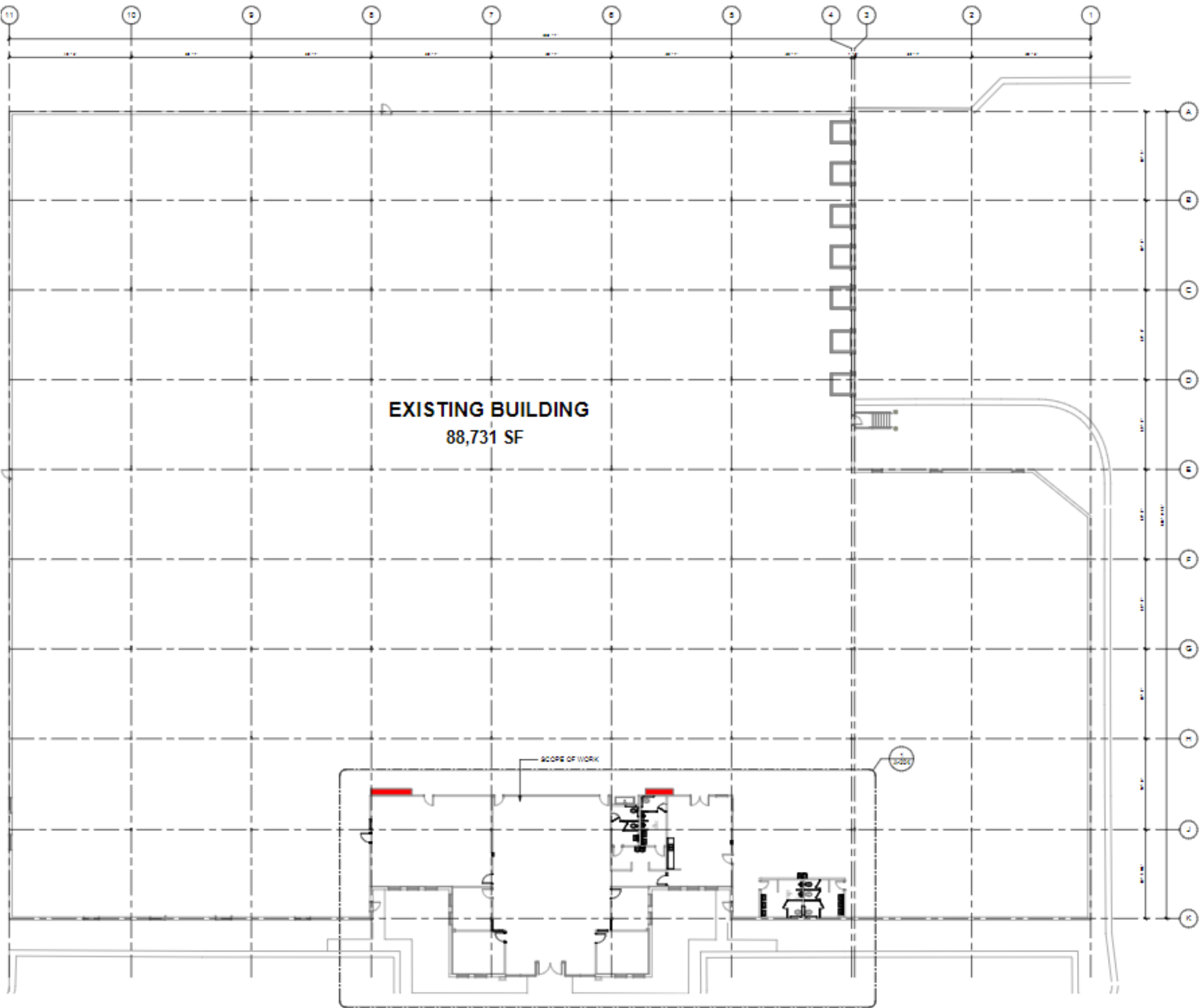

50
Automobile
Parking

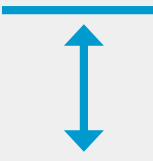

24'
Clear
Height

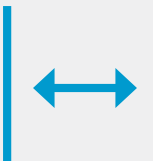

40'x30'
Column
Spacing



6
Dock Doors



1
Drive-in
Door

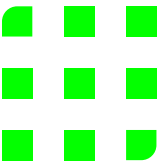

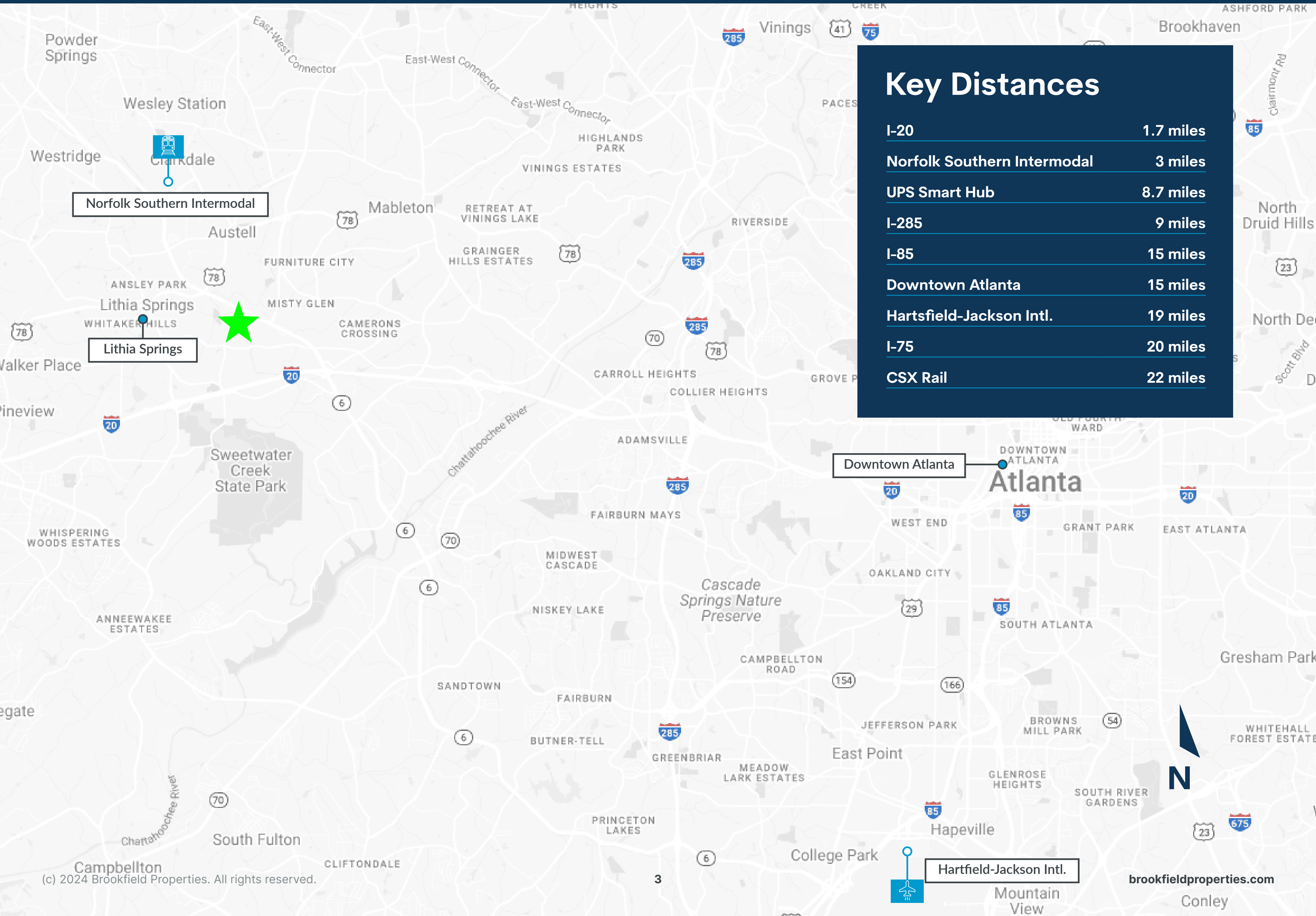

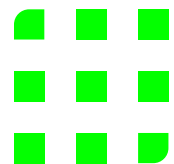

Westfork Business Center

401 THORNTON ROAD, LITHIA SPRINGS, GA 30122



Leasing Contacts

John Gosnell

404.563.0608

jgosnell@strategicrepartners.com

www.strategicrepartners.com

Peyton Murray

706.474.3940

peyton.murray@brookfieldproperties.com

www.brookfieldproperties.com



All information regarding property for sale, rental or financing is from sources deemed reliable, but no warranty or representation is made to the accuracy thereof and same is submitted to errors, omissions, change of price, rental or other conditions prior to sale, lease or financing or withdrawal without notice. No liability of any kind is to be imposed on the broker herein.

**Brookfield
Properties**

