

**For Sale**  
**±1,369 SF**  
**Fully Built-Out**  
**Medical/Office Condo**

**PRICE  
REDUCED!**

## Compson Place at Renaissance Commons

1880 N Congress Ave, Unit 320, Boynton Beach, FL 33426

### Property Features

- Unparalleled owner/user opportunity in Renaissance Commons - a stunning, Class-A mixed-use development along Boynton Beach's most popular retail corridor
- Modern, Mediterranean architecture with lush landscaping and a tranquil courtyard
- Surrounded by dense retail and residential with good demographics
- Fully built-out, third-floor medical office condo in Compson Place – home to Starbucks, First Watch, Pyure Salon, Venetian Nail Spa, and more
- Ideal for a variety of medical users with an efficient & thoughtful layout

### Key Highlights



Fully built-out medical office condo with x-ray room & private restrooms



Just 1.5 miles from I-95, easily accessible via E Gateway Blvd. and Congress Ave.



Centrally located in a thriving area with numerous conveniences & a short drive to area hospitals



Ample parking, including three reserved garage spaces

**Lesley Sheinberg**, Managing Director

C: 561 254 7810 | [lsheinberg@mhcreal.com](mailto:lsheinberg@mhcreal.com)

**Julia Piatek**, Associate

C: 954 939 1444 | [jpiatek@mhcreal.com](mailto:jpiatek@mhcreal.com)







# Medical Office Condo in a Premier Development

Located in a dynamic and thriving Boynton Beach locale

## Strategic Location for Medical Users

This medical office condo is located in the vibrant Renaissance Commons community and offers the perfect blend of professional excellence and work-life balance. With easy access to I-95 and close proximity to premier retail, dining, and lifestyle amenities, this property ensures convenience and efficiency for both practitioners and patients. Enjoy the tranquil Mediterranean-inspired courtyard and a bustling mixed-use environment, making this a strategic location for medical professionals looking to thrive in Boynton Beach's dynamic and growing community.



<b>Address:</b>	1880 N Congress Avenue, Unit 320 Boynton Beach, FL 33426
<b>Year Built:</b>	2008
<b>Unit Size:</b>	±1,369 SF
<b>PID:</b>	08-43-45-17-20-001-3200
<b>Use Code:</b>	1204 – Store/Off/Res Condo
<b>Zoning:</b>	SMU – Suburban Mixed Use
<b>Parking:</b>	Includes 3 reserved garage spaces 150 Surface Spaces 100 Garage Spaces
<b>Sale Price:</b>	<b>RECENTLY REDUCED</b> \$620,000
<b>RE Taxes:</b>	\$7,734
<b>Association Fees:</b>	\$891.32/month (includes water)

### For More Information:

Lesley Sheinberg | [lsheinberg@mhcreal.com](mailto:lsheinberg@mhcreal.com)

Julia Piatek | [jpiatek@mhcreal.com](mailto:jpiatek@mhcreal.com)



561 471 8000



[www.mhcreal.com](http://www.mhcreal.com)



1880 N CONGRESS AVENUE, BOYNTON BEACH, FL  
**Medical Office Condo in Renaissance Commons**



**UNIQUE OPPORTUNITY TO PURCHASE A FULLY BUILT-OUT UNIT  
IN THE HEART OF BOYNTON BEACH'S BEST AMENITIES**



**For More Information:**

Lesley Sheinberg | [lsheinberg@mhcreal.com](mailto:lsheinberg@mhcreal.com)

Julia Piatek | [jpiatek@mhcreal.com](mailto:jpiatek@mhcreal.com)



561 471 8000



[www.mhcreal.com](http://www.mhcreal.com)

1880 N CONGRESS AVENUE, BOYNTON BEACH, FL  
Efficient & Convenient Layout for Medical Professionals

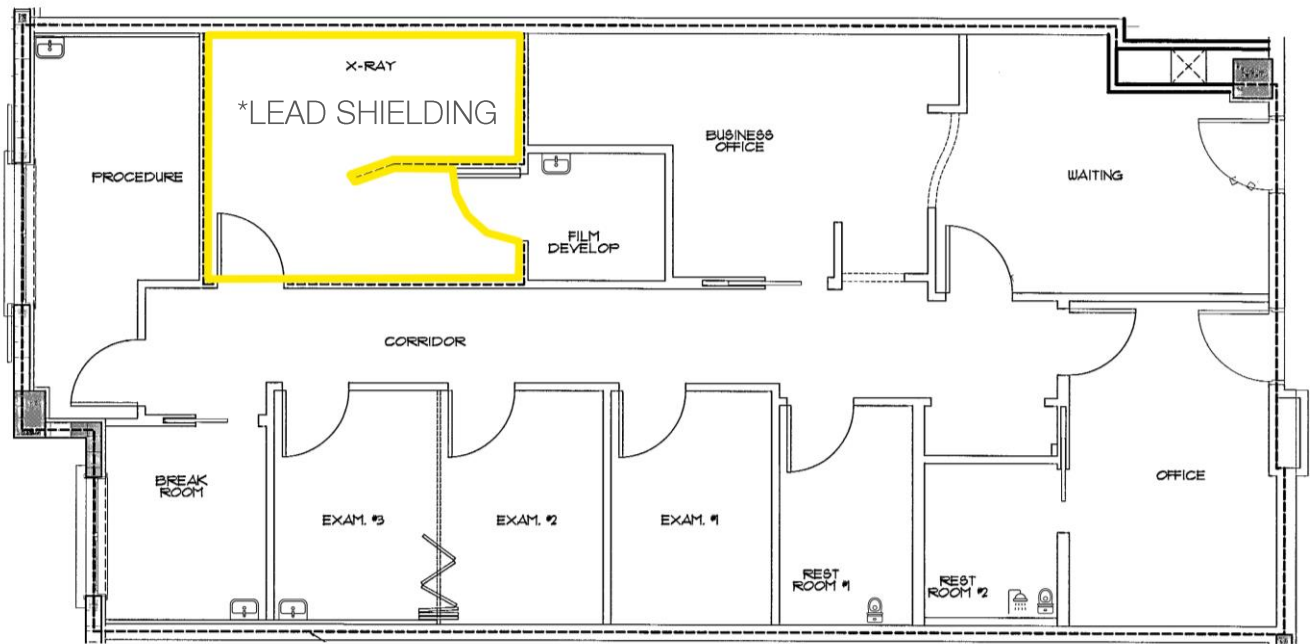

Plans not to scale and subject to error.

**Unit 320** ±1,369 SF

- Welcoming waiting room and check-in area
- Four exam rooms (two equipped with sinks)
- Doctor's office with a separate entry and private bathroom featuring a shower
- X-ray room with lead shielding\* and sink
- Breakroom with a sink
- Two in-suite restrooms, with 1 ADA-compliant
- New HVAC system
- Fully sprinklered setup
- Three reserved garage parking spaces, accessible from the third floor



**For More Information:**

Lesley Sheinberg | [Isheinberg@mhcreal.com](mailto:Isheinberg@mhcreal.com)

 561 471 8000

 [www.mhcreal.com](http://www.mhcreal.com)



1880 N CONGRESS AVENUE, BOYNTON BEACH, FL

# Unbeatable Location Near Everything



MINUTES FROM  
NUMEROUS OTHER  
CONVENIENCES...



**This highly traveled intersection has over 61,000 combined passing cars per day!**

**Propel your success by investing in a thriving location with excellent demographics.**

## Demographics:

	1 Mile	3 Miles	5 Miles
Total Population	19,470	131,569	274,459
Avg. HH Income	\$83,348	\$90,913	\$100,310
Households	8,822	54,622	111,698

## Elevate Your Practice in Boynton Beach - Contact Us to Learn More!

Lesley Sheinberg, Managing Director  
C: 561 254 7810 | lsheinberg@mhcreal.com

Julia Piatek, Associate  
C: 954 939 1444 | jpiatek@mhcreal.com