

SUITE 202

455 SF

AVAILABLE

DECEMBER 1ST 2025



OFFICE SUITES FOR LEASE

8826 SANTA FE DRIVE OVERLAND PARK, KS



\$18.50/SF as-is



BOARDROOM

\$19.00/SF with building standard upgrades

Property Highlights

- Move in ready suites available
- Updated common areas
- On-site ownership
- Limited space remaining
- Access to shared boardroom
- Great Downtown Overland Park location



JACK SCHREIBER

☎ 913.320.3001

✉ JSchreiber@prismres.com

Member of



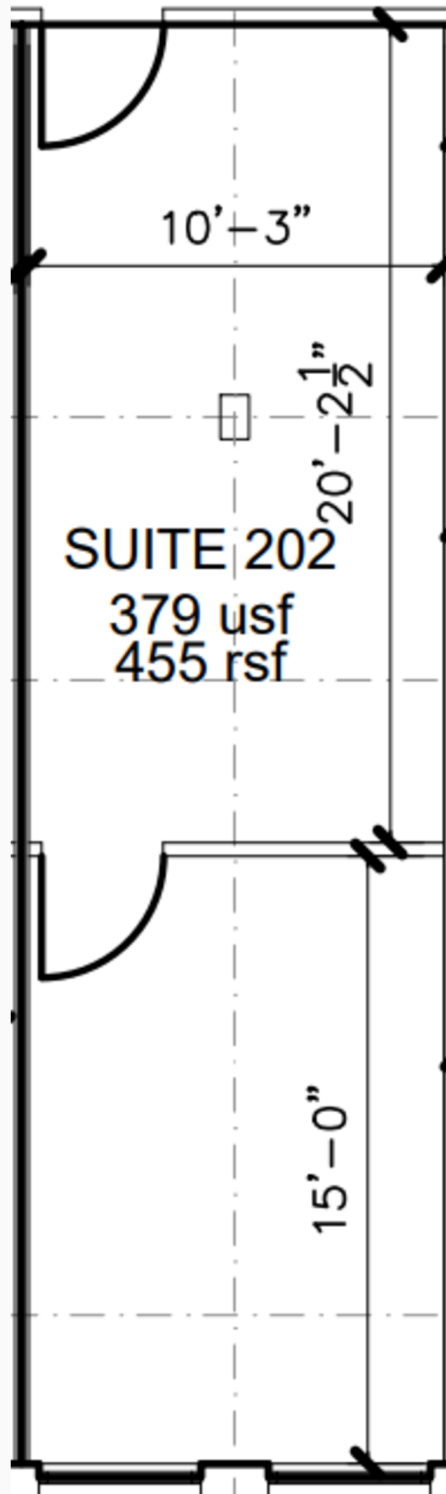

JACK SCHREIBER

913.320.3001

JSchreiber@prismres.com

FLOOR PLAN STE 202
2nd Floor
455 SF

8826 SANTA FE DRIVE OVERLAND PARK, KS

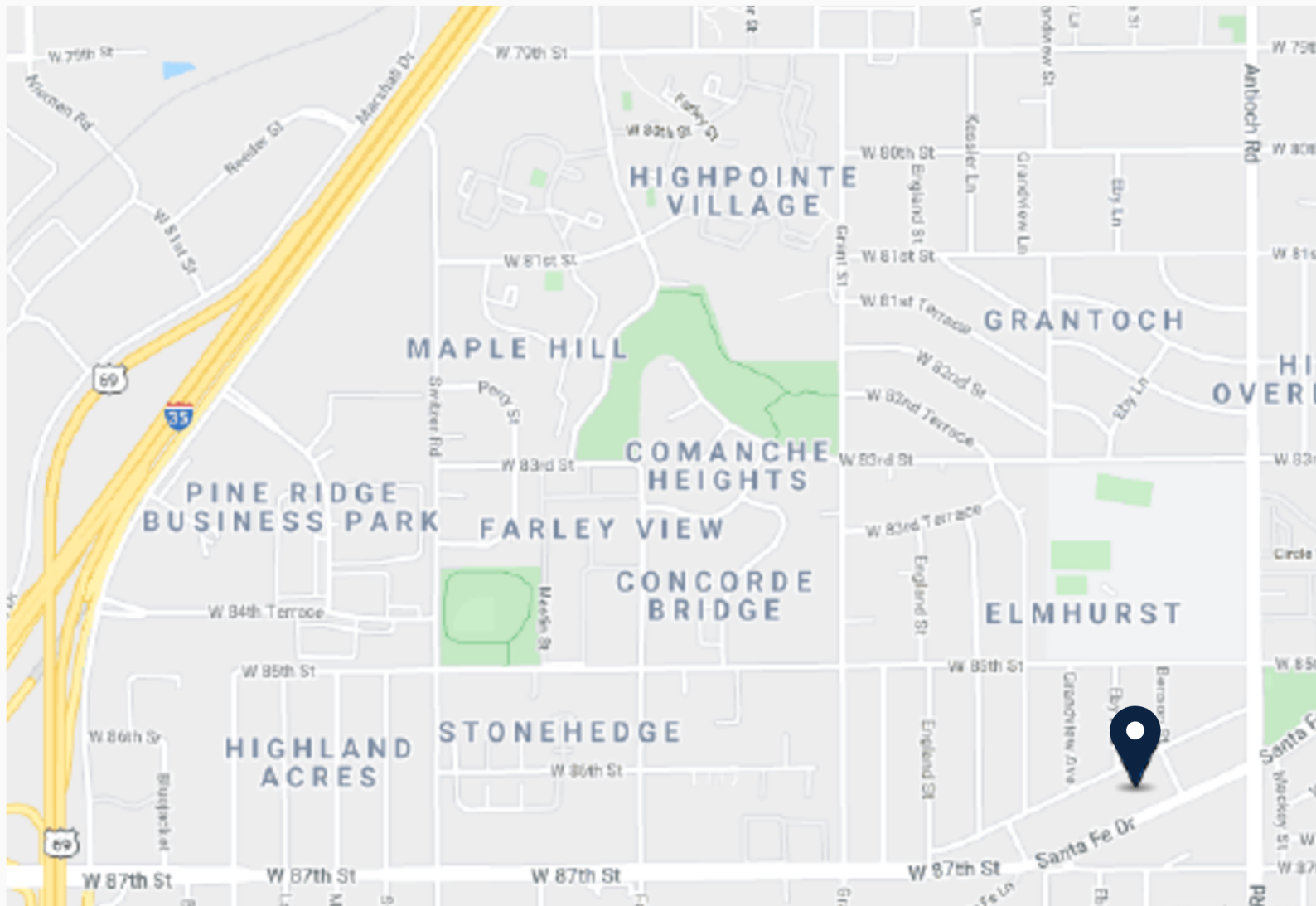

JACK SCHREIBER

📞 913.320.3001

✉️ JSchreiber@prismres.com

LOCATION