



# FOR LEASE - ±27,480 SQUARE FEET

808 W. NICOLAS (NICHOLAS) AVENUE | ORANGE, CA



## PROPERTY FEATURES:

- » ±2,800 SF of Office
- » ±24,680 SF of Warehouse
- » 18' Warehouse Clear Height
- » Fire Sprinklers
- » 1,600 Amps 120/208 Volts (verify)
- » Double Truck Well
- » Two (2) Ground Level Loading Doors
- » 51 Parking Spaces
- » Large Secured Parking/Yard Area
- » LED Warehouse Lighting
- » Skylights
- » Earthquake Retrofitted
- » Good Access to 57, 22 and 5 Freeways

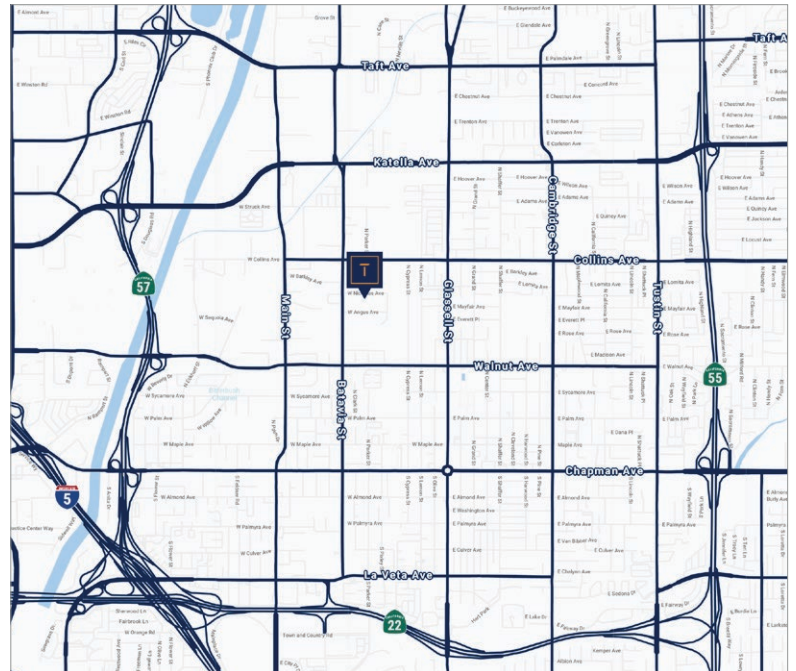

## CONTACT US:

**TAYLOR SNYDER, MBA**  
Senior Vice President

(949) 533-1321  
taylor@tidemarkrealestate.com  
DRE Lic. 02092420

**PAT LACEY**  
Executive Director

(714) 875-4134  
pat@tidemarkrealestate.com  
DRE Lic. 00988663

**WILL GREUBEL**  
Senior Vice President

(714) 614-7623  
will@tidemarkrealestate.com  
DRE Lic. 02039807

**JIM SNYDER, CCIM, CPM®**  
Chief Executive Officer

(949) 533-1190  
jim@tidemarkrealestate.com  
DRE Lic. 00872220

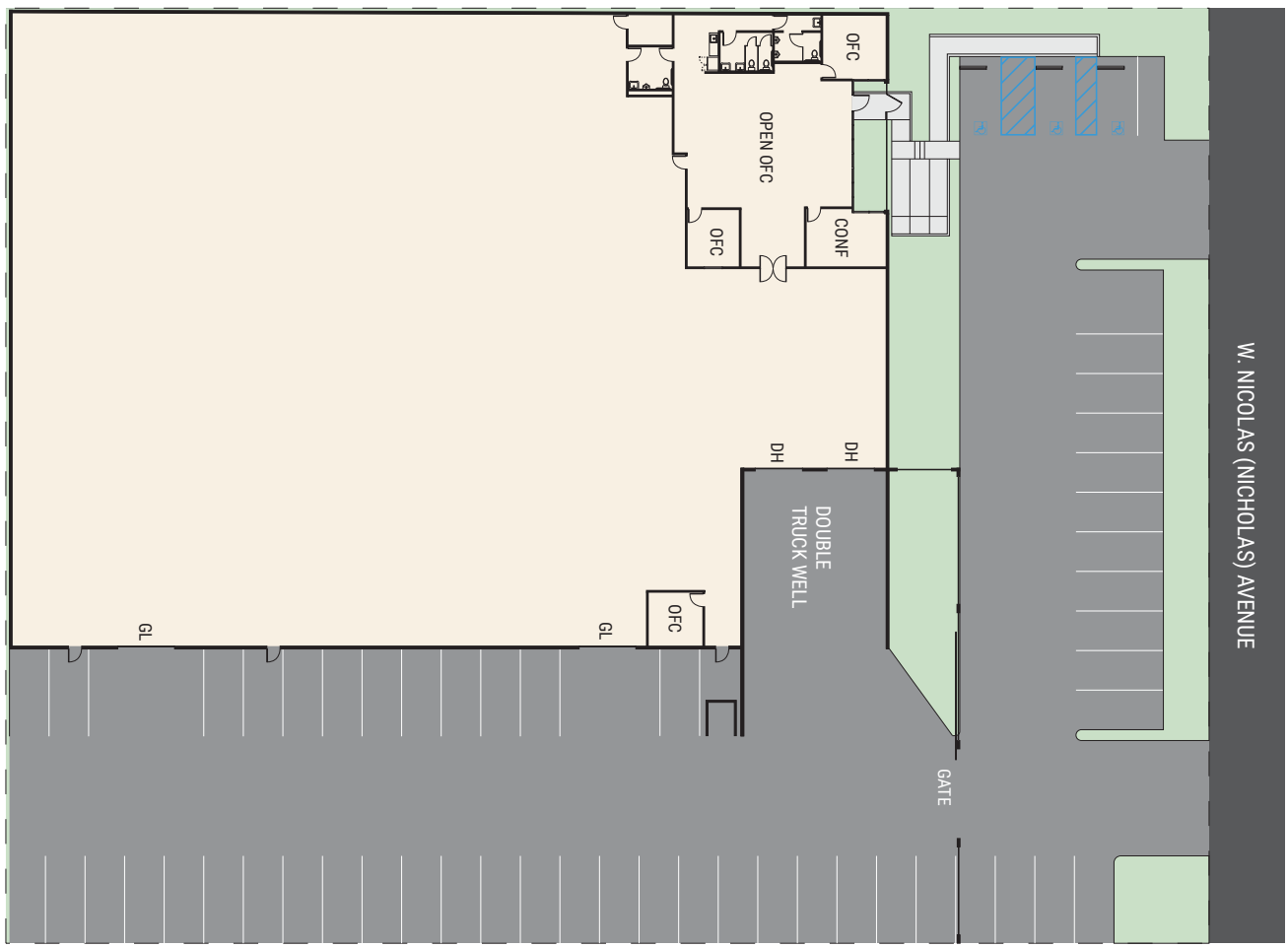

**CONTACT US:**

**TAYLOR SNYDER, MBA**  
 Senior Vice President  
 (949) 533-1321  
 taylor@tidemarkrealestate.com  
 DRE Lic. 02092420

**PAT LACEY**  
 Executive Director  
 (714) 875-4134  
 pat@tidemarkrealestate.com  
 DRE Lic. 00988663

**WILL GREUBEL**  
 Senior Vice President  
 (714) 614-7623  
 will@tidemarkrealestate.com  
 DRE Lic. 02039807

**JIM SNYDER, CCIM, CPM®**  
 Chief Executive Officer  
 (949) 533-1190  
 jim@tidemarkrealestate.com  
 DRE Lic. 00872220



DISCLAIMER: The information contained herein has been obtained from the property owner or other third party and is provided to you without verification as to accuracy. We (Tidemark Real Estate Services, Inc., its brokers, employees, agents, principals, officers, directors and affiliates) make no warranty or representation regarding the information, property, or transaction. You and your attorneys, advisors and consultants should conduct your own investigation of the property and transaction.

