

3330-3334 ROCHESTER ROAD  
TROY, MICHIGAN



**SIGNATURE  
ASSOCIATES**  
KNOW SIGNATURE | KNOW RESULTS

RETAIL FOR LEASE  
1,066 Square Feet Available



## PROPERTY FEATURES

- 1,066 square feet available
- Excellent opportunity in former MedSpa space
- 14' clear height
- 32 shared parking spaces
- Prime location with significant traffic volumes and strong demographics
- Zoned B-2
- Lease Rate: \$17.00/sq. ft. NNN

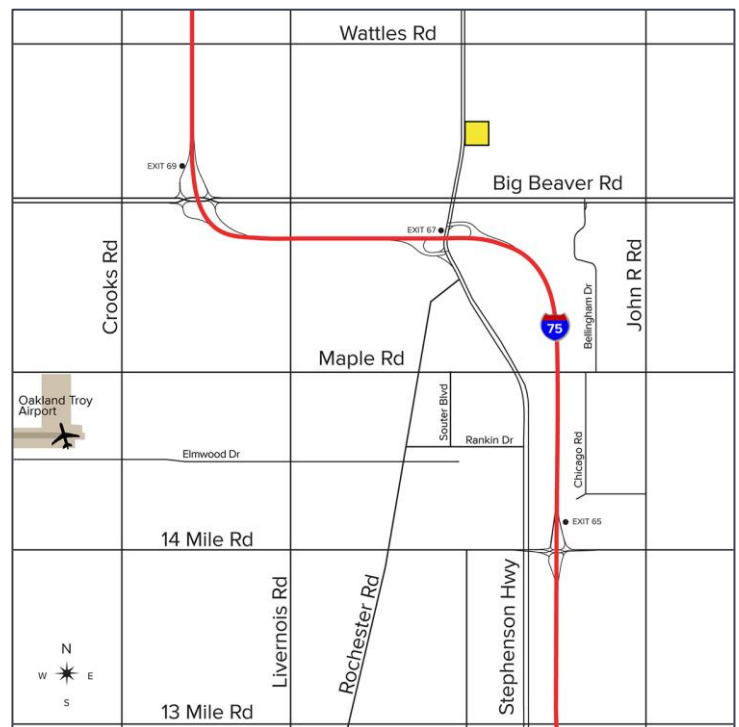

For more information, please contact:

**PETER VANDERKAAY**  
(248) 359 3837  
pvanderkaay@signatureassociates.com

**SIGNATURE ASSOCIATES**  
One Towne Square, Suite 1200  
Southfield, MI 48076  
www.signatureassociates.com

# 3330-3334 Rochester Road – Troy, Michigan

Retail For Lease

1,066  
Square Feet  
AVAILABLE

## Site Plan

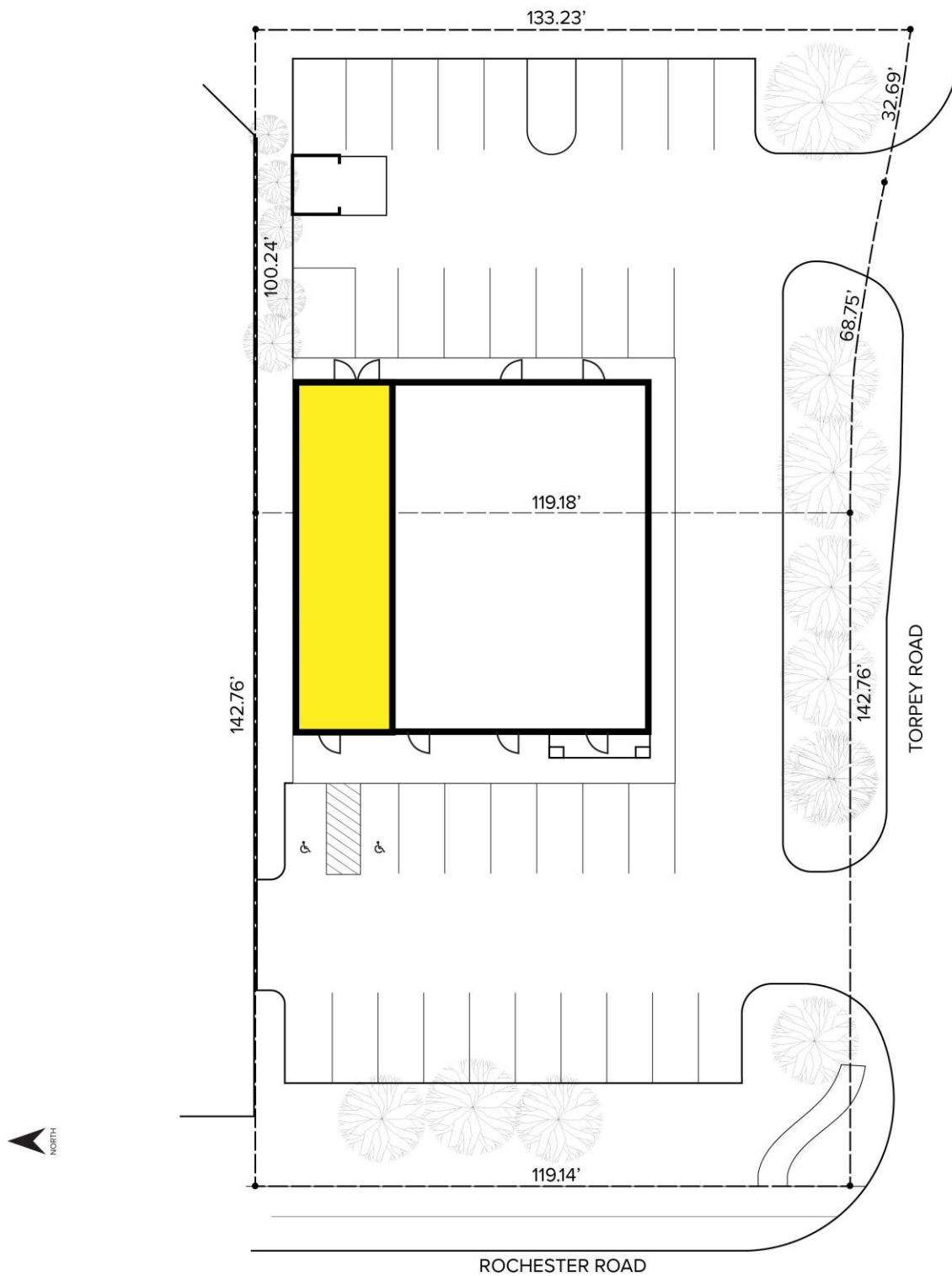

For more information, please contact:

**PETER VANDERKAAY**  
(248) 359 3837  
pvanderkaay@signatureassociates.com

**SIGNATURE ASSOCIATES**  
One Towne Square, Suite 1200  
Southfield, MI 48076  
www.signatureassociates.com

# 3330-3334 Rochester Road – Troy, Michigan

Retail For Lease

1,066  
Square Feet  
AVAILABLE

## Location

DEMOGRAPHICS		
	POPULATION	MED. HH INCOME
1 MILE	10,588	\$122,539
3 MILE	88,369	\$105,538
5 MILE	251,137	\$107,544

TRAFFIC COUNTS (TWO-WAY)	
73,035	Big Beaver Rd. E of Rochester Rd.
69,815	Big Beaver Rd. W of Rochester Rd.
64,094	Rochester Rd. N of Big Beaver Rd.
62,474	Rochester Rd. S of Big Beaver Rd.



For more information, please contact:

**PETER VANDERKAAY**  
(248) 359 3837  
pvanderkaay@signatureassociates.com

**SIGNATURE ASSOCIATES**  
One Towne Square, Suite 1200  
Southfield, MI 48076  
www.signatureassociates.com