

FOR SALE | FOR LEASE

MEDICAL BROWNSTONES AT MAITLAND CONCOURSE SOUTH

700-720 CONCOURSE PARKWAY SOUTH, MAITLAND, FL 32751



**NEW CLASS "A" MEDICAL OFFICE SPACE
FROM 5,178 - 9,000 ± RSF AVAILABLE
CENTRALIZED MAITLAND LOCATION
SHELL BUILDING DELIVERY**

Matt Weinberger
Vice President

D 321.281.8510

E mweinberger@lee-associates.com

Jason Bantel, CCIM

Senior Vice President

D 321.281.8509

E jbantel@lee-associates.com

- Medical/Clinical Use
- Four (4), Two-Story Buildings
- From 5,178 to 9,000 SF Available
- Approx. 6/1,000 SF parking ratio
- Zoning: PD - City of Maitland
- Contact Broker for Pricing Guidance



FROM 5,178 - 9,000 ± RSF AVAILABLE

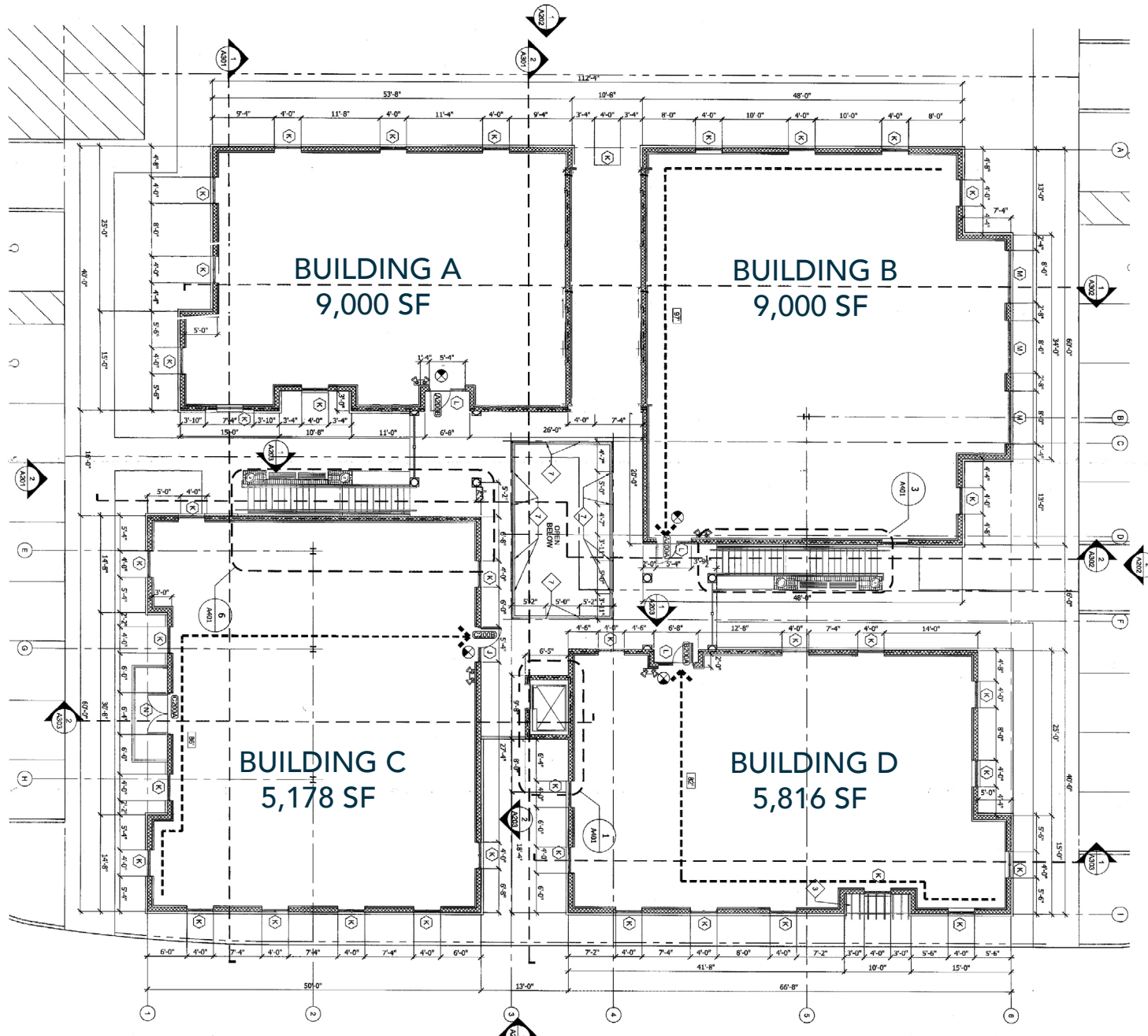

- Located in Maitland Concourse, next to AdventHealth's Maitland Surgery Center & Orlando Health Pediatric Hospital
- Adjacent to the high-end luxury mixed-use Trelago Town Center Development anchored by Amazon Fresh

- Close proximity to Winter Park, Maitland, and more of Central Florida's most affluent neighborhoods
- Traffic ingress/egress entrance with signalized traffic light
- Less than 1 mile from I-4 and South US Highway 17-92



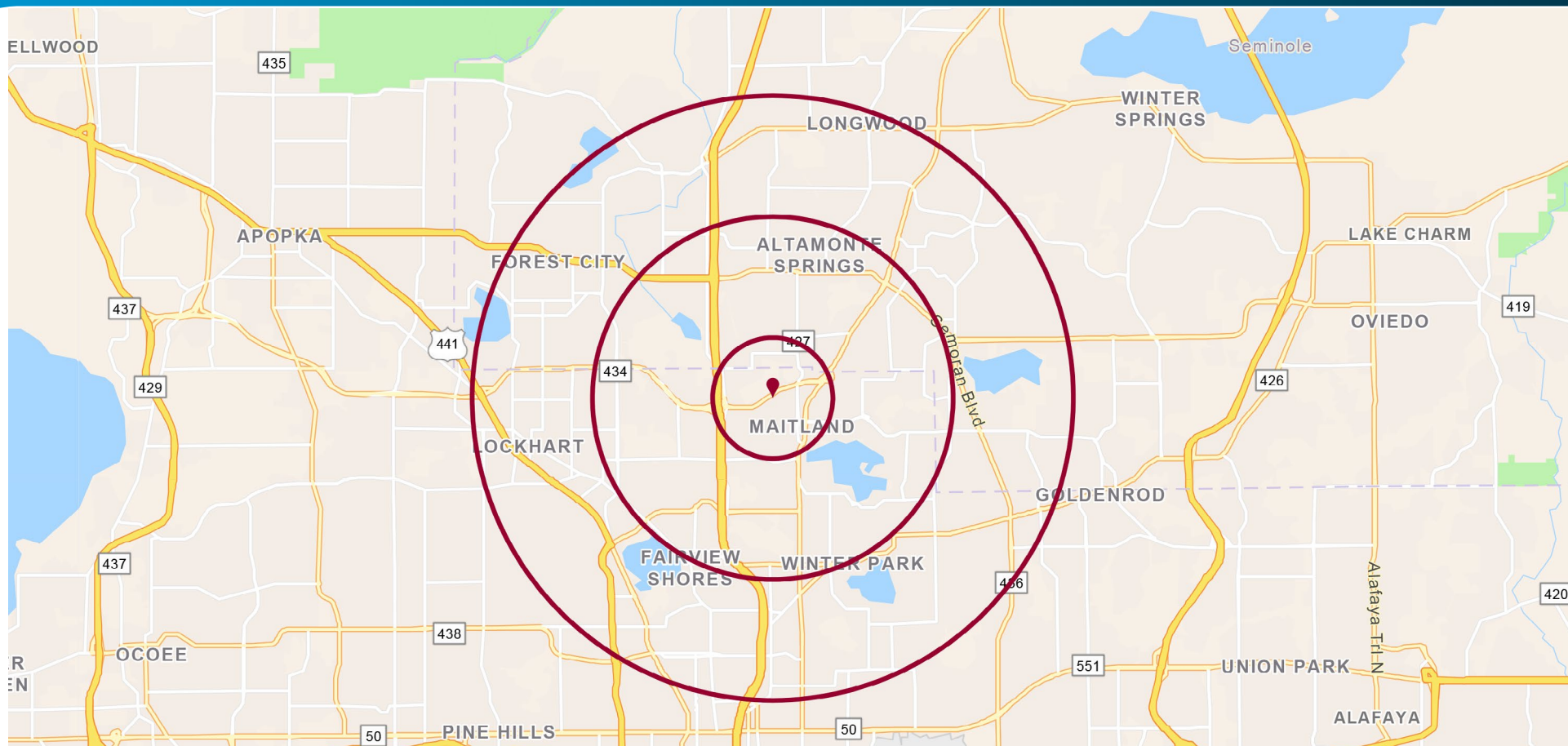

Population

1 Mile: 8,798
 3 Mile: 98,981
 5 Mile: 253,056



Daytime Population

1 Mile: 8,315
 3 Mile: 95,878
 5 Mile: 193,343



Households

1 Mile: 3,825
 3 Mile: 43,996
 5 Mile: 111,259



Avg Household Income

1 Mile: \$102,377
 3 Mile: \$90,740
 5 Mile: \$90,902



Avg Age Female

1 Mile: 47
 3 Mile: 42
 5 Mile: 41



Avg Age Male

1 Mile: 44
 3 Mile: 38
 5 Mile: 37



Avg Household Size

1 Mile: 2.3
 3 Mile: 2.2
 5 Mile: 2.1





For more information, please contact one of the following individuals:

CONTACT

Matt Weinberger
Vice President

D 321.281.8510

E mweinberger@lee-associates.com

Jason Bantel, CCIM
Senior Vice President

D 321.281.8509

E jbantel@lee-associates.com