

# FAIRGROUNDS COMMERCIAL PARK PADS

FOR SALE OR GROUND LEASE



## PROPERTY DETAILS

250 SOUTH FAIRGROUNDS ROAD, PRICE, UT 84501

- For sale or ground lease
- Asking \$8.00 PSF
- 1.18–3.84 total acres available
- Great site for a hotel, car wash, hospital, medical office
- Next to the Carbon County Fairgrounds, Softball Complex, Motocross Track, and Event Center

## 2024 DEMOS

**EST. POPULATION**  
 PRICE » 7,919  
 CARBON CO. » 20,670

**EST. HOUSEHOLDS**  
 PRICE » 3,171  
 CARBON CO. » 8,230

**EST. AVERAGE HH INCOME**  
 PRICE » \$67,695  
 CARBON CO. » \$73,128



**MOUNTAIN WEST**  
 COMMERCIAL REAL ESTATE

**GARRETT BLOMQUIST**  
 gblomquist@mwcre.com  
 direct 801.727.4414  
[View Profile](#)

**SCOTT BRADY**  
 sbrady@mwcre.com  
 direct 801.456.8804  
[View Profile](#)

**FULL SERVICE  
 COMMERCIAL REAL ESTATE**  
 312 East South Temple  
 Salt Lake City, UT 84111  
 Office 801.456.8800  
[www.mwcre.com](http://www.mwcre.com)

This statement with the information it contains is given with the understanding that all negotiations relating to the purchase, renting or leasing of the property described above shall be conducted through this office. The above information while not guaranteed has been secured from sources we believe to be reliable.

# FAIRGROUNDS COMMERCIAL PARK PADS

## SITE PLAN

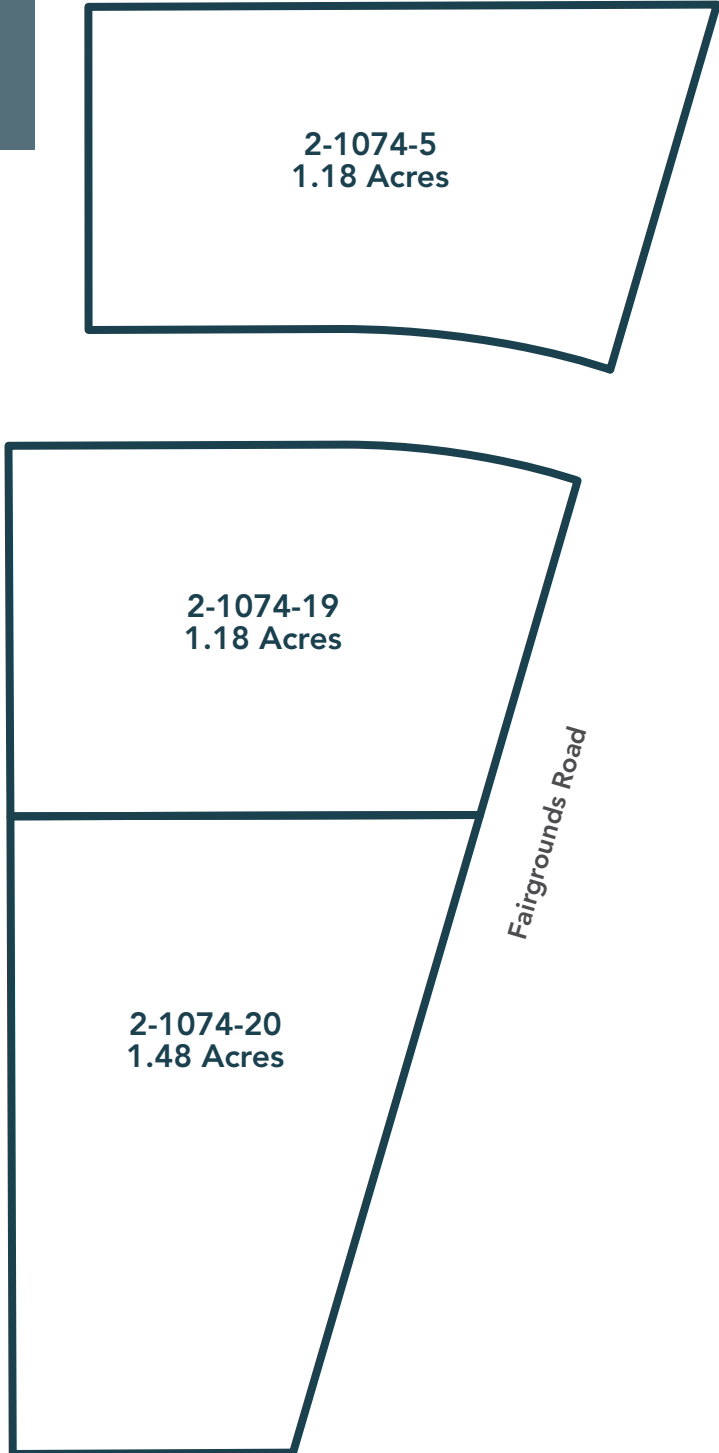

2-1074-5  
1.18 Acres

2-1074-19  
1.18 Acres

2-1074-20  
1.48 Acres

Fairgrounds Road



**MOUNTAIN WEST**  
COMMERCIAL REAL ESTATE

**GARRETT BLOMQUIST**  
gblomquist@mwcre.com  
direct 801.727.4414  
[View Profile](#)

**SCOTT BRADY**  
sbrady@mwcre.com  
direct 801.456.8804  
[View Profile](#)

**FULL SERVICE  
COMMERCIAL REAL ESTATE**  
312 East South Temple  
Salt Lake City, UT 84111  
Office 801.456.8800  
[www.mwcre.com](http://www.mwcre.com)

This statement with the information it contains is given with the understanding that all negotiations relating to the purchase, renting or leasing of the property described above shall be conducted through this office. The above information while not guaranteed has been secured from sources we believe to be reliable.



**MOUNTAIN WEST**  
COMMERCIAL REAL ESTATE

**GARRETT BLOMQUIST**

gblomquist@mwcre.com  
direct 801.727.4414  
[View Profile](#)

**SCOTT BRADY**

sbrady@mwcre.com  
direct 801.456.8804  
[View Profile](#)

**FULL SERVICE  
COMMERCIAL REAL ESTATE**  
312 East South Temple  
Salt Lake City, UT 84111  
Office 801.456.8800  
[www.mwcre.com](http://www.mwcre.com)