

PRICE

Lower-level Retail:
\$1,000 per month
Upper-level Office Space:
\$900 per month

SIZE

Ground Floor -
Approx 289 SF
Level 1.5 (office) -
Approx 400 SF

ZONING

Business



AFFORDABLE RETAIL & OFFICE SPACES IN THE HEART OF LANSDALE BOROUGH

Property Highlights:

Ideal Location:

- Situated in a mixed-use building with 8 residential apartments and the popular El Limon Mexican Restaurant
- Directly across the street from a 185-unit apartment complex and the Lansdale Train Station
- Just off Lansdale's bustling Main Street, providing excellent exposure

Versatile Spaces:

- Perfect for small retail shops, professional offices, or service-based businesses
- Affordable leasing in a growing and highly walkable downtown area

Take advantage of this excellent opportunity to establish your business in a thriving community!

PRESENTED BY

James R. Wrigley
215-519-2290 (m) | 215-855-5100 (o)
jimw@kpgcm.com

Keith T. Metzger
267-218-4819 (m) | 215-855-5100 ext 118 (o)
keithm@kpgcm.com

COMMERCIAL, RESIDENTIAL, OR OFFICE LEASE

314 Madison St., Lansdale, PA 19446

First Floor Retail



Floor 1.5 Office

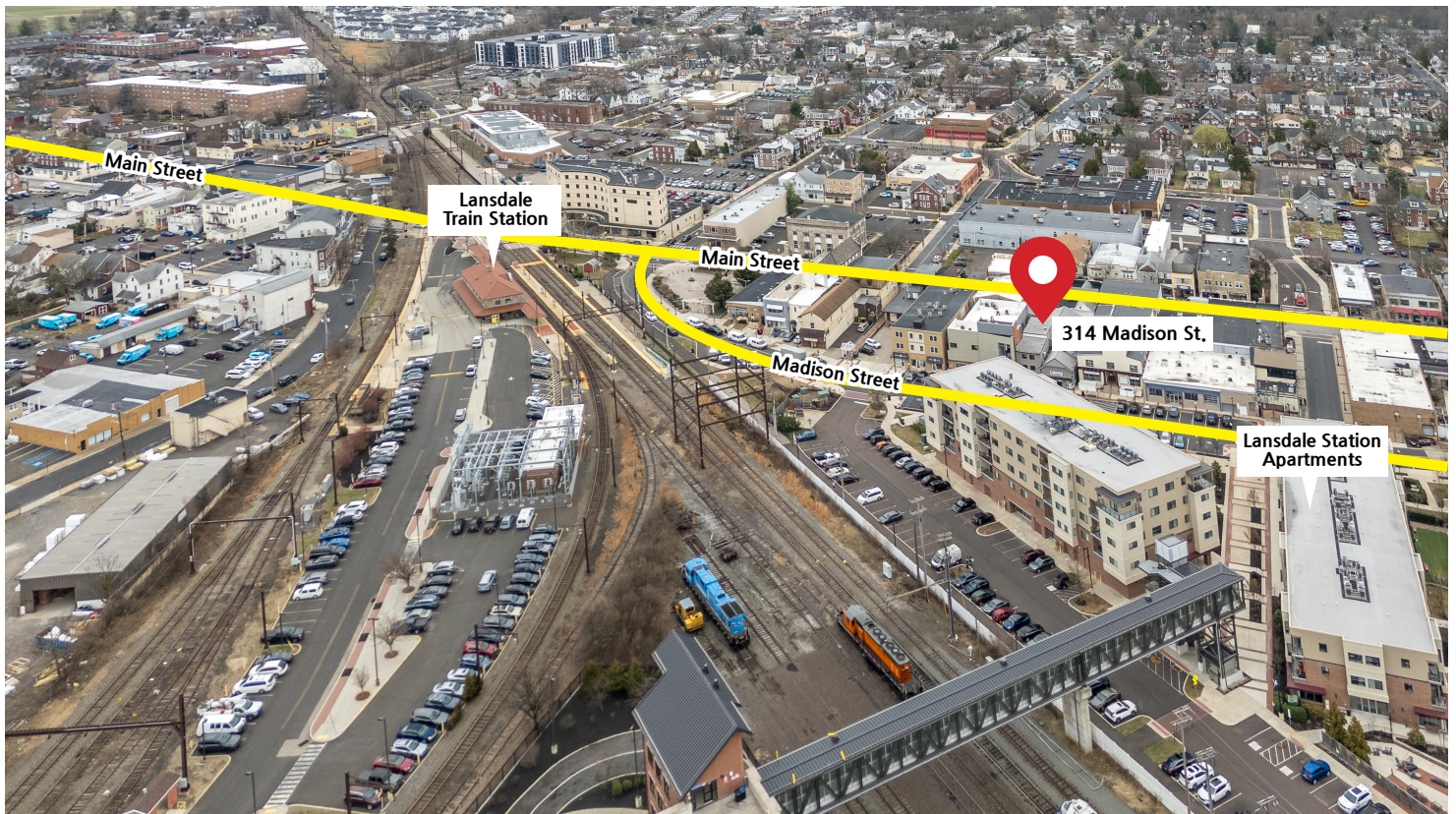

PRESENTED BY

James R. Wrigley
215-519-2290 (m)
215-855-5100 (o)
jimw@kpgcm.com

Keith T. Metzger
267-218-4819 (m)
215-855-5100 ext 118 (o)
keithm@kpgcm.com



COMMERCIAL, RESIDENTIAL, OR OFFICE LEASE

314 Madison St., Lansdale, PA 19446

Floor 1

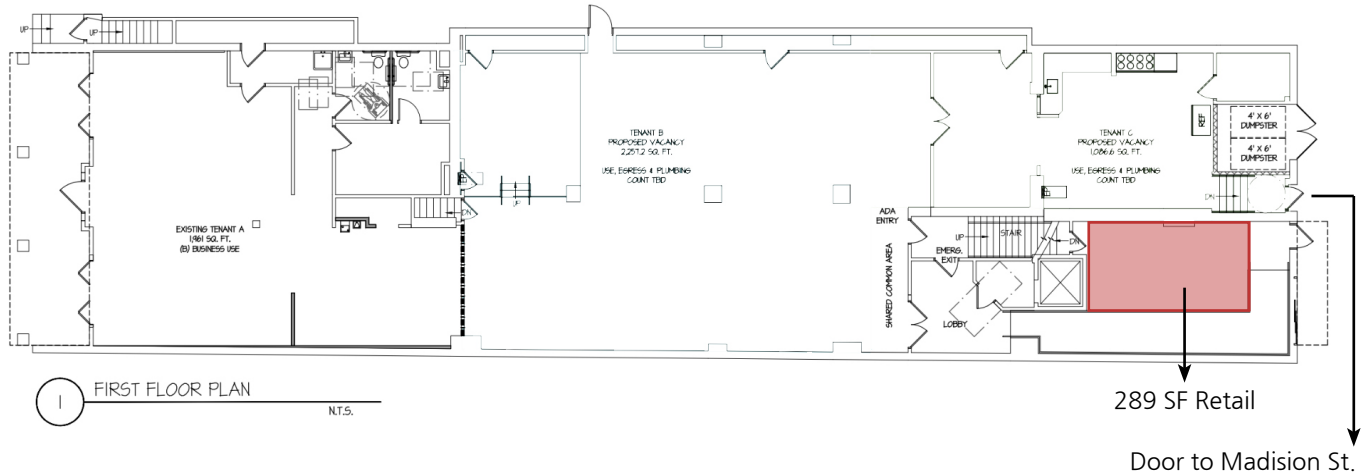

Floor 1.5

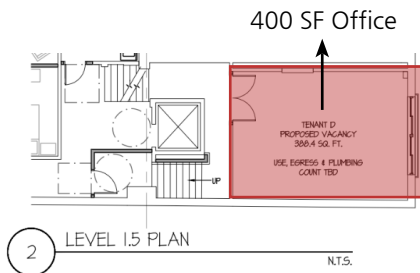

PRESENTED BY

James R. Wrigley
215-519-2290 (m)
215-855-5100 (o)
jimw@kpgcm.com

Keith T. Metzger
267-218-4819 (m)
215-855-5100 ext 118 (o)
keithm@kpgcm.com

