

Port 95 Logistics Center II

4140 SW 30th Avenue
Hollywood, FL 33312

31,141 SF Available



Contact Us

Larry Genet
Executive Vice President
+1 305 807 0004
larry.genet@cbre.com

Tom O'Loughlin
Vice Chairman
+1 954 817 3919
tom.oloughlin@cbre.com



Port 95 Logistics Center I

4140 SW 30th Avenue | Hollywood, FL 33312



Property Description

Port 95 Commerce Park is a leading industrial business park in Broward County Florida with over 2 million SF of warehouse and industrial space. Strategically located at a transportation nexus, in close proximity to I-95, State Road 84, the Florida Turnpike, I-595, Fort Lauderdale International Airport and minutes away from Port Everglades making it a perfect location for companies in Aviation/Aerospace, Marine Technology, and Advanced Manufacturing industries. The Class A business park is home to local businesses as well as Fortune 100 firms who service areas from South Florida to the entire state.

Highlights

- + ±31,141 SF available
- + ±3,500 SF office
- + ±24' Clear ceiling height
- + Located in Port 95 Business Park - high quality business park setting
- + Zoned IM-3, Industrial
- + Column Spacing 30' x 40'
- + Tilt wall construction
- + 100% Sprinklered
- + 149 surface spaces available; Parking ratio of 1.1/1,000 SF
- + 3 dock doors and 1 ramp
- + 1 mile (7 mins.) from the Fort Lauderdale-Hollywood International Airport and 4 miles (11 mins.) from Port Everglades
- + Interstate I-95 (3 mins.), I-595 (4 mins.) and Florida Turnpike (12 mins.) access via both Griffin and State Road 84 (Marina Mile)
- + Available May 1, 2025
- + Asking Rate: \$17.00 PSF NNN, Plus \$4.90 in OpEx

Property Site Plan

For Lease

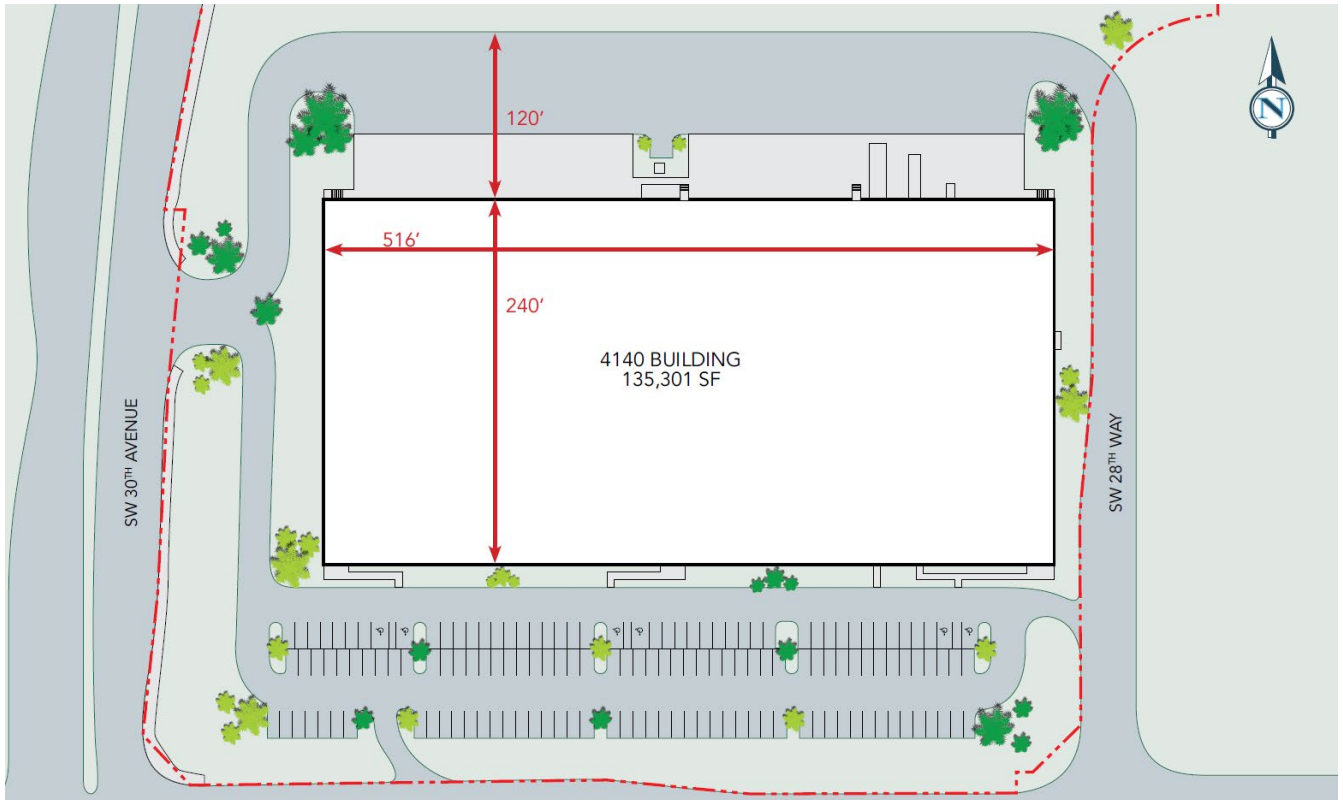

Location

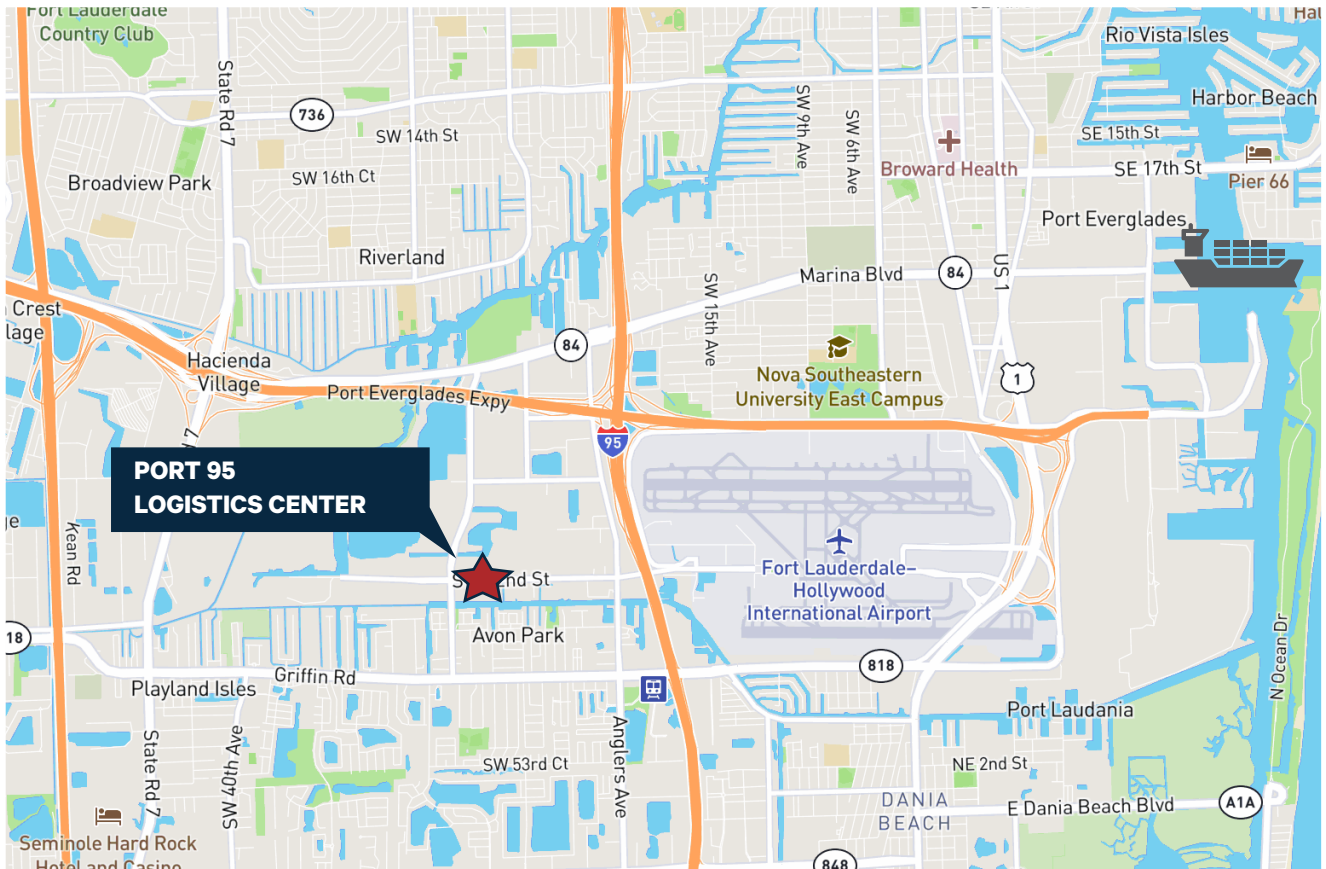

Floor Plan

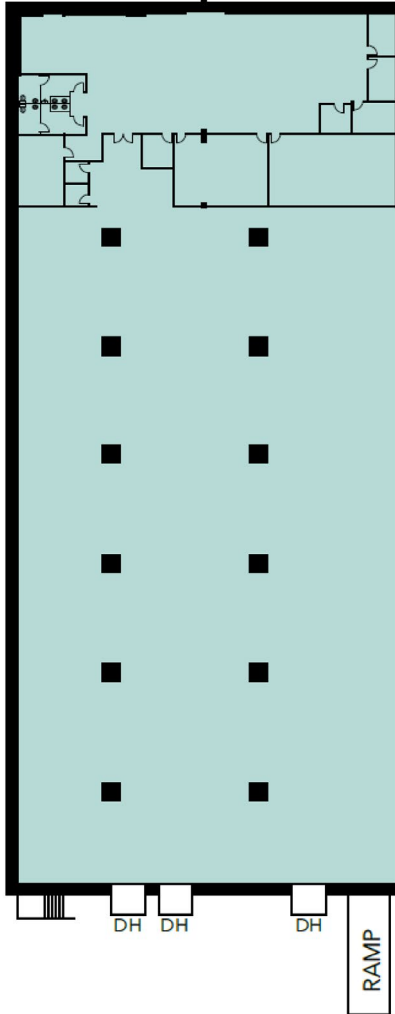

LOCATION WITHIN THE BUILDING

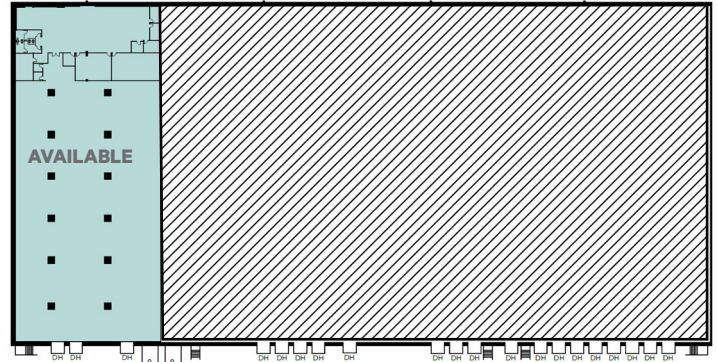

Contact Us

Larry Genet
Executive Vice President
+1 305 807 0004
larry.genet@cbre.com

Tom O'Loughlin
Vice Chairman
+1 954 817 3919
tom.oloughlin@cbre.com

© 2025 CBRE, Inc. All rights reserved. This information has been obtained from sources believed reliable, but has not been verified for accuracy or completeness. You should conduct a careful, independent investigation of the property and verify all information. Any reliance on this information is solely at your own risk. CBRE and the CBRE logo are service marks of CBRE, Inc. All other marks displayed on this document are the property of their respective owners, and the use of such logos does not imply any affiliation with or endorsement of CBRE. Photos herein are the property of their respective owners. Use of these images without the express written consent of the owner is prohibited.