



FOR SALE



13225 N COLUMBIA BLVD

Office Building with Excess Land

± 3,300 SF Building on 1.76 Acres | **Sale Price:** \$1,499,999

13225 N Columbia Blvd, Portland, OR 97203

- Plug-and-Play Office/HQ Opportunity w/ High-End Finishes
- Large Fenced/Secured Parking Area
- Excess (Unimproved) Land with Future Development/Yard Area Potential

BRODY COHEN, SIOR

Senior Vice President | Licensed in OR & WA
503-517-9878 | brody@capacitycommercial.com

MIKE HALE, SIOR

Principal | Licensed in OR & WA
503-517-7129 | mikehale@capacitycommercial.com

RYAN BOWERS

Senior Associate Broker | Licensed in OR & WA
503-517-9874 | ryanbowers@capacitycommercial.com



PROPERTY SUMMARY

FOR SALE



PROPERTY DETAILS

Address	13225 N Columbia Blvd, Portland, OR 97203
Building Size	± 3,300 SF
Lot Size	1.76 AC (76,665 SF)
Construction	Masonry
Private Offices	Multiple Private Offices, Conference Rooms, Breakroom
Parking	40 Off-Street Private Parking Spaces
Zoning	IH (Heavy Industrial)
Sale Price	\$1,499,999

Location Features

- In Close Proximity to I-5 via North Columbia Blvd
- Near Port of Portland Terminals
- 11 Miles to Portland International Airport
- Multiple Access Points to CBD

Nearby Highlights

- Amazon Distribution Center
- Cathedral Park
- Fulcrum Logistics
- IRC aluminum
- JR Simplot
- Peninsula Iron Works
- Port of Portland
- Radius Recycling
- T & G Trucking
- Time Oil Co
- US Distributng
- Western Machine Works



AERIAL



*Average Daily Traffic Volume | Traffic Counts are Provided by REGIS Online at SitesUSA.com ©2024 | Map data ©2024 Google Imagery ©2024, Airbus, CNES / Airbus, Maxar Technologies, Metro, Portland Oregon, Public Laboratory, State of Oregon, U.S. Geological Survey, USDA/FPAC/GEO



FLOOR PLAN

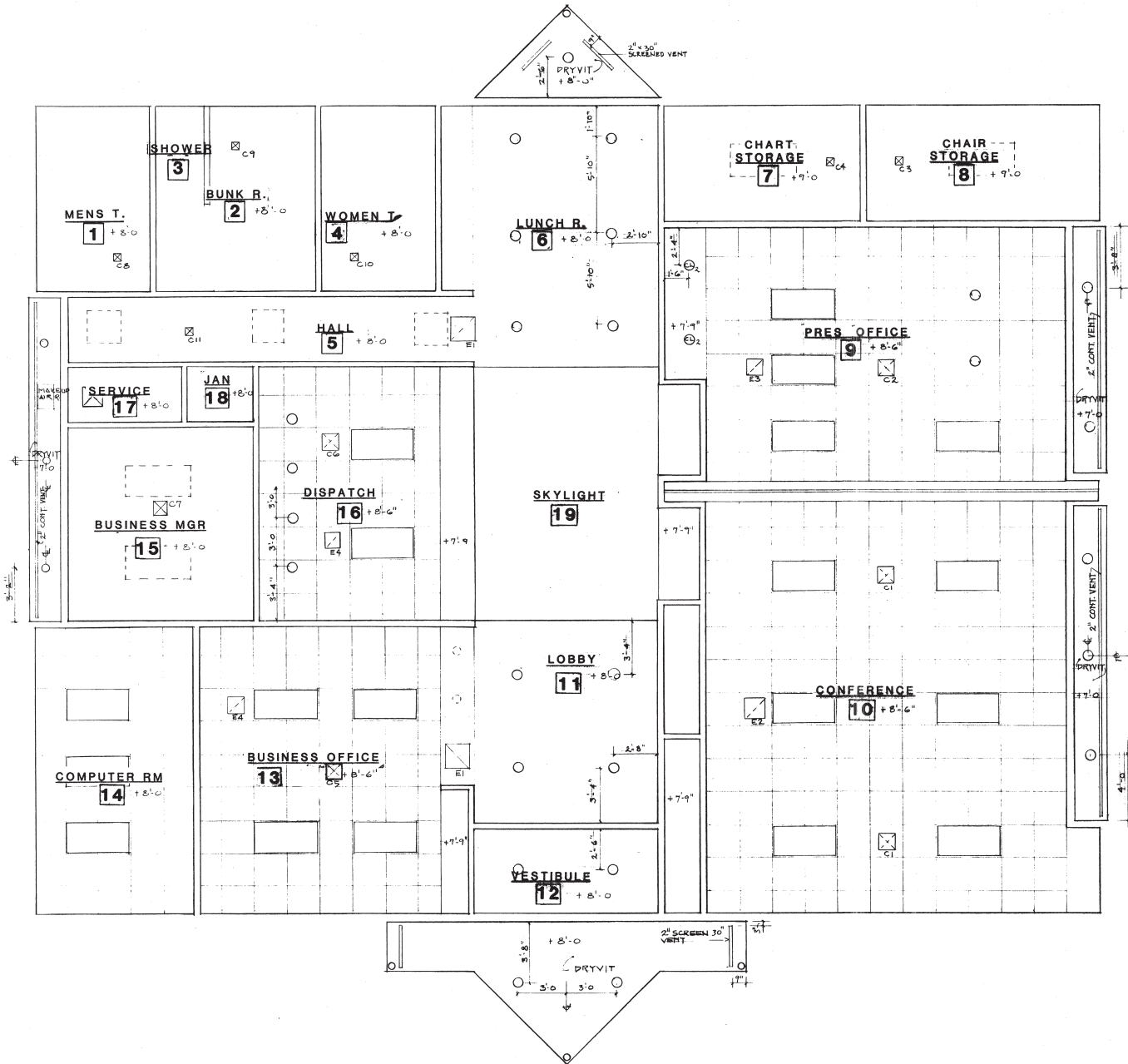



LOCAL AERIAL MAP

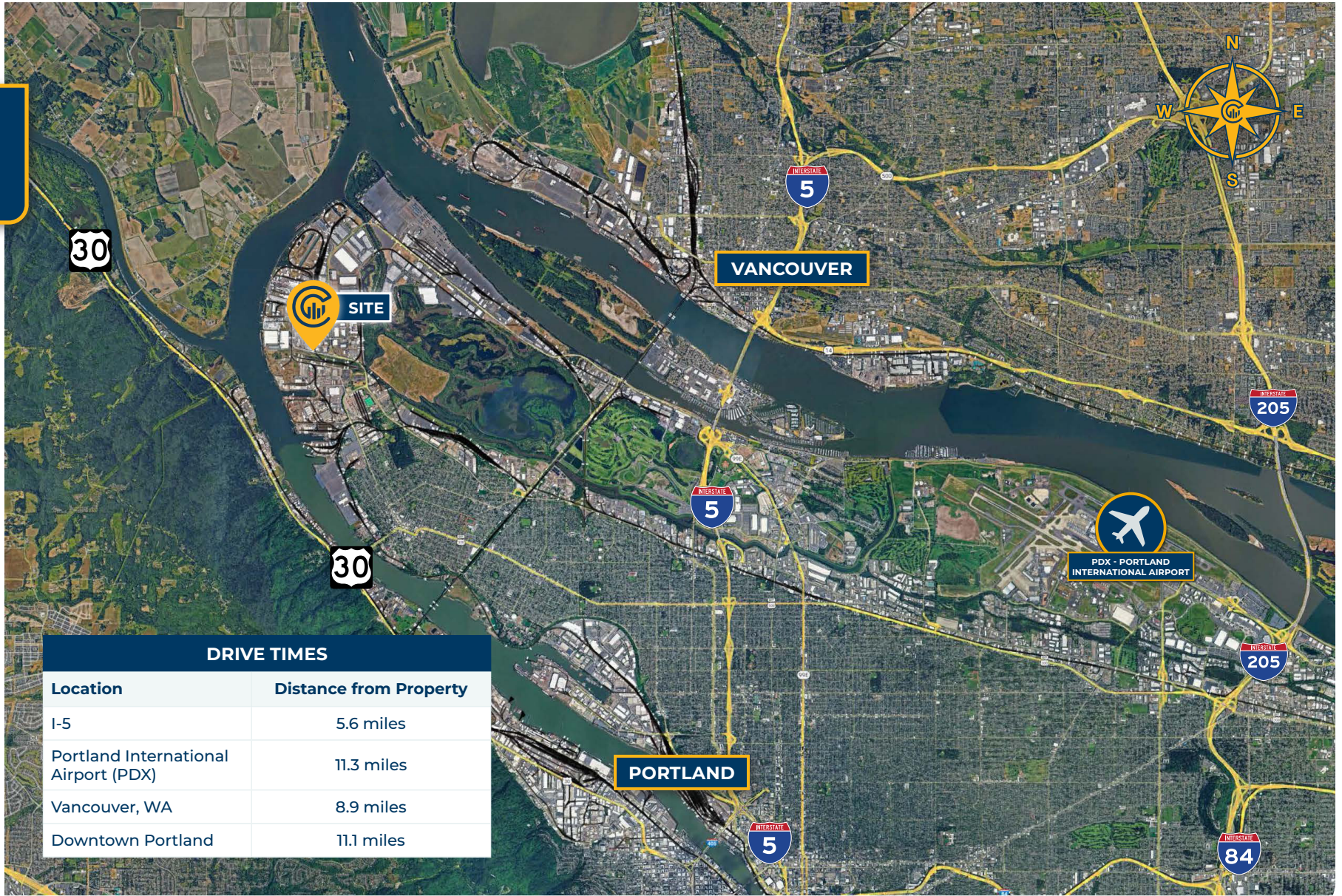

DRIVE TIMES	
Location	Distance from Property
I-5	5.6 miles
Portland International Airport (PDX)	11.3 miles
Vancouver, WA	8.9 miles
Downtown Portland	11.1 miles

*Average Daily Traffic Volume | Traffic Counts are Provided by REGIS Online at SitesUSA.com ©2024 | Map data ©2024 Google Imagery ©2024, Airbus, CNES / Airbus, Maxar Technologies, Metro, Portland Oregon, Public Laboratory, State of Oregon, U.S. Geological Survey, USDA/FPAC/GEO

<p>BRODY COHEN, SIOR Senior Vice President Licensed in OR & WA 503-517-9878 brody@capacitycommercial.com</p>	<p>MIKE HALE, SIOR Principal Licensed in OR & WA 503-517-7129 mikehale@capacitycommercial.com</p>	<p>RYAN BOWERS Senior Associate Broker Licensed in OR & WA 503-517-9874 ryanbowers@capacitycommercial.com</p>
--	---	---