

# PRESTON POINTE

1225 S Preston Rd, Celina, TX 75009

 INTERACTIVE  
MARKETING PACKAGE

*Rendering*



**MATTHEWS**<sup>TM</sup>  
REAL ESTATE INVESTMENT SERVICES

## BAYLOR WORMAN

DIR: (214) 600-5525 | MOB: (214) 227-2729  
baylor.worman@matthews.com  
License No. 784561 (TX)

## GRAYSON DUYCK

DIR: (214) 295-4247 | MOB: (214) 796-0289  
License No. 7725363 (TX)  
[grayson.duyck@matthews.com](mailto:grayson.duyck@matthews.com)



Rendering

**±40,618 SF - AVAILABLE**

- Building 1: ±1,500 SF - ±2,667 SF
- Building 2: Up to ±5,457 SF
- Building 3: Up to ±14,394 SF
- Building 4: Up to ±8,100 SF

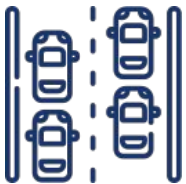

**±20,800 VPD** (Preston Road)

**PROJECT SCOPE**

- ±37,041 SF available for lease
- Close proximity to future HEB, Brookshire's, McDonald's & Walmart
- Frontage along Preston Road: the city's main thoroughfare connecting residents to US 380 & Future Outer Loop
- Three phases of future retail available
- Celina, TX named one of the fastest growing cities in Texas

**DEMOGRAPHICS**

	1-MILE	3-MILE	5-MILE
<b>POPULATION</b>			
Five-Year Projection	4,572	19,928	46,856
Current Year Estimate	4,020	17,459	41,009
2010 Census	1,359	5,311	12,083
Growth Current Year-Five-Year	2.7%	2.8%	2.9%
Growth 2010-Current Year	15.1%	17.6%	18.4%
<b>HOUSEHOLDS</b>			
Five-Year Projection	1,753	7,033	16,348
Current Year Estimate	1,535	6,140	14,261
2010 Census	462	1,674	3,778
Growth Current Year-Five-Year	2.8%	2.9%	2.9%
Growth 2010-Current Year	16.9%	20.1%	21.6%
<b>INCOME</b>			
Average Household Income	\$115,479	\$149,387	\$169,935

BLDG	TENANT	SPACE
1	AVAILABLE	2,667 SF
2	AVAILABLE	5,457 SF
3	AVAILABLE	14,394 SF
4	AVAILABLE	8,100 SF

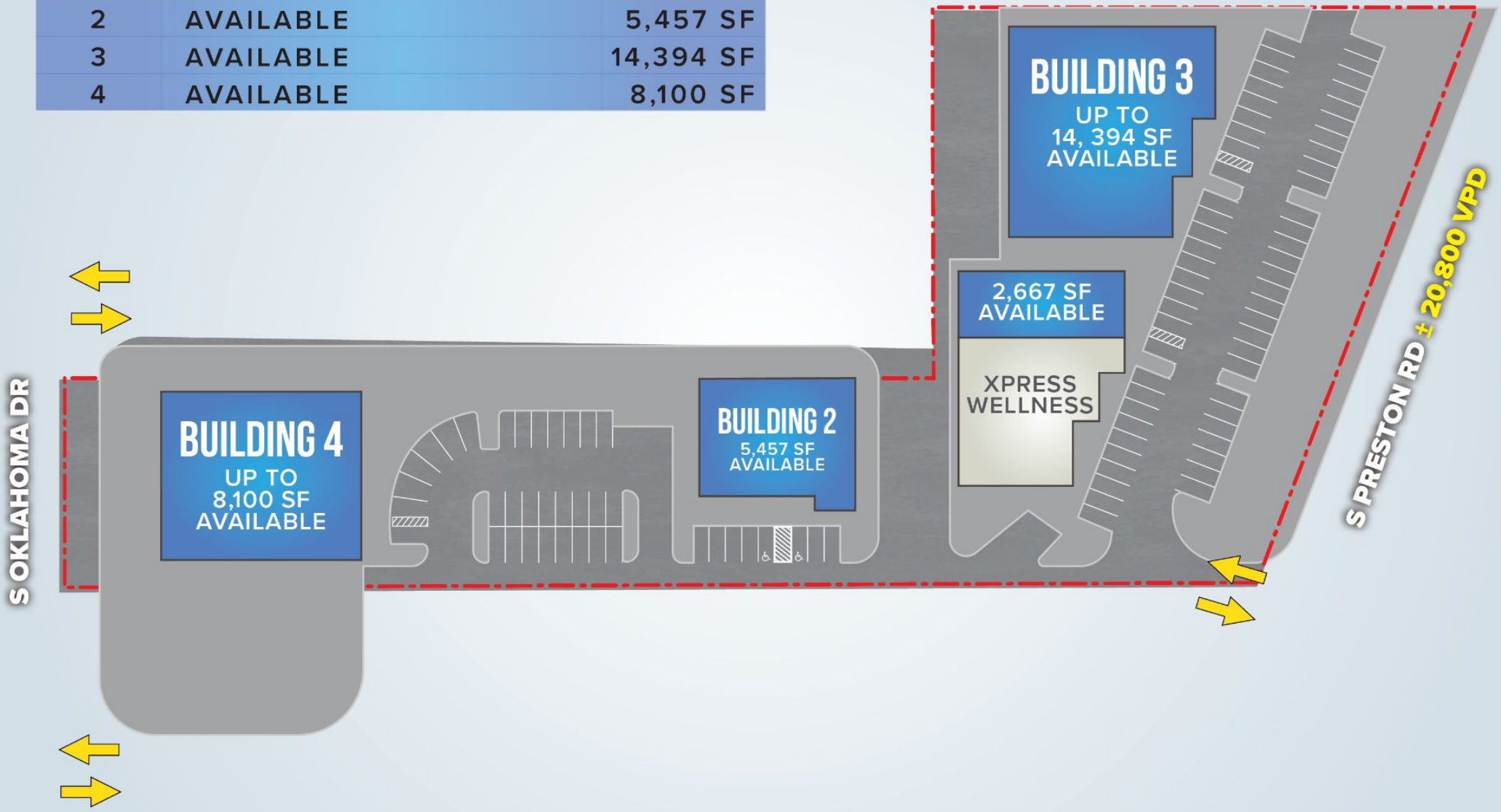

Preston Pointe  
Retail for Lease

**MATTHEWS**<sup>TM</sup>  
REAL ESTATE INVESTMENT SERVICES

1225 S PRESTON RD  
Celina, TX 75009



BLDG	TENANT	SPACE
1	AVAILABLE	2,667 SF
2	AVAILABLE	5,457 SF
3	AVAILABLE	14,394 SF
4	AVAILABLE	8,100 SF

S OKLAHOMA DR

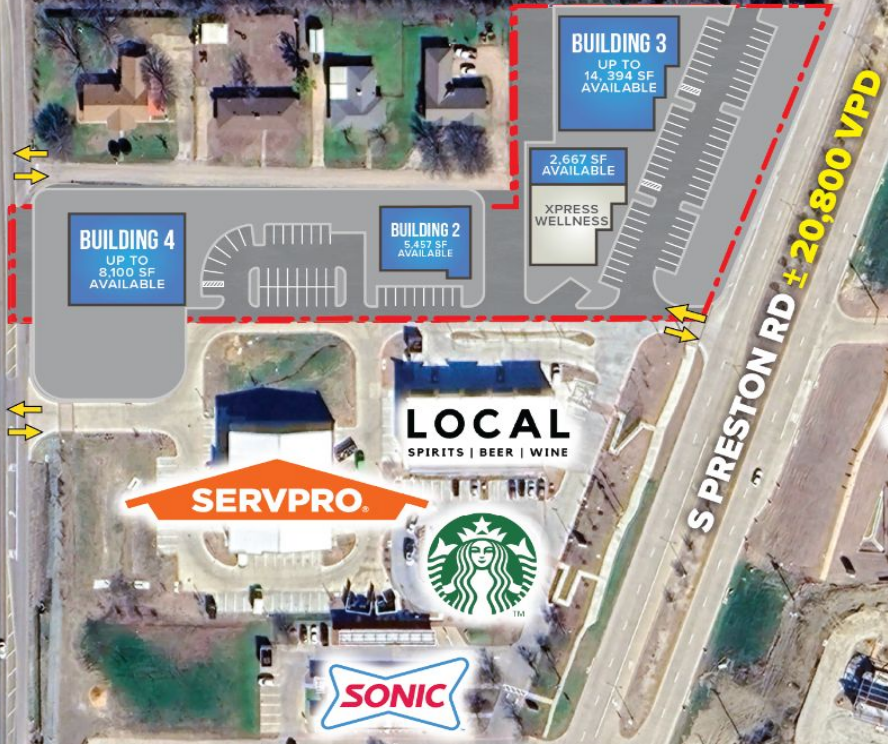

S PRESTON RD ± 20,800 VPD

MEDIAN CUT

MEDIAN CUT



HILLSIDE VILLAGE  
289 LOTS

TEXAS REPUBLIC BANK  
Banking like it oughta be!

Preston Pointe  
Retail for Lease

**MATTHEWS**<sup>TM</sup>  
REAL ESTATE INVESTMENT SERVICES



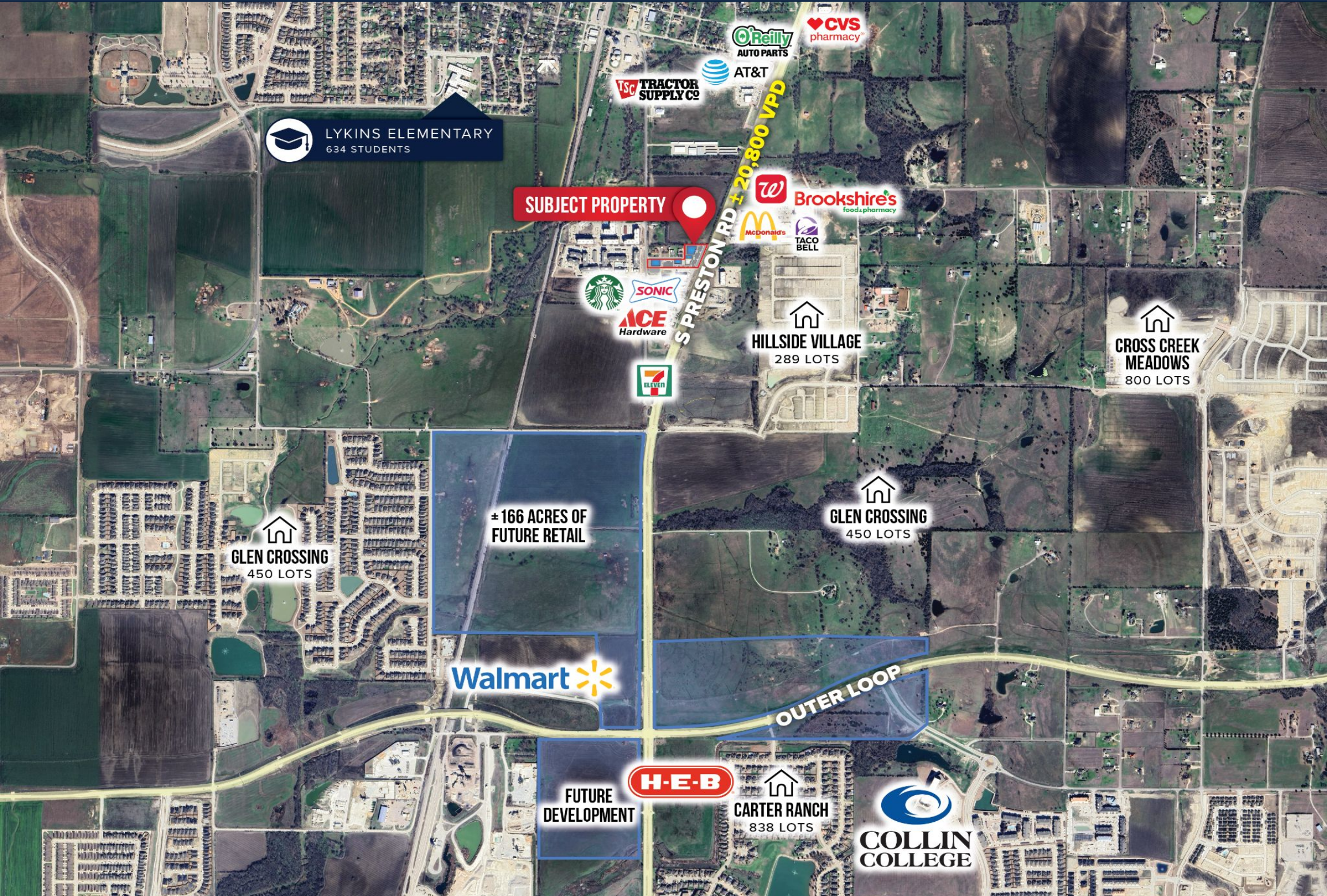







1225 S PRESTON RD  
Celina, TX 75009



 **LYKINS ELEMENTARY**  
634 STUDENTS

**SUBJECT PROPERTY**

**S PRESTON RD ± 20,800 VPD**

-  O'Reilly AUTO PARTS
-  CVS pharmacy
-  AT&T
-  TSC TRACTOR SUPPLY CO
-  Starbucks
-  SONIC
-  ACE Hardware
-  7-ELEVEN
-  McDonald's
-  TACO BELL
-  Brookshire's food & pharmacy

 **HILLSIDE VILLAGE**  
289 LOTS

 **CROSS CREEK MEADOWS**  
800 LOTS

 **GLEN CROSSING**  
450 LOTS

**± 166 ACRES OF FUTURE RETAIL**

 **GLEN CROSSING**  
450 LOTS

**Walmart** 

**OUTER LOOP**

**FUTURE DEVELOPMENT**



 **CARTER RANCH**  
838 LOTS

 **COLLIN COLLEGE**

## AREA OVERVIEW

### CELINA, TX

Celina, Texas, is a rapidly growing city located in Collin and Denton counties, *about 40 miles north of Dallas*. The city is part of the Dallas-Fort Worth metroplex, providing residents with easy access to the amenities and job opportunities of the larger metropolitan area while maintaining a quieter, more relaxed lifestyle. Celina is recognized for its excellent school district, parks, and family-friendly events. The area's housing market has seen significant growth, with new residential developments and businesses continually emerging to accommodate the increasing population.

Celina, Texas has become a hotspot for new residential developments, attracting families and professionals looking for a balance between suburban living and access to urban amenities. The local economy is bolstered by a *surge in real estate development, with numerous master-planned communities* being built to accommodate the increasing population. Celina's population has been growing at an impressive rate, with *projections estimating it could reach 100,000 residents by 2030*. The city's focus on creating a vibrant, sustainable community is evident in its initiatives to attract diverse businesses and industries, enhance public services, and maintain a high quality of life for its residents. As a result, Celina is rapidly transforming from a rural town into a thriving suburban community with a strong economic foundation.



**41,009**

**CURRENT YEAR  
POPULATION WITHIN 5-MILES**



**\$169,935**

**AVG HOUSEHOLD  
INCOME WITHIN 5 MILES**



**\$95.4 M**

**MONEY SPENT BY THE CITY IN 2023  
ON IMPROVEMENT PROJECTS**





**Information About Brokerage Services**

Texas law requires all real estate license holders to give the following information about brokerage services to prospective buyers, tenants, sellers and landlords.

11-2-2015



**TYPES OF REAL ESTATE LICENSE HOLDERS:**

- A **BROKER** is responsible for all brokerage activities, including acts performed by sales agents sponsored by the broker.
- A **SALES AGENT** must be sponsored by a broker and works with clients on behalf of the broker.

**A BROKER'S MINIMUM DUTIES REQUIRED BY LAW (A client is the person or party that the broker represents):**

- Put the interests of the client above all others, including the broker's own interests;
- Inform the client of any material information about the property or transaction received by the broker;
- Answer the client's questions and present any offer to or counter-offer from the client; and
- Treat all parties to a real estate transaction honestly and fairly.

**A LICENSE HOLDER CAN REPRESENT A PARTY IN A REAL ESTATE TRANSACTION:**

**AS AGENT FOR OWNER (SELLER/LANDLORD):** The broker becomes the property owner's agent through an agreement with the owner, usually in a written listing to sell or property management agreement. An owner's agent must perform the broker's minimum duties above and must inform the owner of any material information about the property or transaction known by the agent, including information disclosed to the agent or subagent by the buyer or buyer's agent.

**AS AGENT FOR BUYER/TENANT:** The broker becomes the buyer/tenant's agent by agreeing to represent the buyer, usually through a written representation agreement. A buyer's agent must perform the broker's minimum duties above and must inform the buyer of any material information about the property or transaction known by the agent, including information disclosed to the agent by the seller or seller's agent.

**AS AGENT FOR BOTH - INTERMEDIARY:** To act as an intermediary between the parties the broker must first obtain the written agreement of *each party* to the transaction. The written agreement must state who will pay the broker and, in conspicuous bold or underlined print, set forth the broker's obligations as an intermediary. A broker who acts as an intermediary:

- Must treat all parties to the transaction impartially and fairly;
- May, with the parties' written consent, appoint a different license holder associated with the broker to each party (owner and buyer) to communicate with, provide opinions and advice to, and carry out the instructions of each party to the transaction.
- Must not, unless specifically authorized in writing to do so by the party, disclose:
  - o that the owner will accept a price less than the written asking price;
  - o that the buyer/tenant will pay a price greater than the price submitted in a written offer; and
  - o any confidential information or any other information that a party specifically instructs the broker in writing not to disclose, unless required to do so by law.

**AS SUBAGENT:** A license holder acts as a subagent when aiding a buyer in a transaction without an agreement to represent the buyer. A subagent can assist the buyer but does not represent the buyer and must place the interests of the owner first.

**TO AVOID DISPUTES, ALL AGREEMENTS BETWEEN YOU AND A BROKER SHOULD BE IN WRITING AND CLEARLY ESTABLISH:**

- The broker's duties and responsibilities to you, and your obligations under the representation agreement.
- Who will pay the broker for services provided to you, when payment will be made and how the payment will be calculated.

**LICENSE HOLDER CONTACT INFORMATION:** This notice is being provided for information purposes. It does not create an obligation for you to use the broker's services. Please acknowledge receipt of this notice below and retain a copy for your records.

Matthews Real Estate Investment Services, Inc.	9005919	transactions@matthews.com	866-889-0050
Licensed Broker /Broker Firm Name or Primary Assumed Business Name	License No.	Email	Phone
Patrick Graham	528005	licensing@matthews.com	866-889-0050
Designated Broker of Firm	License No.	Email	Phone
Patrick Graham	528005	licensing@matthews.com	866-889-0050
Licensed Supervisor of Sales Agent/ Associate	License No.	Email	Phone
Sales Agent/Associate's Name	License No.	Email	Phone

Buyer/Tenant/Seller/Landlord Initials

Date

Regulated by the Texas Real Estate Commission

Information available at [www.trec.texas.gov](http://www.trec.texas.gov)

IABS 1-0

**CONFIDENTIALITY & DISCLAIMER STATEMENT**

This Leasing Package contains select information pertaining to the business and affairs of **1225 S Preston Rd, Ste 100, Celina, TX 75009** ("Property"). It has been prepared by Matthews Real Estate Investment Services. This Leasing Package may not be all-inclusive or contain all of the information a prospective lessee may desire. The information contained in this Leasing Package is confidential and furnished solely for the purpose of a review by a prospective lessee of the Property. The material is based in part upon information supplied by the Owner. Owner, nor their officers, employees, or agents makes any representation or warranty, express or implied, as to the accuracy or completeness of this Leasing Package or any of its contents and no legal liability is assumed or shall be implied with respect thereto. Prospective lessees should make their own projections and form their own conclusions without reliance upon the material contained herein and conduct their own due diligence.

Owner and Matthews Real Estate Investment Services expressly reserve the right, at their sole discretion, to reject any and all expressions of interest or offers to lease the Property and to terminate discussions with any person or entity reviewing this Leasing Package or making an offer to lease the Property unless and until a lease has been fully executed and delivered.

In no event shall a prospective lessee have any other claims against Owner or Matthews Real Estate Investment Services or any of their affiliates or any of their respective officers, Directors, shareholders, owners, employees, or agents for any damages, liability, or causes of action relating to this solicitation process or the marketing of the Property.

This Leasing Package shall not be deemed to represent the state of affairs of the Property or constitute an indication that there has been no change in the state of affairs of the Property since the date this Leasing Package.