



JOIN THESE RETAILERS



RETAIL FOR LEASE

- Fully built-out 2nd gen restaurant, with 110' of frontage along Route 7 with 61,498 ADT
- 398 Apartment units above with 100 dedicated retail parking spaces
- Within a 10 minute walk of 3.5M SF of office space
- Adjacent to the Greensboro Metro (1,587 ADR)

KELLY ATKINSON
katkinson@klnb.com
202-420-7762

MATT SKALET
mskalet@klnb.com
202-420-7775

JENNIFER PRICE
jprice@klnb.com
202-420-7768

KIM STEIN
kstein@klnb.com
202-652-2338

LOCATION

LUMEN TYSONS

1755 TYSONS CENTRAL STREET, TYSONS, VA, 22182

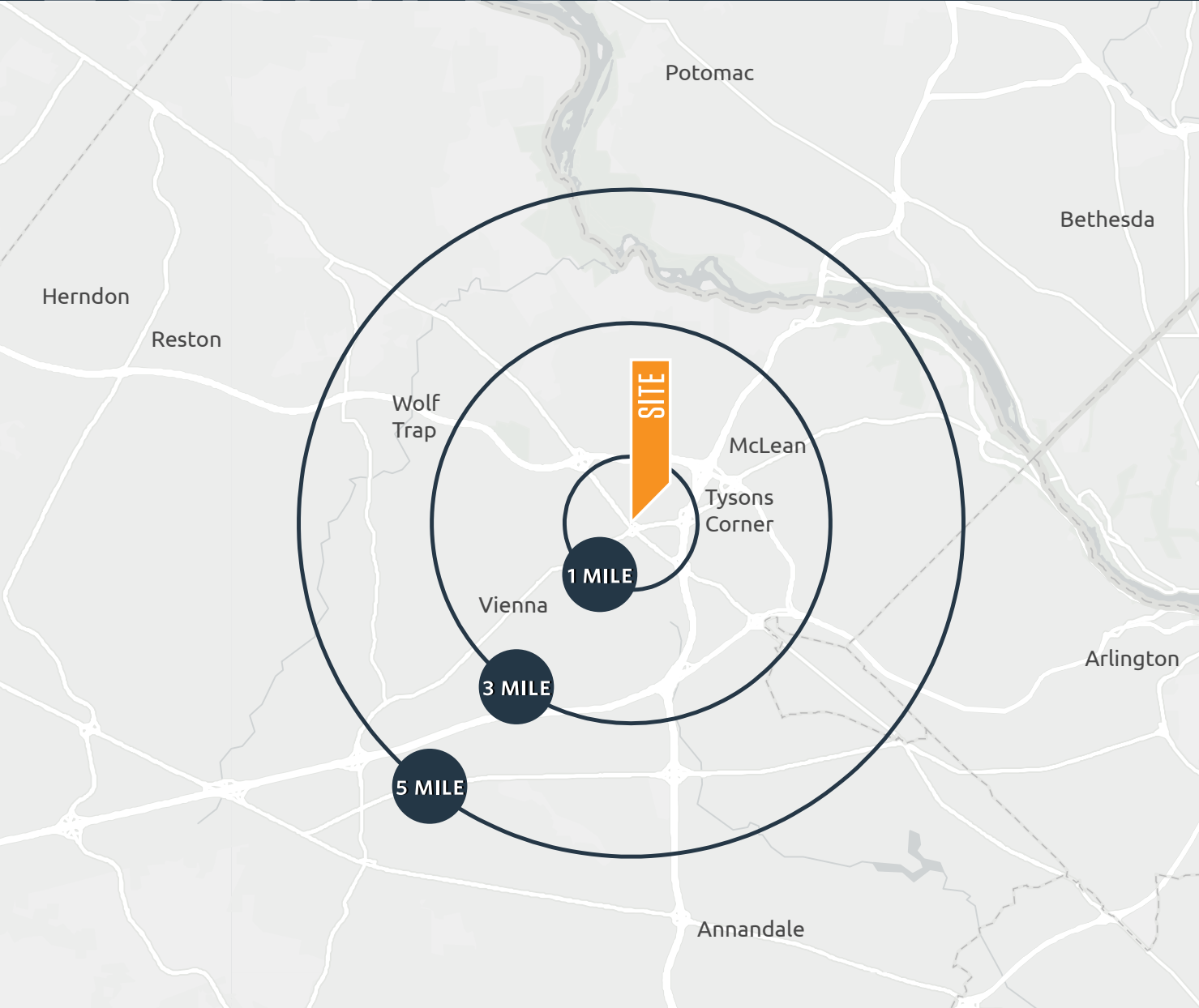

AVAILABLE SPACE

SIZE	RENT	NNN	CONDITION
9,220 SF	\$80 Gross		Fully Built Out 2nd Gen Restaurant
1,976 SF	\$50/SF NNN	\$12/SF	Cold, dark shell
909 SF	\$50/SF NNN	\$12/SF	Cold, dark shell

DEMOGRAPHICS | 2022:

10 MIN DRIVE	1-MILE	3-MILE	5-MILE
Population			
121,423	19,452	110,460	265,353
Daytime Population			
186,130	70,063	163,409	325,938
Average HH Income			
\$224,884	\$190,013	\$223,357	\$224,846
Spending on Food Away from Home			
\$432,434,564	\$76,784,849	\$387,918,976	\$879,831,379

TRAFFIC COUNTS | 2021:

Leesburg Pike	61,498 ADT
Chain Bridge Road	31,190 ADT



KELLY ATKINSON
katkinson@klnb.com
202-420-7762

MATT SKALET
mskalet@klnb.com
202-420-7775

JENNIFER PRICE
jprice@klnb.com
202-420-7768

KIM STEIN
kstein@klnb.com
202-652-2338



SITE PLAN

LUMEN TYSONS

1755 TYSONS CENTRAL STREET, TYSONS, VA, 22182

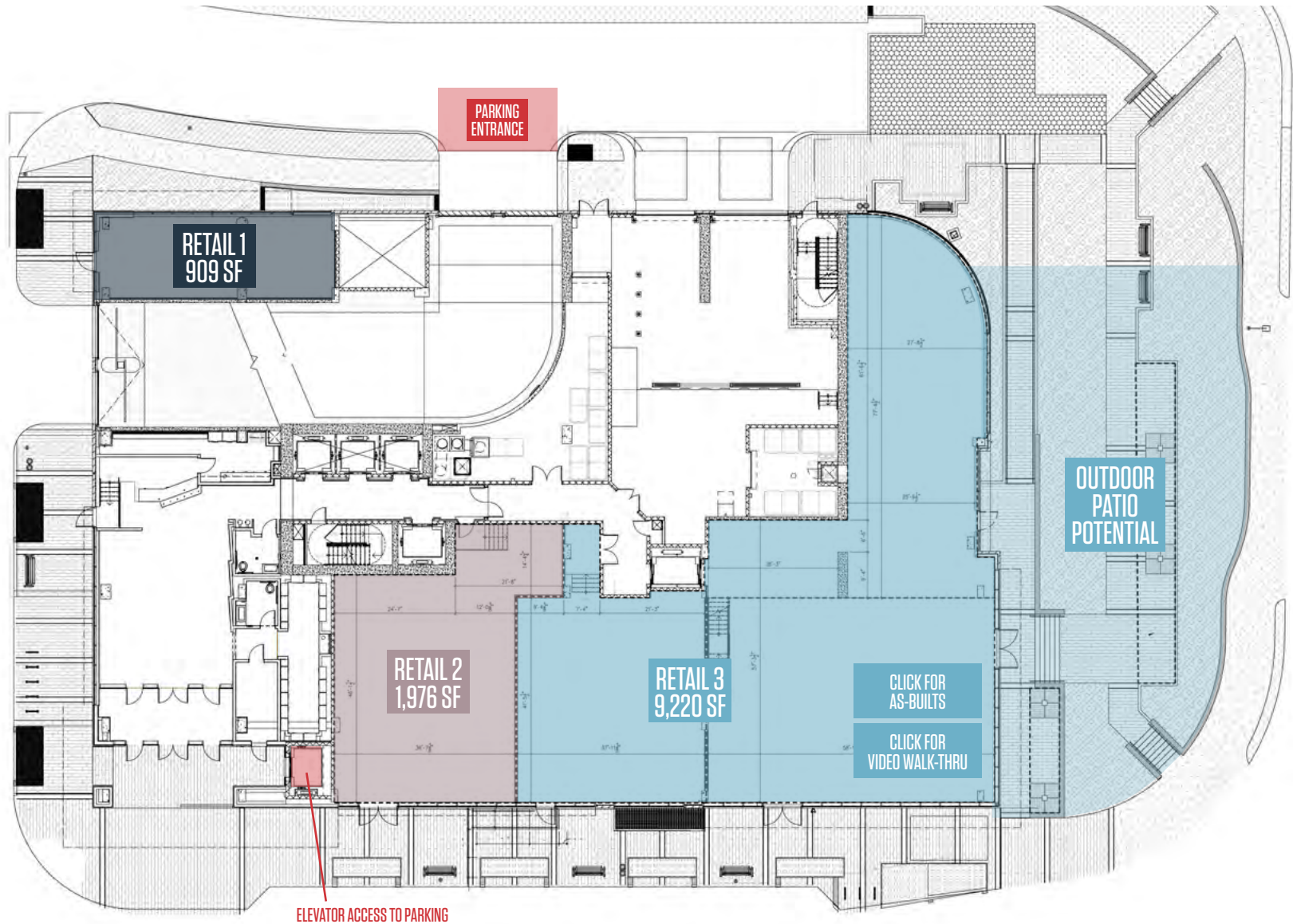

LEESBURG PIKE (61,498 ADT)

KELLY ATKINSON
katkinson@klnb.com
202-420-7762

MATT SKALET
mskalet@klnb.com
202-420-7775

JENNIFER PRICE
jprice@klnb.com
202-420-7768

KIM STEIN
kstein@klnb.com
202-652-2338



AERIAL

LUMEN TYSONS

1755 TYSONS CENTRAL STREET, TYSONS, VA, 22182



KELLY ATKINSON
katkinson@klnb.com
202-420-7762

MATT SKALET
mskalet@klnb.com
202-420-7775

JENNIFER PRICE
jprice@klnb.com
202-420-7768

KIM STEIN
kstein@klnb.com
202-652-2338





LUMEN TYSONS

1755 TYSONS CENTRAL STREET, TYSONS, VA 22182

FOR MORE INFORMATION, PLEASE CONTACT:

KELLY ATKINSON

katkinson@klnb.com
202-420-7762

MATT SKALET

mkalet@klnb.com
202-420-7775

JENNIFER PRICE

jprice@klnb.com
202-420-7768

KIM STEIN

kstein@klnb.com
202-652-2338

1130 Connecticut Avenue NW, Suite 600, Washington, DC 20036

.....

klnb.com

 facebook.com/KLNB

 [@KLNBLLC](https://twitter.com/KLNBLLC)

 linkedin.com/company/klnb

 instagram.com/klnbllc

CLICK TO VIEW PROPERTY WEBSITE

While we have no reason to doubt the accuracy of any of the information supplied, we cannot, and do not, guarantee its accuracy. All information should be independently verified prior to a purchase or lease of the property. We are not responsible for errors, omissions, misuse, or misinterpretation of information contained herein and make no warranty of any kind, express or implied, with respect to the property or any other matters.