

Riverfront Office Space For Lease

2291 Riverfront Parkway
Cuyahoga Falls, OH 44221

Contact Us

Steve Lazarides
First Vice President
+1 330 670 4410
steve.lazarides@cbre.com

Dean Bacopoulos
Vice President
+1 330 670 4405
dean.bacopoulos@cbre.com

Andy Flowers
Associate
+1 330 607 4411
andy.flowers@cbre.com



Property Overview

This exceptional office space, offers a prime opportunity for businesses seeking a dynamic and attractive location. Amenities include a free surface lot for drive up convenience, and a private patio with stunning views of the breath taking Cuyahoga River, providing an ideal setting for employee breaks or informal meetings. This combination of practical features and aesthetic appeal makes for highly sought after work environment.

Nestled on Riverfront Parkway in Cuyahoga Falls, this property boasts an unbeatable location in a lively downtown area. It offers easy access from Route 8 and direct access to bus stops on Portage Trail, ensuring excellent connectivity for clients and employees. The area has a vibrant mix of retail and dining options, all within walking distance, creating a convenient and rich urban experience. With the beautiful Cuyahoga River at your doorstep, businesses can admire the scenic beauty and recreational opportunities.

Property Highlights:

- + **Rent** - \$18.00 SF (Modified Gross not including utilities)
- + **Size** - 3,568 Sq. Ft.
- + Functional layout
- + Immediately available
- + Easy access from OH-8
- + Free surface parking
- + Furnished
- + Patio seating with river views
- + Walking distance to retail and dining establishments



Floor Plan

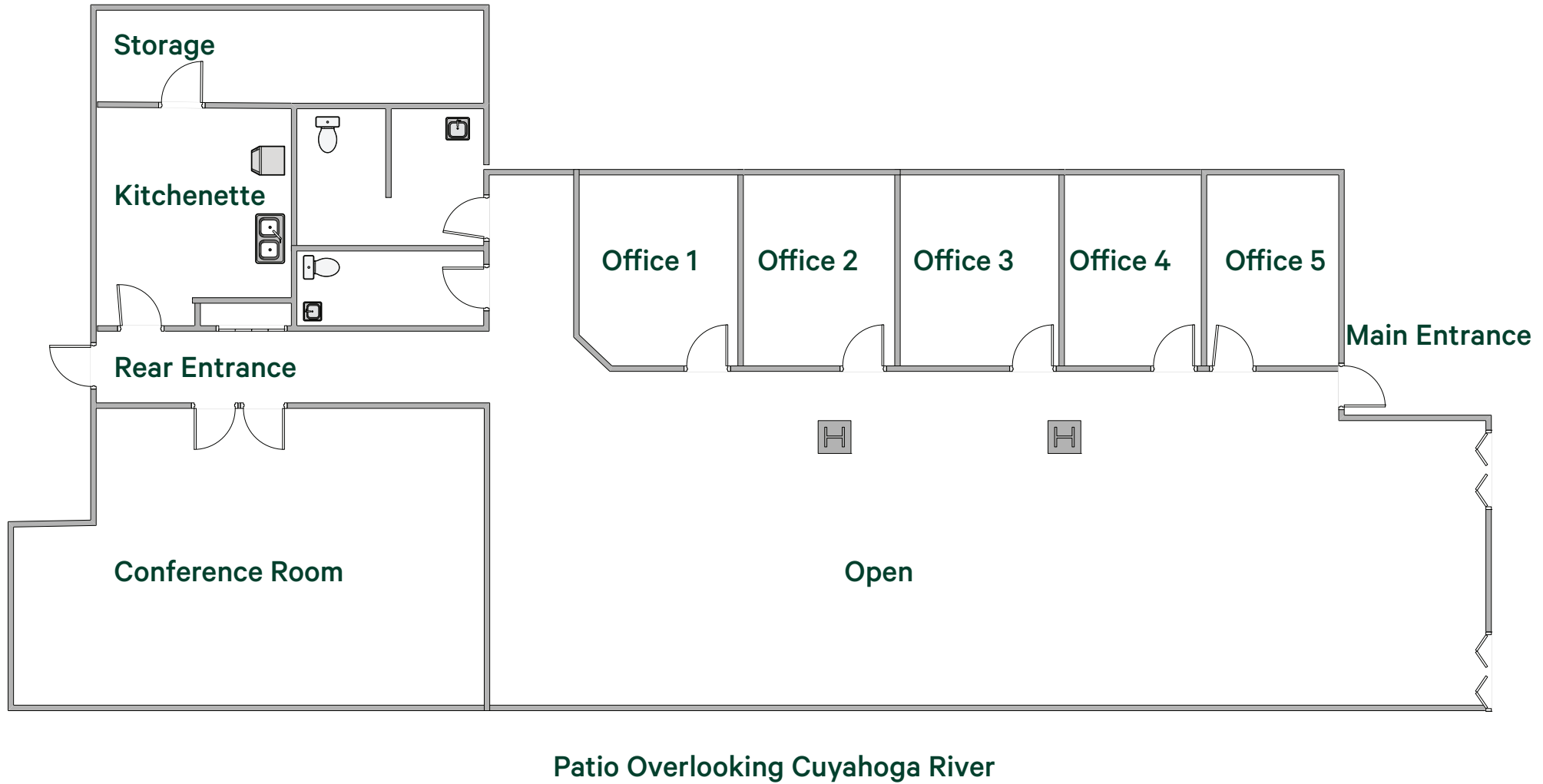

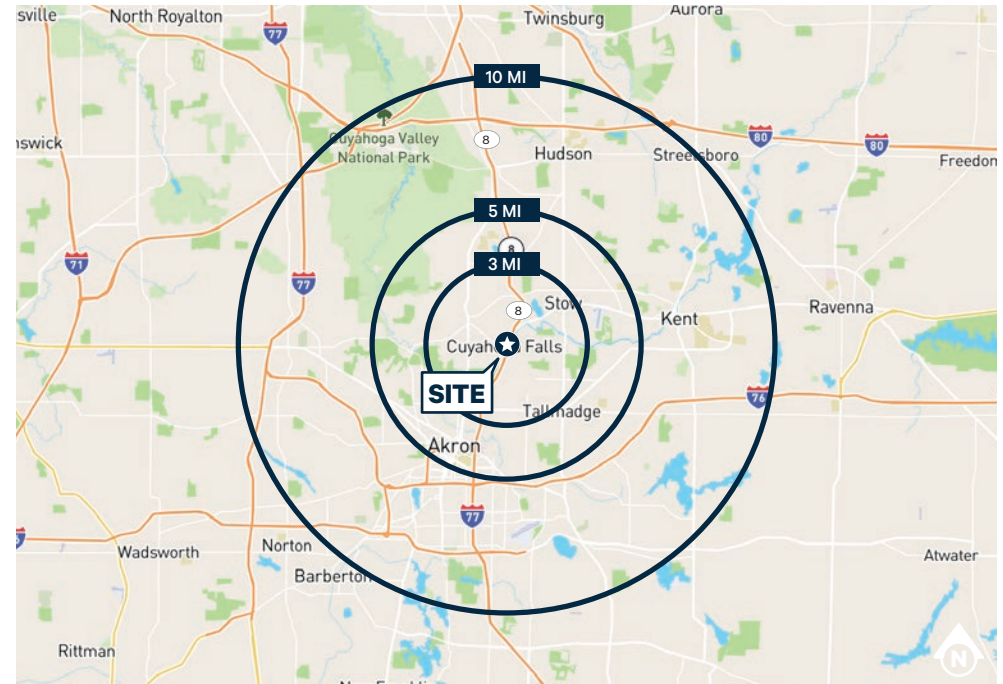
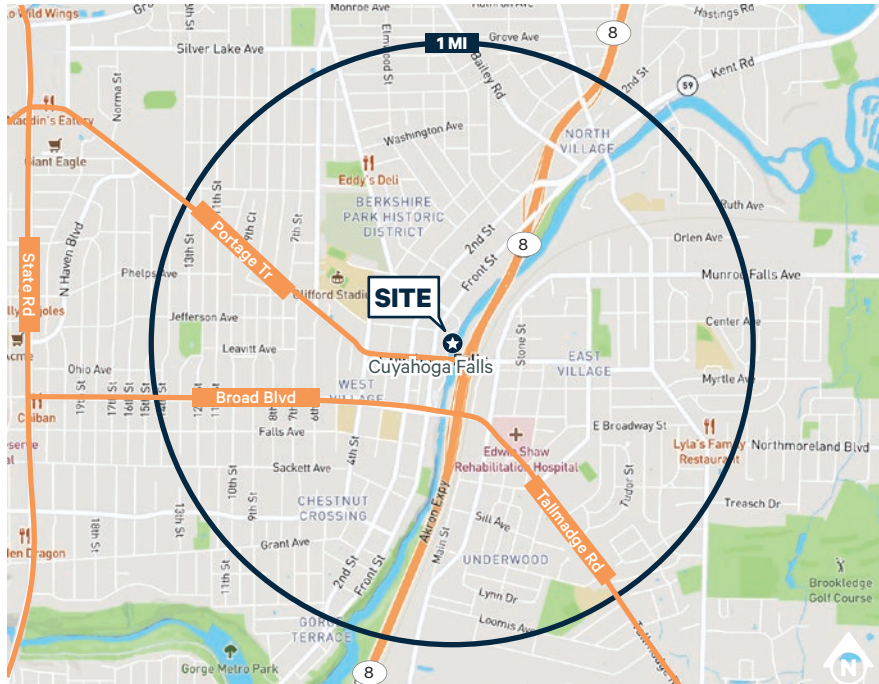

Contact Us

Steve Lazarides

First Vice President
+1 330 670 4410
steve.lazarides@cbre.com

Dean Bacopoulos

Vice President
+1 330 670 4405
dean.bacopoulos@cbre.com

Andy Flowers

Associate
+1 330 607 4411
andy.flowers@cbre.com

Demographics	1 Mile	3 Miles	5 Miles
2025 Total Population	17,141	84,664	186,722
2025 Total Businesses	565	2,782	7,029
2025 Total Employees	8,038	36,037	103,579
2025 Population 25 and Over	12,808	61,581	133,221
2025 Daytime Population	14,949	77,597	199,056

© 2026 CBRE, Inc. All rights reserved. This information has been obtained from sources believed reliable, but has not been verified for accuracy or completeness. You should conduct a careful, independent investigation of the property and verify all information. Any reliance on this information is solely at your own risk. CBRE and the CBRE logo are service marks of CBRE, Inc. All other marks displayed on this document are the property of their respective owners, and the use of such logos does not imply any affiliation with or endorsement of CBRE. Photos herein are the property of their respective owners. Use of these images without the express written consent of the owner is prohibited.