

**Bluff Plaza**  
2700 - 2716 28th Street, Boulder, CO

## Prime Retail Space for Lease in Bluff Plaza

**Michael-Ryan McCarty**  
mccarty@gibbonswhite.com  
(303) 586-5939

**Patrick Weeks**  
patrick@gibbonswhite.com  
(303) 586-5935

www.gibbonswhite.com

Property Info & Gallery

View Map

Suite	Size	Lease Rate / sq. ft.
2704	2,295 sq. ft.	\$21.00 NNN
2714	1,800 sq. ft.	\$21.00 NNN
Expenses / sq. ft.		\$13.52*

*\*Not Including Utilities*

- High Visibility Retail & Turn-Key Boutique Medical & Wellness Spaces in Central Boulder's Core Shopping District
- **Suite 2704** - Fully-Equipped, High-End Studio Space Optimized for Hot Yoga, Heated Fitness, Personal Training, CrossFit, Med-Spa, or Wellness Center: Versatile Main Studio with Retractable Acoustic Divider for Simultaneous Classes or Private Sessions, Professional Reception/Retail Lobby & Luxe Locker Rooms with Multiple Showers & Premium Finishes for an Elevated Member Experience
- **Suite 2714** - Former Chiropractic Clinic, Ideal for Specialized Medical Practice, Skincare Boutique, or Professional Services: Featuring a Bright, Open-Concept Treatment or Collaborative Floor Complemented by Two Dedicated Private Consultation Rooms, a Welcoming Reception Area & Functional Layout Designed for Seamless Patient Flow
- Incredible Parking Ratio over 5/1,000 sq. ft.
- Traffic Counts 35,534 Vehicles per Day on 28th Street

© 2026 Gibbons-White, Inc.

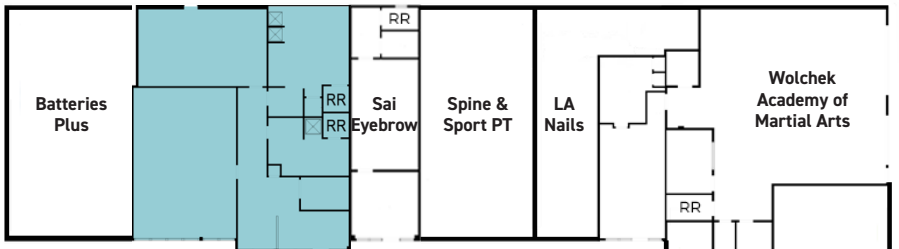

**Suite 2704**  
**2,295 sq. ft.**  
**\$6,602 / mo.**



**Suite 2714**  
**1,800 sq. ft.**  
**\$5,178 / mo.**



**SUITE 2704**



**SUITE 2704**



**SUITE 2714**



**SUITE 2714**