

Pauahi Tower

1003 Bishop St., Honolulu HI, 96813
SUITE 2410

AVAILABLE FOR **SUBLEASE**

PROPERTY INFO

AVAILABLE SPACE

1,176 RSF

TERM

April 30, 2026

BASE RENT

\$1.49/sq ft/month

CAM

\$1.74/sq ft/month



ABOUT THE PROPERTY

CLASS A OFFICE SPACE

- ✓ Sublease available in one of the most prestigious office complexes in downtown Honolulu
- ✓ Opportunity for a longer lease pending your needs.
[Inquire for more details](#)

FULLY BUILT OUT

- ✓ Includes 4 private offices and reception/open area with new flooring throughout
- ✓ Floor to ceiling windows in each office
- ✓ Double glass doors off of the elevator lobby
- ✓ Wetbar/Sink-in Unit

MEDICAL OFFICE OPPORTUNITY

- ✓ Bishop Square is one of the few properties in downtown that allows medical use
- ✓ Pauahi Tower is home to a number of medical providers throughout the building
- ✓ This space was previously used by a primary care practice, with 1 doctor's office, 3 exam rooms and a reception desk

VALIDATION SIGNING BONUS

- ✓ Nearly 100 hours of parking validation tickets will be included at no cost

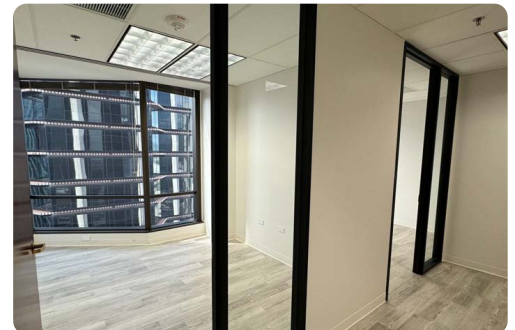

CONTACT

James M. Brown IV (B)

Tiare Brown (S)



CCIM SIOR, PRESIDENT
LIC# RB-17203
808-429-9757
JAMIE@HAWAIIICRE.COM

LIC# RS-85845
808-391-7717
TIARE@HAWAIIICRE.COM

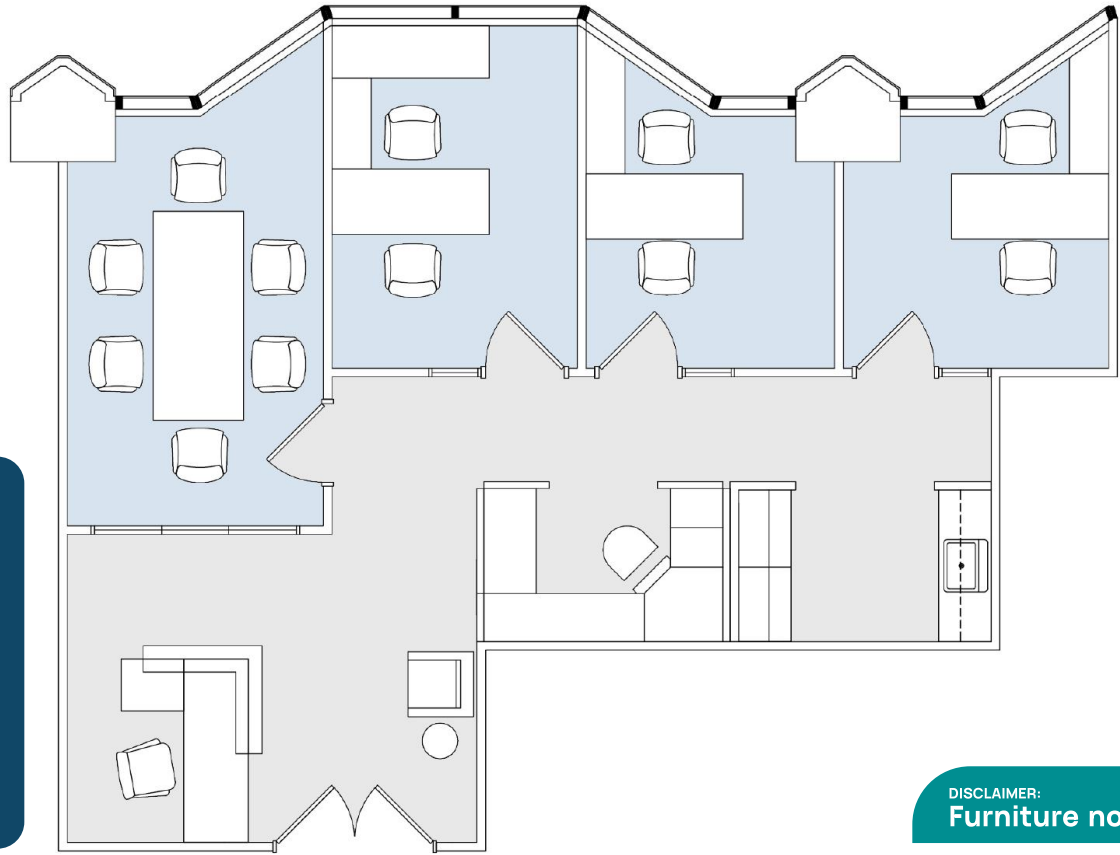

SUITE 2410

- ✓ 4 private offices
- ✓ Reception/ Open Area
- ✓ Wet bar/ Kitchenette

DISCLAIMER:
Furniture not included.



CONTACT

James M. Brown IV (B)

Tiare Brown (S)



CCIM SIOR, PRESIDENT
 LIC# RB-17203
 808-429-9757
JAMIE@HAWAIIICRE.COM

LIC# RS-85845
 808-391-7717
TIARE@HAWAIIICRE.COM