

CBRE

±12,145 SF

Free Standing Building with Secured Yard

For Lease



3449 E Broadway Rd

PHOENIX, AZ

Floorplan

3449 E Broadway Rd

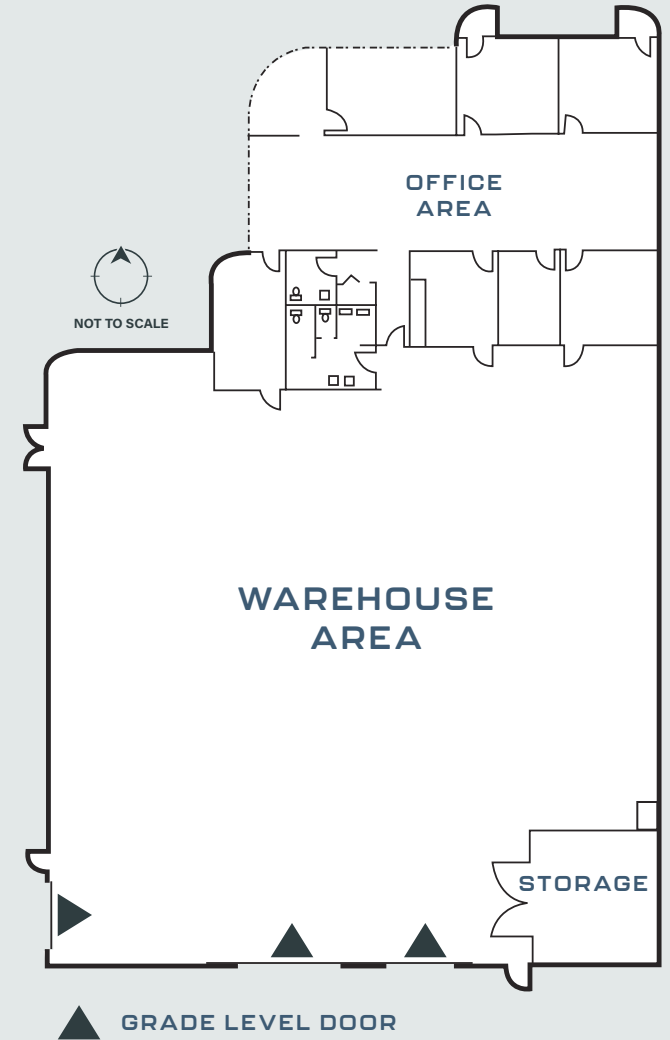

±12,145 SF Freestanding Building

Zoned CP/GCP, City of Phoenix

277/480 V, 3 Phase

±3,000 SF AC Office

Three (3) Grade-Level Doors (±8' x ±12')

EVAP Cooled & Heated Warehouse Area

±39,042 SF Site

One (1) Scissor Lift Dock-High Door

Frontage on Broadway Rd

Fenced Yard

Insulated Ceiling & Skylights

Full Diamond Interchange at I-10 via 32nd & 40th Streets



Property Highlights

Immediate Access

To 6 Major Freeway Systems

Centrally Located

to the Metro Phoenix Area

5th Largest Airport in the Nation

Adjacent Phoenix Sky Harbor International Airport

14,464 Businesses

Within a 5 Mile Radius

4 Minutes

To Interstate I-10/Highway 51

2 Minutes

To Interstate I-17

7 Minutes

To Sky Harbor International Airport

4 Minutes

To Highway 143

±12,145 SF FOR LEASE

3449 E Broadway Rd

PHOENIX, AZ

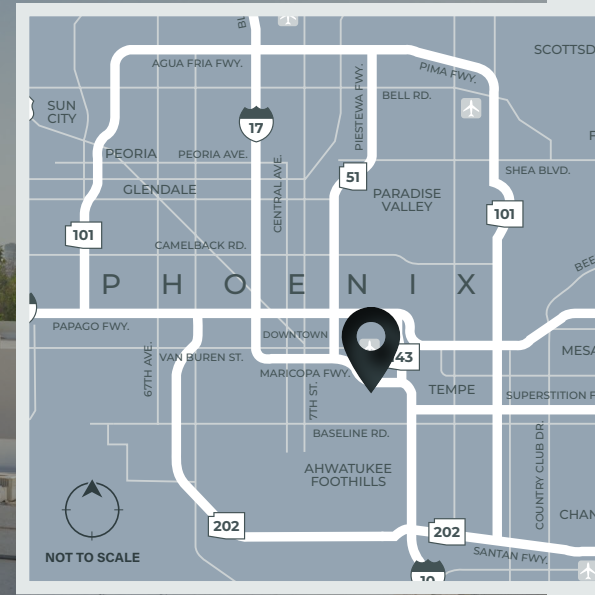

Pat Feeney, Jr.
Owner Agent
+1 602 538 3257
pat.feeney@cbre.com

Dan Calihan
Executive Vice President, SIOR
+1 602 617 1546
dan.calihan@cbre.com

Tyler Vowels
Senior Associate
+1 231 384 1079
tyler.vowels@cbre.com

CBRE

© 2025 CBRE, Inc. All rights reserved. This information has been obtained from sources believed reliable but has not been verified for accuracy or completeness. CBRE, Inc. makes no guarantee, representation or warranty and accepts no responsibility or liability as to the accuracy, completeness, or reliability of the information contained herein. You should conduct a careful, independent investigation of the property and verify all information. Any reliance on this information is solely at your own risk. CBRE and the CBRE logo are service marks of CBRE, Inc. All other marks displayed on this document are the property of their respective owners, and the use of such marks does not imply any affiliation with or endorsement of CBRE. Photos herein are the property of their respective owners. Use of these images without the express written consent of the owner is prohibited.