

29101-29501 JOHN R ROAD
MADISON HEIGHTS, MICHIGAN

RETAIL FOR SUBLEASE
300 – 10,647 Square Feet Available



**SIGNATURE
ASSOCIATES**
KNOW SIGNATURE | KNOW RESULTS

MADISON CENTER



PROPERTY FEATURES

- 300 – 10,647 square feet available
- Join BJ's Wholesale and Kim Nhung Superfood in this prime retail corner
- Zoned B-2
- 518 parking spaces
- 18' clear height
- Easy access to I-75 and I-696



For more information, please contact:

PETER VANDERKAAY
(248) 359 3837
pvanderkaay@signatureassociates.com

PAUL SAAD
(248) 359 0652
psaad@signatureassociates.com

SIGNATURE ASSOCIATES
One Towne Square, Suite 1200
Southfield, MI 48076
www.signatureassociates.com

29101-29501 John R. Road – Madison Heights, Michigan

Retail For Sublease

300 – 10,647
Square Feet
AVAILABLE

Site Plan

AVAILABILITY		
SUITE	TOTAL SF	RATE
A	485	\$19.00 MG
B	485	\$19.00 MG
C	1,150	\$19.00 MG
D	800	\$17.00 MG
E	800	\$15.00 MG
F	300	\$15.00 MG
G	7,597	\$15.00 NNN

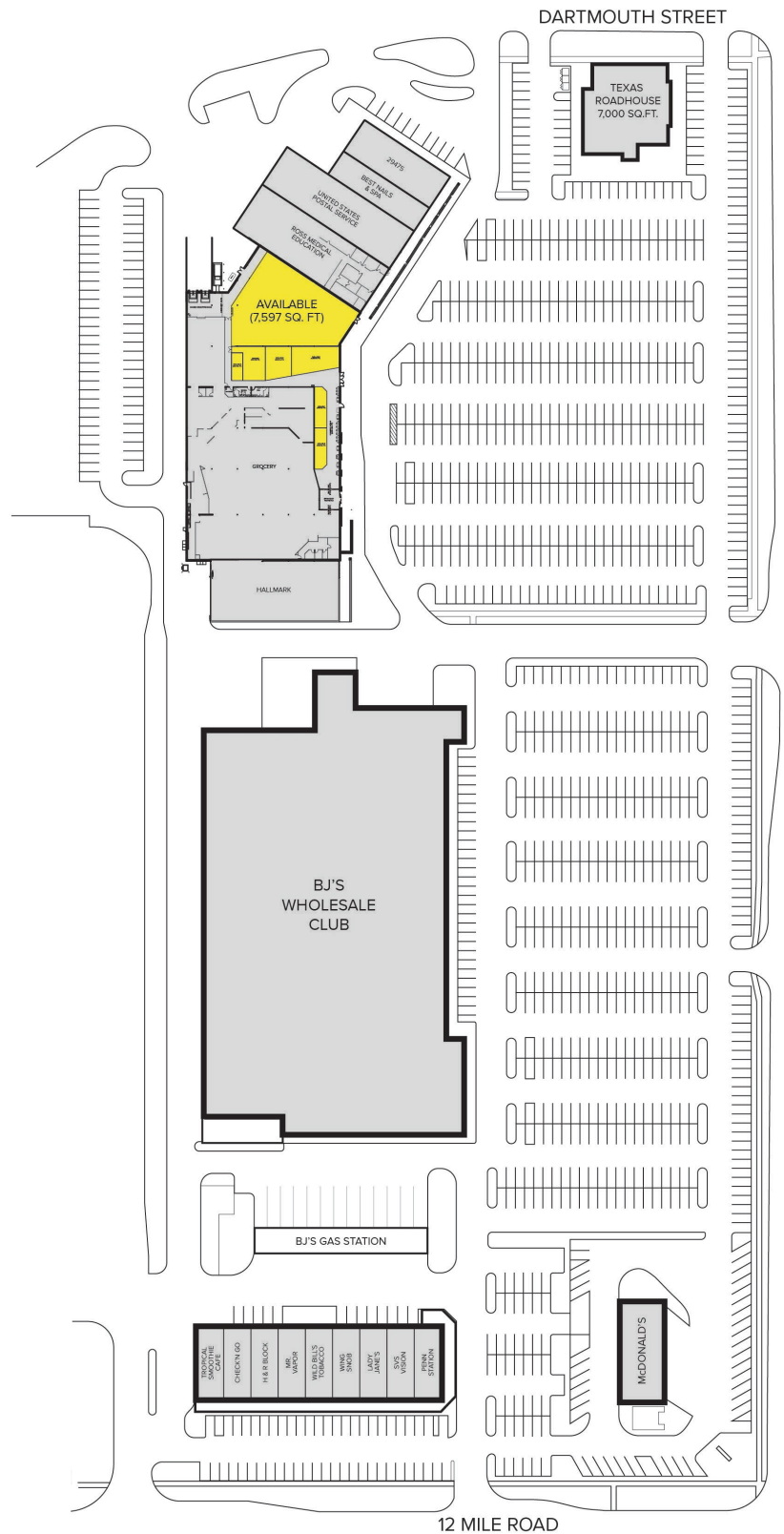

For more information, please contact:

PETER VANDERKAAY
(248) 359 3837
pvanderkaay@signatureassociates.com

PAUL SAAD
(248) 359 0652
psaad@signatureassociates.com

SIGNATURE ASSOCIATES
One Towne Square, Suite 1200
Southfield, MI 48076
www.signatureassociates.com

Floor Plan

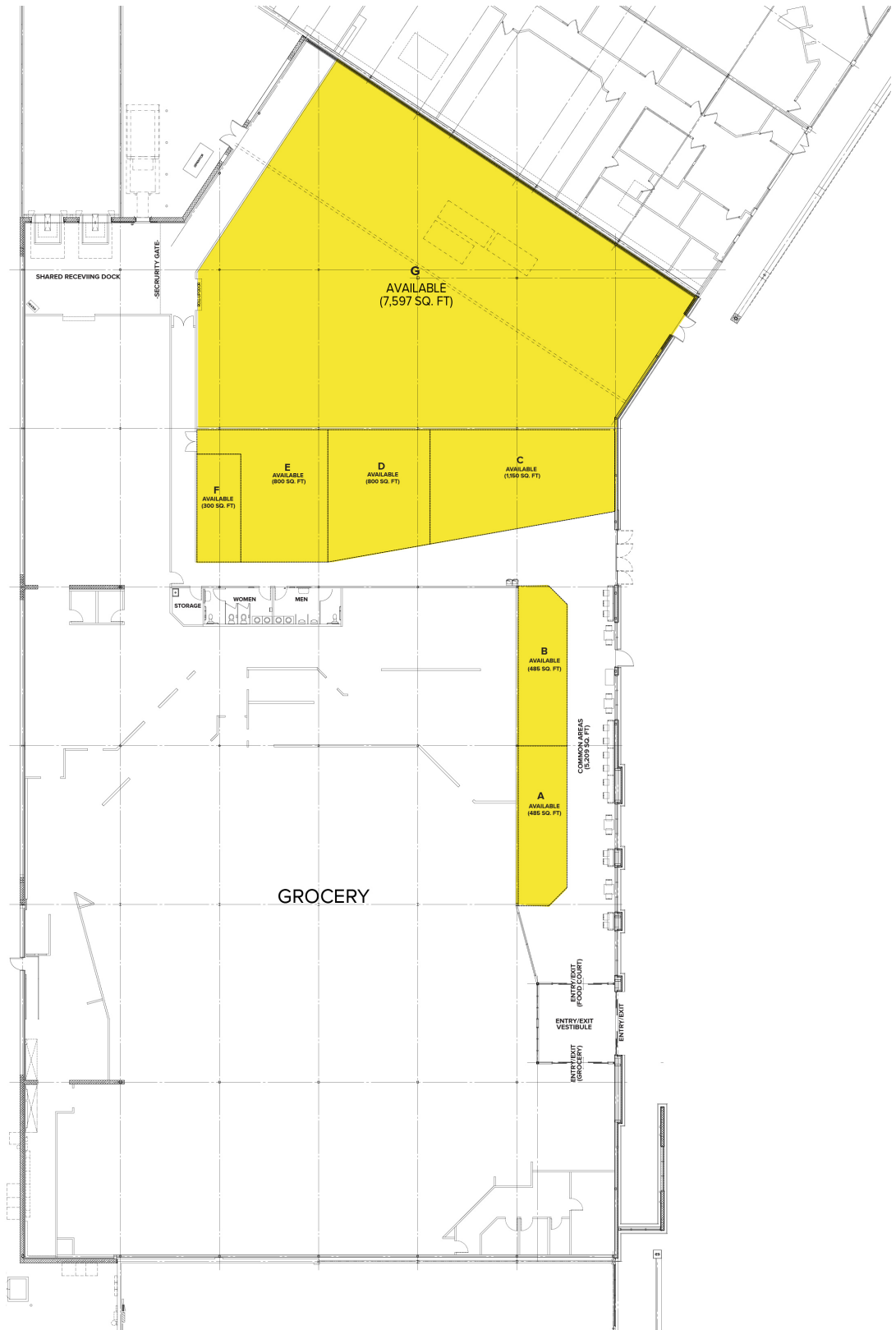

For more information, please contact:

PETER VANDERKAAY
(248) 359 3837
pvanderkaay@signatureassociates.com

PAUL SAAD
(248) 359 0652
psaad@signatureassociates.com

SIGNATURE ASSOCIATES
One Towne Square, Suite 1200
Southfield, MI 48076
www.signatureassociates.com

29101-29501 John R. Road – Madison Heights, Michigan

Retail For Sublease

300 – 10,647
Square Feet
AVAILABLE



DEMOGRAPHICS

	POPULATION	MED. HH INCOME
1 MILE	13,733	\$79,380
3 MILE	121,938	\$85,686
5 MILE	327,228	\$85,922

TRAFFIC COUNTS (TWO-WAY)

32,402	12 Mile Rd. E of John R Rd.
31,039	12 Mile Rd. W of John R Rd.
33,368	John R Rd. N of 12 Mile Rd.
33,075	John R Rd. S of 12 Mile Rd.

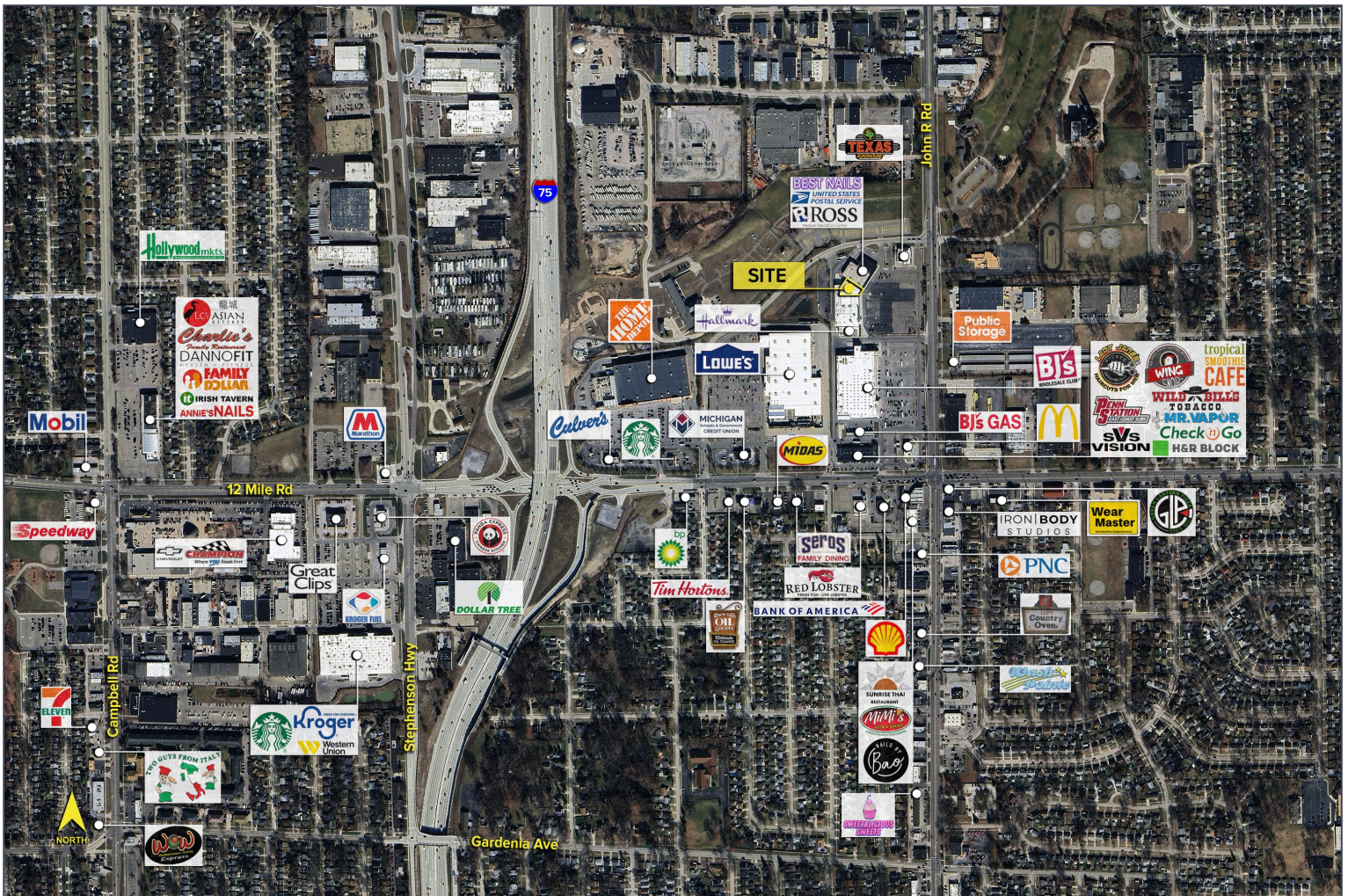

For more information, please contact:

PETER VANDERKAAY
(248) 359 3837
pvanderkaay@signatureassociates.com

PAUL SAAD
(248) 359 0652
psaad@signatureassociates.com

SIGNATURE ASSOCIATES
One Towne Square, Suite 1200
Southfield, MI 48076
www.signatureassociates.com