



**COLDWELL
BANKER
COMMERCIAL**
ELITE

FOR LEASE

RETAIL SHOPS AT FRED VEGAS

\$16.00 SF/yr (NNN)

4701 Plank Road
Fredericksburg, VA 22401

AVAILABLE SPACE
928 - 1,928 SF

AREA

- Located within Spotsylvania County's most densely populated housing hub
- Prime frontage and access on Plank Road/Route 3 with over 70,000 ADT approximately 1.8 miles from I-95

CBCWORLDWIDE.COM



OFFICE

Cameron Coleman
540.785.3368
ccoleman@coldwellbankerelite.com

Brian Cunningham, CCIM
540.429.3414
bcunningham@coldwellbankerelite.com

©2019 Coldwell Banker Real Estate LLC, dba Coldwell Banker Commercial Elite. All rights reserved. Coldwell Banker Commercial® and the Coldwell Banker Commercial logo are registered service marks owned by Coldwell Banker Real Estate LLC. Coldwell Banker Real Estate LLC, dba Coldwell Banker Commercial Affiliates fully supports the principles of the Fair Housing Act and the Equal Opportunity Act. Each office is independently owned and operated. The information provided is deemed reliable, but it is not guaranteed to be accurate or complete, and it should not be relied upon as such. This information should be independently verified before any person enters into a transaction based upon it.

**COLDWELL BANKER COMMERCIAL
ELITE**
1201 Central Park Boulevard, Fredericksburg, VA 22401
540.786.1402



RETAIL SHOPS AT FRED VEGAS

4701 Plank Road , Fredericksburg, VA 22401

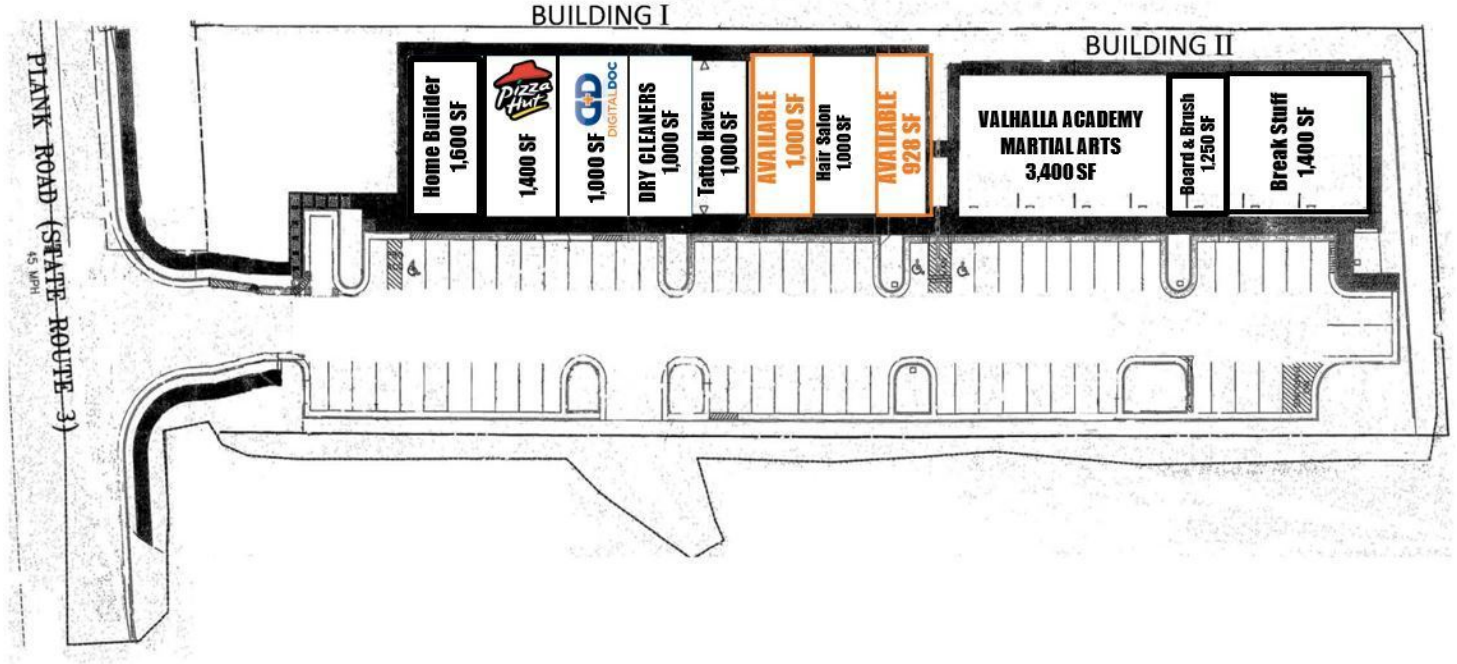

OFFERING SUMMARY

Available SF: 928 - 1,000 SF

Lease Rate: \$16.00 SF/yr (NNN)

Condition: Warm Lit Shell

Building Size: 15,000 SF

Zoning: C2

PROPERTY OVERVIEW

Two spaces left: 1000 sf and 928 sf!

Join Pizza Hut, Board & Brush, Martial Arts, Dry Cleaners and many other complimentary uses! Lowest Lease Rates for retail space on Fredericksburg's busiest retail corridor- Route 3/Plank Road. Each suite features floor to ceiling glass storefront with nose-in parking.

The shopping center is Located within Spotsylvania County's most densely populated housing hub. Prime frontage and access on Plank Road/Route 3 with over 70,000 ADT approximately 1.8 miles from I-95.

PROPERTY HIGHLIGHTS

DEMOGRAPHICS

	1 MILE	3 MILES	5 MILES
Total Households	3,780	18,033	34,422
Total Population	10,765	48,004	93,789
Average HH Income	\$86,202	\$78,754	\$82,115

CBCWORLDWIDE.COM

Cameron Coleman
540.785.3368
ccoleman@coldwellbankerelite.com

Brian Cunningham, CCIM
540.429.3414
bcunningham@coldwellbankerelite.com



**COLDWELL
BANKER
COMMERCIAL**

ELITE



RETAIL SHOPS AT FRED VEGAS

4701 Plank Road , Fredericksburg, VA 22401

LEASE



CBCWORLDWIDE.COM

Cameron Coleman
 540.785.3368
 ccoleman@coldwellbankerelite.com

Brian Cunningham, CCIM
 540.429.3414
 bcunningham@coldwellbankerelite.com



**COLDWELL
 BANKER
 COMMERCIAL**

ELITE