

TURN-KEY FURNISHED SUBLEASE IN HARBOR POINT

# 333

## LUDLOW STREET

STAMFORD, CONN.



NEWMARK



# HARBOR POINT LIVE. WORK. PLAY.



2+

Miles of  
waterfront  
boardwalk

4

Marinas



15+

Restaurants

20+

Acres of actively pro-  
grammed parks



4K+

Apartments



HARBOR  
POINT



Contact Exclusive Broker:

TOREY WALSH 203.531.3633 | torey.walsh@nmrk.com

NEWMARK



# FULL FLOOR OR PARTIAL OPPORTUNITY



## HIGHLIGHTS

- Full-service Cafeteria
- Fitness Center with Showers and Locker Room
- Security Concierge
- Multi-Media Conference Facility
- Parking Garage 3/1,000 RSF
- Fully Renovated Lobby and Common Areas
- Landscaped Patio and Outdoor Seating
- Waterfront Location with Marina Views
- Private Shuttle Service to/from Train Station
- 5 Minutes from I-95, Exits 7 and 8

## SPECIFICATIONS

Available	Partial 4 <sup>th</sup>	12,307 SF
Asking Rent	Upon Request	
Possession	Immediate	
Term	Through May 30, 2026	



# OFFICE SPACE





# FLOOR PLAN 4<sup>TH</sup> FLOOR

FULL FLOOR OR PARTIAL

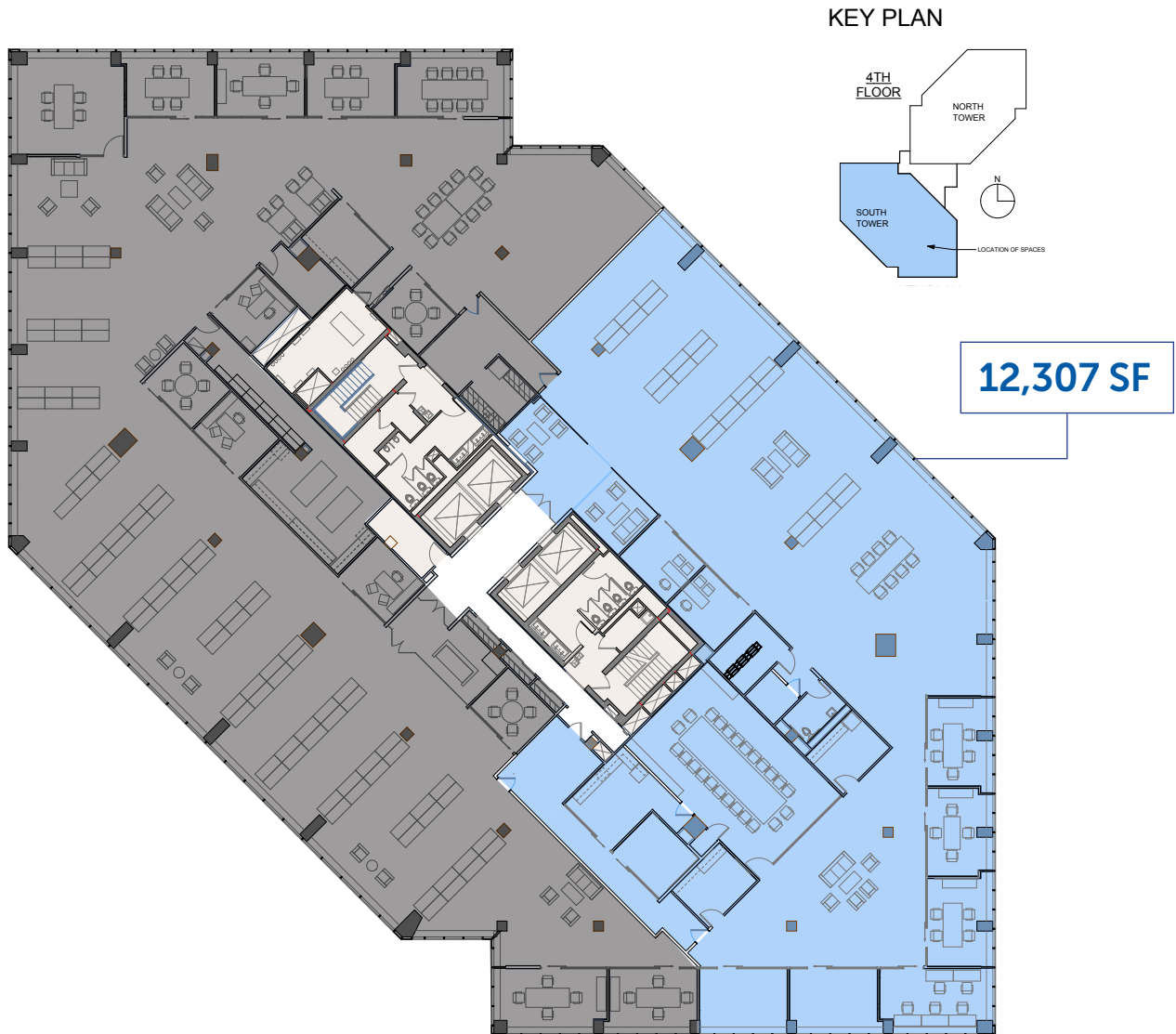

Contact Exclusive Broker:

TOREY WALSH 203.531.3633 | torey.walsh@nmrk.com

NEWMARK