

Office For Lease



Midtown Manhattan  
Office For Assigned Lease

---

6,541 SF | FL 9

\$53 psf

• •  
• •

Steve Zhu

# Suite 909, 261 Fifth Ave, Manhattan

**6,541 sf****\$53**

Office Size

Rent psf

**\$28,887.17****2%**

Current Rent

Escalation



Asking Price  
**\$53/sf/year**



## Property Description

This is an assigned lease for 261 Fifth Ave located in Midtown Manhattan. Rent is currently \$28887.17 and will increase at 2% on a yearly basis.

Tenant is responsible for electricity and waste disposal, the latter of which is around \$75/month. Office is equipped with microwave oven and air conditioning. Water is paid by landlord, while air conditioning maintenance is covered by tenant. Tax is covered by tenant and is around \$2000 depending on the invoice/document sent to landlord by the building management.

Remaining lease is until end of March 2021, with possible renewal with the building management.



## Property Information

LOCATION	261 Fifth Ave, Midtown Manhattan
BLOCK / LOT	858-78
LOT SIZE	15,849 SF
CURRENT MONTHLY RENT	\$28,887.17
RENT YEARLY INCREASE	2%
CURRENT RENT PER SF	\$53/year
TAX	\$2,000

• • **Steve Zhu**  
 • • Vice President, Compass  
 • • Commercial Division  
 • • 917.569.8850  
 • • [steve.zhu@compass.com](mailto:steve.zhu@compass.com)

# Suite 909, 261 Fifth Ave, Manhattan

## Floor Plan

EXHIBIT "C"

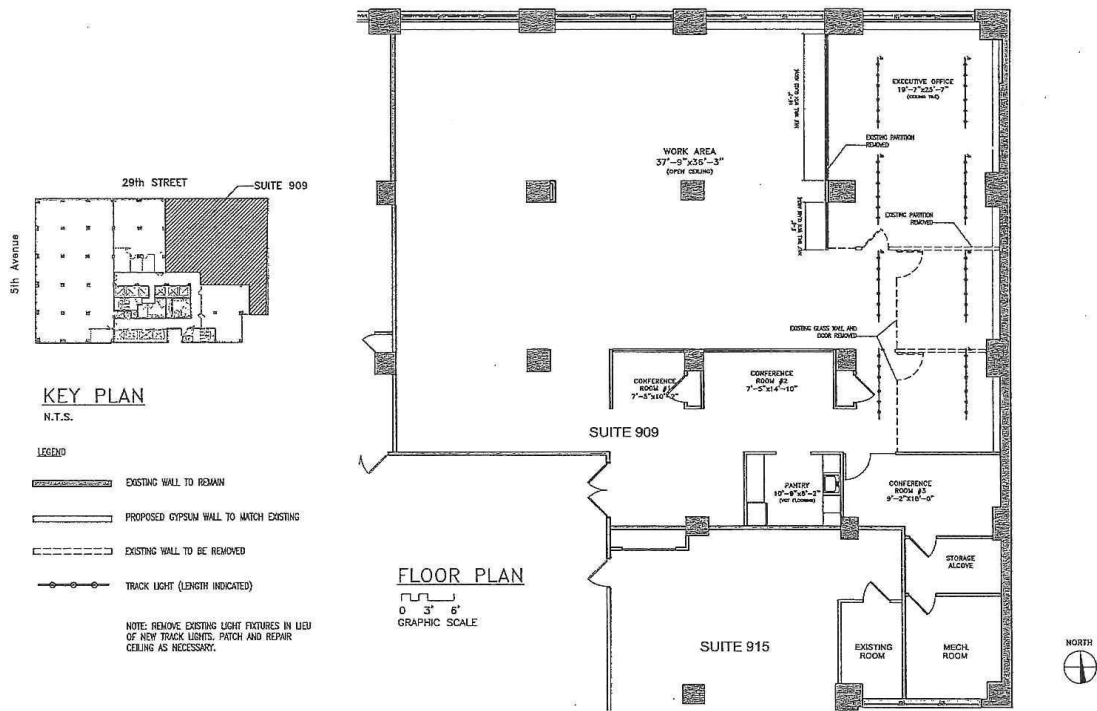

THE FEIL ORGANIZATION

Rob Fisher  
 212-609-8649  
 rfisher@feilorg.com  
 REVISION #6 12/15/14

• • **Steve Zhu**  
 • • Vice President, Compass  
 • • Commercial Division  
 • • 917.569.8850  
 • • [steve.zhu@compass.com](mailto:steve.zhu@compass.com)

Compass is a licensed real estate broker and abides by Equal Housing Opportunity laws. All material presented herein is intended for informational purposes only. Information is compiled from sources deemed reliable but is subject to errors, omissions, changes in price, condition, sale, or withdraw without notice. No statement is made as to accuracy of any description. All measurements and square footages are approximate. Exact dimensions can be obtained by retaining the services of an architect or engineer. This is not intended to solicit property already listed.

DISCLAIMER

Although information has been obtained from sources deemed reliable, neither Owner nor Compass makes any guarantees, warranties or representations, express or implied, as to the completeness or accuracy as to the information contained herein. Any projections, opinions, assumptions or estimates used are for example only. There may be differences between projected and actual results, and those differences may be material. The Property may be withdrawn without notice. Neither Owner nor Compass accept any liability for any loss or damage suffered by any party resulting from reliance on this information. If the recipient of this information has signed a confidentiality agreement regarding this matter, this information is subject to the terms of that agreement. ©2019 Compass, Inc. All rights reserved.