

# 302-304 ALABAMA ST

AUBURN, AL 36832

## Executive Summary



### OFFERING SUMMARY

Available SF: ± 7,900 SF

Lease Rate: Contact Agent

Lot Size: ± 4.59 Acres

Year Built: 1998

Building Size: ±18,450

Zoning: Industrial

### PROPERTY HIGHLIGHTS

- Rare Flex-Warehouse in Auburn, AL!
- (1) 15x12 Roll Up Doors, (2) 12x8 Roll Up Doors
- Part of a Condo Park with shared parking
- Located near two major thoroughfares- Shug Jordan Pkwy (Traffic Counts of ± 22,557 AADT) & AL Highway 14 (Traffic Counts of ± 11,776 AADT)
- ± 2.4 Miles from Auburn University- With an enrollment of 28,290 Students & 5,500 Employees, it's one of the largest Universities in the South
- ± 3.5 Miles from I-85 (± 46,017 AADT)
- ± 9.5 Miles from Auburn Regional Airport



**GENE CODY, CCIM, SIOR**

334.386.2441  
gcody@mcrmpm.com

**PERRY PATIÑO**

334.531.0125  
ppatino@mcrmpm.com

**MOORE COMPANY REALTY**

312 Catoma St #200, Montgomery, AL 36104  
334.262.1958 | moorecompanyrealty.com





# 302-304 ALABAMA ST

AUBURN, AL 36832

# Additional Photos



**GENE CODY, CCIM, SIOR**

334.386.2441  
gcody@mcrmpm.com

**PERRY PATIÑO**

334.531.0125  
ppatino@mcrmpm.com

**MOORE COMPANY REALTY**

312 Catoma St #200, Montgomery, AL 36104  
334.262.1958 | moorecompanyrealty.com



# 302-304 ALABAMA ST

AUBURN, AL 36832

## Available Space

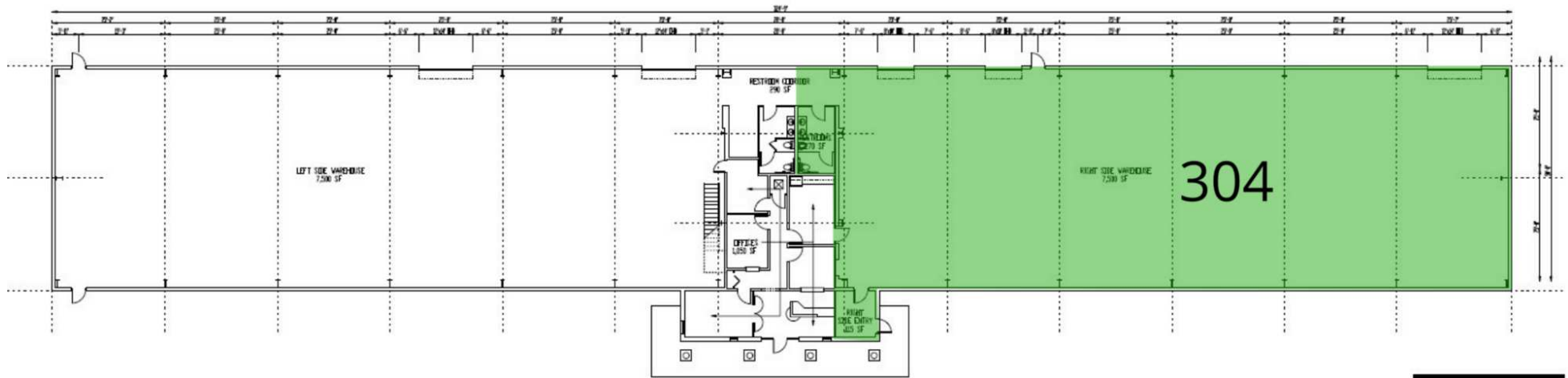

### LEGEND

Available

### AVAILABLE SPACES

SUITE	TENANT	SIZE	TYPE	RATE
304 Alabama St	Available	7,900 SF	Negotiable	Contact Agent

**GENE CODY, CCIM, SIOR**

334.386.2441  
gcody@mcrmpm.com

**PERRY PATIÑO**

334.531.0125  
ppatino@mcrmpm.com

**MOORE COMPANY REALTY**

312 Catoma St #200, Montgomery, AL 36104  
334.262.1958 | moorecompanyrealty.com





# 302-304 ALABAMA ST

AUBURN, AL 36832

## Retail Map



GENE CODY, CCIM, SIOR

334.386.2441  
gcody@mcrmpm.com

PERRY PATIÑO

334.531.0125  
ppatino@mcrmpm.com

MOORE COMPANY REALTY

312 Catoma St #200, Montgomery, AL 36104  
334.262.1958 | moorecompanyrealty.com

