



2051 E. Maple Ave

El Segundo, CA 90245

Excellent Value Add Opportunity



Executive Summary

Colliers Industrial Capital Markets, as exclusive advisor, is pleased to introduce to the market 2051 E. Maple Avenue (the “Property”) located in the prized El Segundo submarket of Los Angeles. The Property is an existing manufacturing building totaling 32,081 square feet situated on 1.2 acres and is being offered on a fee simple basis.



Property Overview



Total SF
32,081



Office SF
7,200



Clear Height
14'



Power
1600 Amps



Loading Dock
4 DH | 1 GL



Sprinklers
Yes



Parking
34



Location
<1 Mile from
I405/I-105

Site Plan

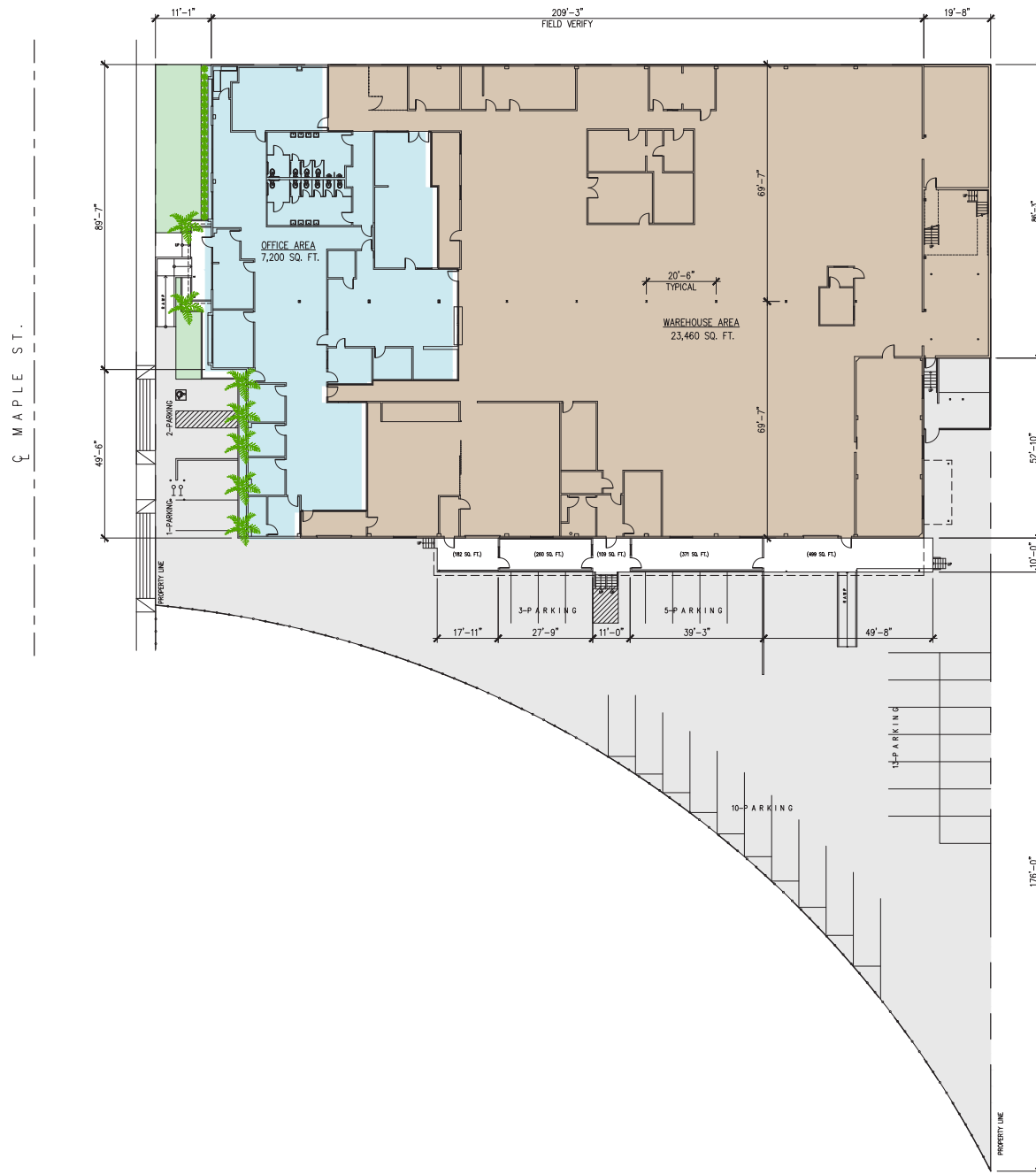

EXISTING SITE PLAN

SCALE: 1/16" = 1'-0"



Corporate Neighbors



2051 E. Maple Ave

El Segundo, CA 90245



Excellent Value Add Opportunity

Capital Markets Advisors

Michael Kendall

Lic. 01895979
+1 949 677 5812
michael.kendall@colliers.com

Gian Bruno

Lic. 01936831
+1 949 724 5511
gian.bruno@colliers.com

Kenny Patricia

Lic. 01999969
+1 949 724 5521
kenny.patricia@colliers.com

South Bay Market Experts

Jeff Smart

Lic. 00918873
+1 310 321 1812
jeffrey.smart@colliers.com

Elizabeth Capati

Lic. 02109628
+1 310 321 1855
elizabeth.capati@colliers.com

Debt Expert

Jason Roth

Senior Vice President
+1 310 622 1913
jason.roth@colliers.com