

# FOR SALE

1934 NE BROADWAY ST, PORTLAND, OR 97232



## PROPERTY DESCRIPTION

The thriving NE Broadway corridor is a magnet for Irvington, Grant Park, Laurelhurst, and Lloyd District residents seeking professional services, office, and shopping opportunities. It is home to signature restaurants/bars, retailers, and medical, financial, and personal service providers. It is connected to Downtown Portland by the Broadway Bridge and directly linked to I-84, I-5, MAX light rail, and several TriMet bus lines. NE Broadway has continued to prosper in spite of uneven economic conditions and historically has been a vital part of the City's cultural life.

## PROPERTY HIGHLIGHTS

- Great visibility
- 5 space parking lot
- ADA accessible (ramp accessible directly from parking lot)
- New HVAC
- 8 offices, 3 restrooms

## OFFERING SUMMARY

Sale Price:	\$1,050,000
Number of Units:	1
Lot Size:	4,497 SF
Building Size:	2,718 SF

DEMOGRAPHICS	0.3 MILES	0.5 MILES	1 MILE
Total Households	1,863	4,489	14,984
Total Population	3,368	8,457	29,434
Average HH Income	\$118,691	\$135,408	\$143,256

## STEVE HAGAN

director  
licensed in oregon  
c: 503.490.4152  
o: 503.222.5100  
shagan@dougbear.com

Doug Bean & Associates, Inc. | 1200 NW Naito Parkway #180 | Portland, OR 97209

[DOUGBEAN.COM](http://DOUGBEAN.COM)

Information contained herein has been obtained from others and is considered to be reliable. However, a prospective purchaser or lessee is expected to verify all information to their own satisfaction.





# FOR SALE

1934 NE BROADWAY ST, PORTLAND, OR 97232



## STEVE HAGAN

director

licensed in oregon

c: 503.490.4152

o: 503.222.5100

shagan@dougbear.com

**Doug Bean & Associates, Inc. | 1200 NW Naito Parkway #180 | Portland, OR 97209**

**DOUGBEAN.COM**

*Information contained herein has been obtained from others and is considered to be reliable. However, a prospective purchaser or lessee is expected to verify all information to their own satisfaction.*





---

# FOR SALE

1934 NE BROADWAY ST, PORTLAND, OR 97232



---

## STEVE HAGAN

director  
licensed in oregon  
c: 503.490.4152  
o: 503.222.5100  
shagan@dougbean.com

Doug Bean & Associates, Inc. | 1200 NW Naito Parkway #180 | Portland, OR 97209

[DOUGBEAN.COM](http://DOUGBEAN.COM)

*Information contained herein has been obtained from others and is considered to be reliable. However, a prospective purchaser or lessee is expected to verify all information to their own satisfaction.*





---

# FOR SALE

1934 NE BROADWAY ST, PORTLAND, OR 97232



---

## STEVE HAGAN

director  
licensed in oregon  
c: 503.490.4152  
o: 503.222.5100  
shagan@dougbear.com

Doug Bean & Associates, Inc. | 1200 NW Naito Parkway #180 | Portland, OR 97209

[DOUGBEAN.COM](http://DOUGBEAN.COM)

*Information contained herein has been obtained from others and is considered to be reliable. However, a prospective purchaser or lessee is expected to verify all information to their own satisfaction.*



# Site Plan

1934 NE BROADWAY ST, PORTLAND, OR 97232

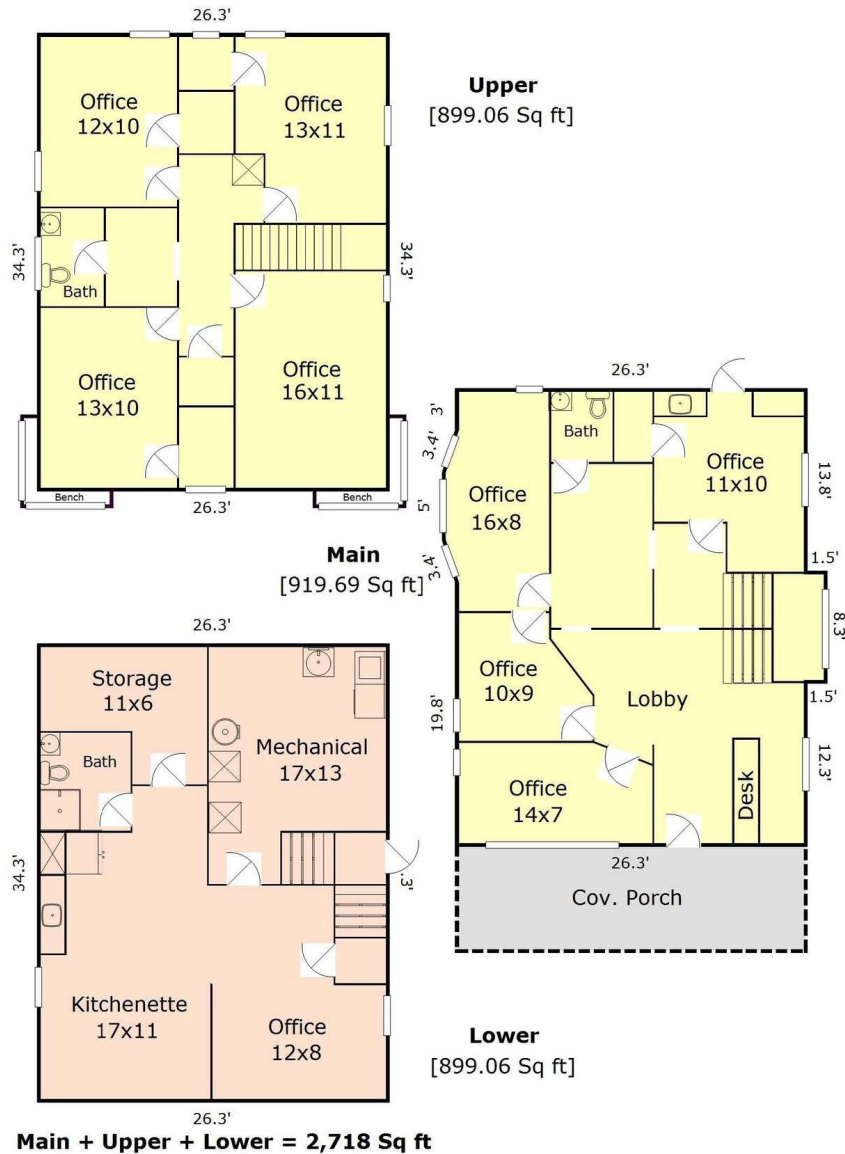

## STEVE HAGAN

director  
licensed in oregon  
c: 503.490.4152  
o: 503.222.5100  
shagan@dougbear.com

Doug Bean & Associates, Inc. | 1200 NW Naito Parkway #180 | Portland, OR 97209

[DOUGBEAN.COM](http://DOUGBEAN.COM)

Information contained herein has been obtained from others and is considered to be reliable. However, a prospective purchaser or lessee is expected to verify all information to their own satisfaction.



# FOR SALE

1934 NE BROADWAY ST, PORTLAND, OR 97232

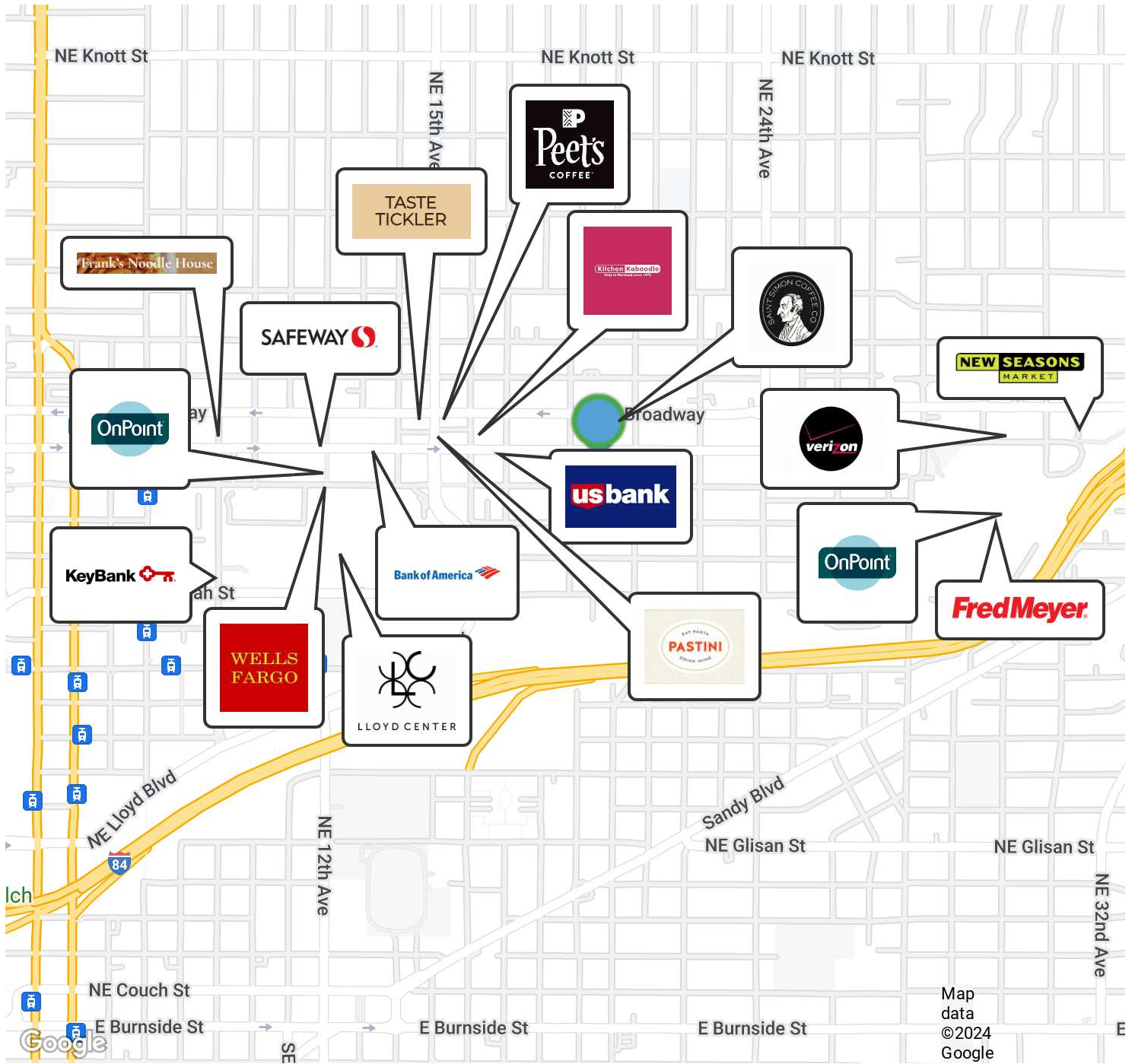

## STEVE HAGAN

director  
licensed in oregon  
c: 503.490.4152  
o: 503.222.5100  
shagan@dougbean.com

Doug Bean & Associates, Inc. | 1200 NW Naito Parkway #180 | Portland, OR 97209

[DOUGBEAN.COM](http://DOUGBEAN.COM)

Information contained herein has been obtained from others and is considered to be reliable. However, a prospective purchaser or lessee is expected to verify all information to their own satisfaction.





# Demographics Map & Report

1934 NE BROADWAY ST, PORTLAND, OR 97232

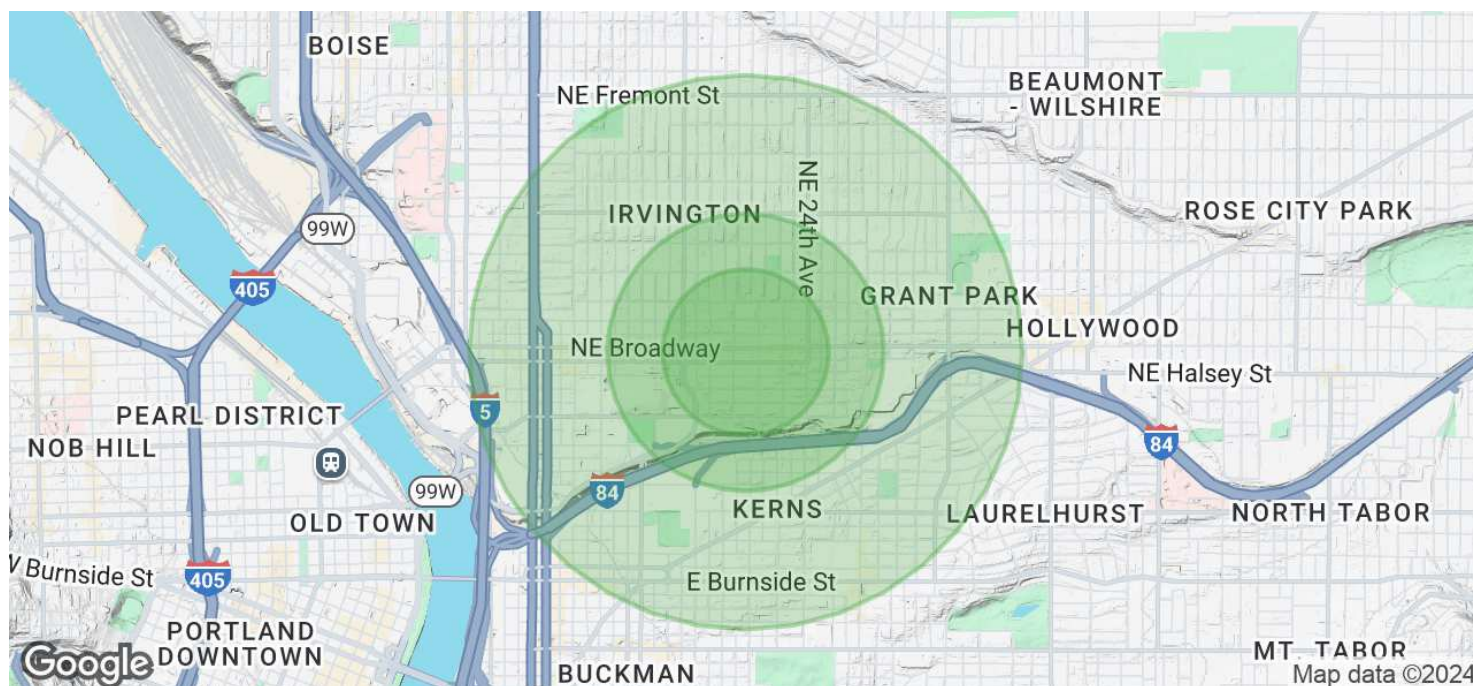

POPULATION	0.3 MILES	0.5 MILES	1 MILE
Total Population	3,368	8,457	29,434
Average Age	45	43	42
Average Age (Male)	44	43	41
Average Age (Female)	46	44	42

HOUSEHOLDS & INCOME	0.3 MILES	0.5 MILES	1 MILE
Total Households	1,863	4,489	14,984
# of Persons per HH	1.8	1.9	2
Average HH Income	\$118,691	\$135,408	\$143,256
Average House Value	\$799,121	\$852,776	\$829,082

Demographics data derived from AlphaMap

## STEVE HAGAN

director  
 licensed in oregon  
 c: 503.490.4152  
 o: 503.222.5100  
 shagan@dougbean.com

Doug Bean & Associates, Inc. | 1200 NW Naito Parkway #180 | Portland, OR 97209

[DOUGBEAN.COM](http://DOUGBEAN.COM)



Information contained herein has been obtained from others and is considered to be reliable. However, a prospective purchaser or lessee is expected to verify all information to their own satisfaction.