

# BUTTERWORTH LOFTS

2 spaces  
available!

# RETAIL SPACE FOR LEASE!

**245 E. BROADWAY  
HOPEWELL, VA. 23860**

FOR MORE INFORMATION, PLEASE CONTACT  
**Leo Chappell**  
COMMERCIAL MANAGER  
(O): 804.612.0326  
(M): 804.489.0062  
[LCHAPPELL@LEGENDPROPERTYGROUP.COM](mailto:LCHAPPELL@LEGENDPROPERTYGROUP.COM)



**LEGEND**  
PROPERTY GROUP

**1425 E. CARY ST. RICHMOND, VA. 23219**

**[WWW.LEGENDPROPERTYGROUP.COM/COMMERCIAL](http://WWW.LEGENDPROPERTYGROUP.COM/COMMERCIAL)**

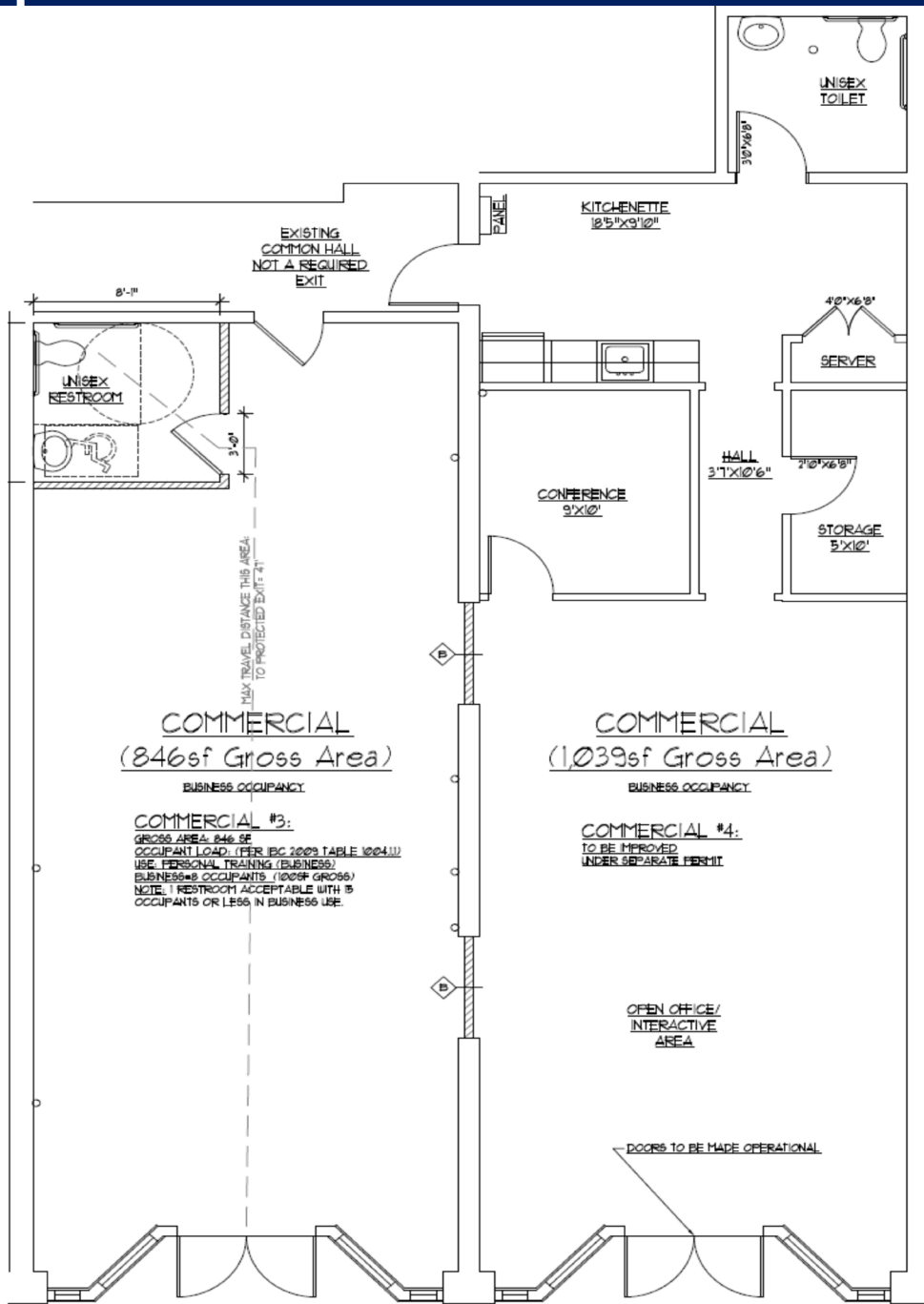

## PROPERTY OVERVIEW

- MIXED USE BUILDING
- HOME TO 24 APARTMENTS
- NEIGHBORING TENANTS:
  - WONDER CITY BAKERY
  - FAST KATZ BARBERSHOP

## PROPERTY FEATURES

- BEAUTIFULLY RENOVATED CREATIVE OFFICE/RETAIL SPACE
- HIGH CEILINGS
- GREAT STOREFRONT
- FLEXIBLE OPEN FLOORPLANS
- EXCELLENT VISIBILITY AND UNMATCHED WALKABILITY

## AVAILABLE UNITS

- UNIT 3: 846 SF
- UNIT 4: 1,039 SF

## Existing Businesses/Development

- 1) Wonder City Bakery
- 2) Fast Katz Barbershop
- 3) The Boathouse at City Point
- 4) John Randolph Medical Center
- 5) Roja Taco Joint
- 6) Leones Italian Restaurant
- 7) La Bodega
- 8) Hopewell Farmer's Market
- 9) The Beacon Theatre
- 10) City Point Place Apartments
- 11) You've got a deal (retail)
- 12) Sushi-Y
- 13) Sova Yoga

