

FOR LEASE

2,358 SF – 3,840 SF



INDUSTRIAL FLEX

601 SALIDA WAY,
AURORA, CO 80011

Ilya Klein
303-242-2077
ilya@novelcommercial.com

*Novel*Commercial
501 S Cherry Street Suite 1100
Denver, CO 80246

LEASE OVERVIEW

✓ Industrial Flex Warehouse

Unit B2: 3,840 SF (2 Dock-High Doors)

Unit B7: 2,358 SF (1 Drive-In Door)

✓ 15' Clear Height

✓ Climate Controlled (HVAC) Warehouse

✓ 3-Phase Electrical Power

✓ Private Restroom in Each Unit

✓ Ample Parking

✓ Signage Available

✓ Easy Access to I-225 and I-70



STARTING RENT

\$11.95/SF NNN

UNITS

2

CLEAR HEIGHT

15'

ZONING

M-1

CAM/SF

\$6.00

IMPORTANT: The information contained herein (on this page and included pages) has been obtained through sources deemed reliable but cannot be guaranteed or relied upon as to its accuracy. Any information should be verified through independent sources by interested parties. All measurements and calculations are approximate. The property may no longer be available for sale or lease, may be withdrawn, its offering price changed, or sold or leased to another party at anytime and without notice. NOTE: Ilya Klein, who is Broker of Novel Commercial, is also president of the company who is the seller or lessor. Please do not provide any information deemed private or confidential.

*Novel*Commercial

Unit B2

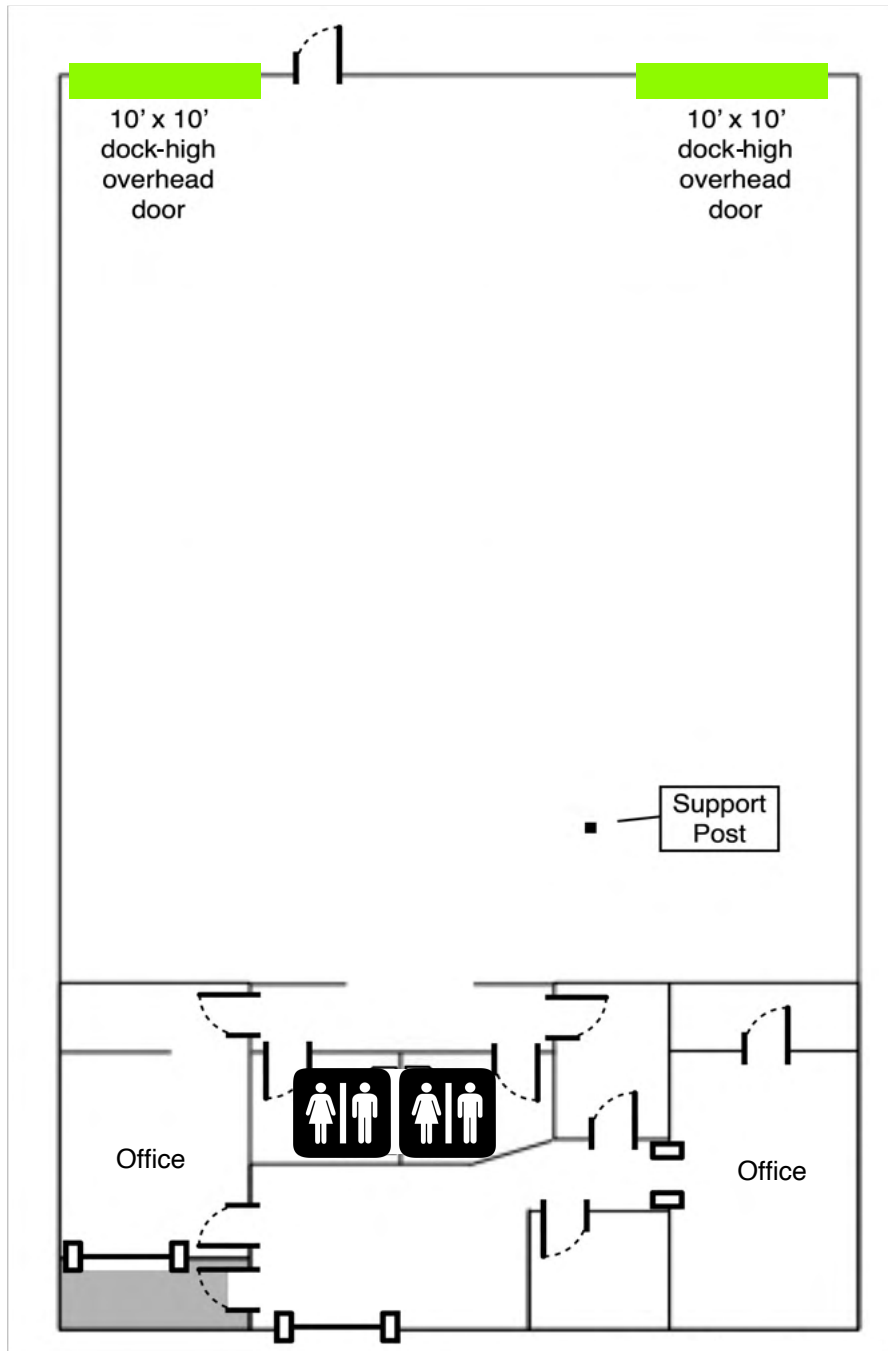

- 2,770 SF - Warehouse
 - 1,070 SF - Office
-
- 3,840 SF TOTAL

\$11.95/SF NNN

Unit B7

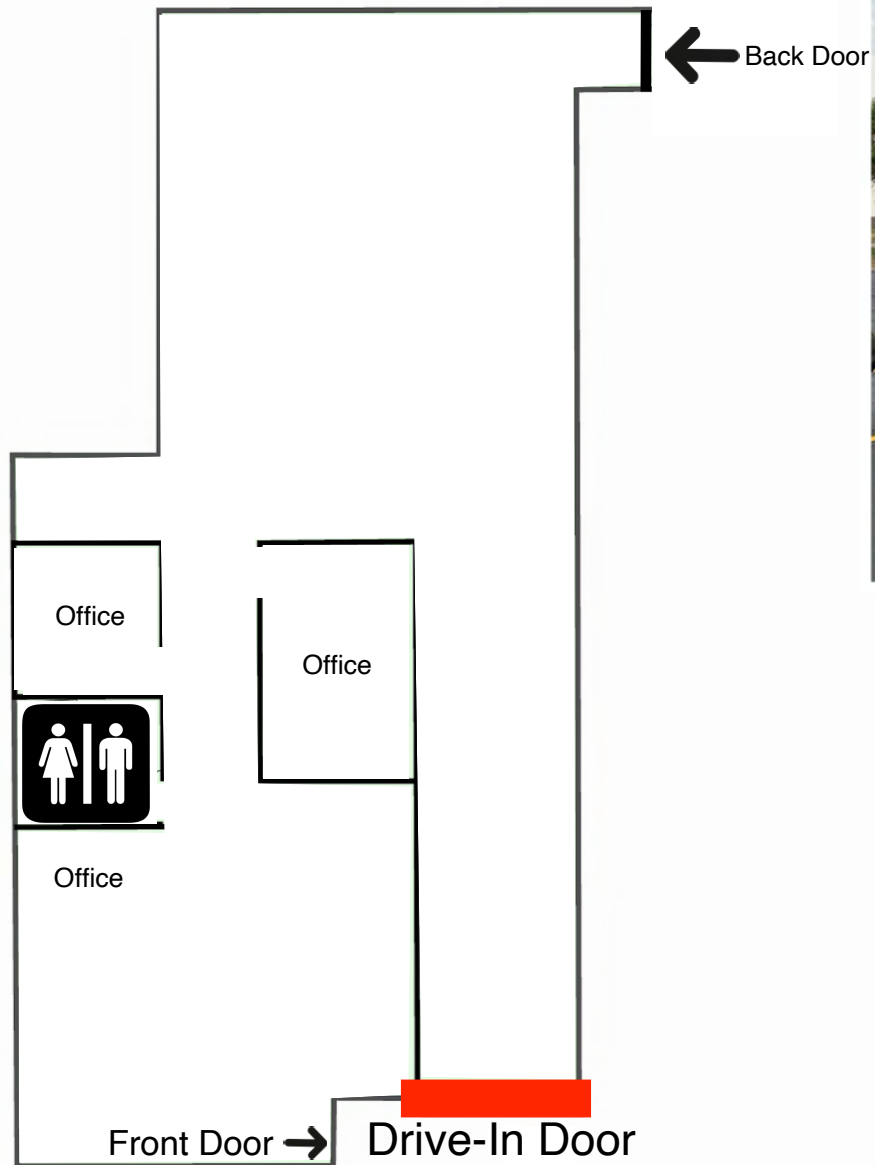

- 1,588 SF - Warehouse
 - 770 SF - Office
-
- 2,358 SF TOTAL

\$13.75/SF NNN



UNIT B7



UNIT B2



UNIT B7 - Office



UNIT B2

LOCATION

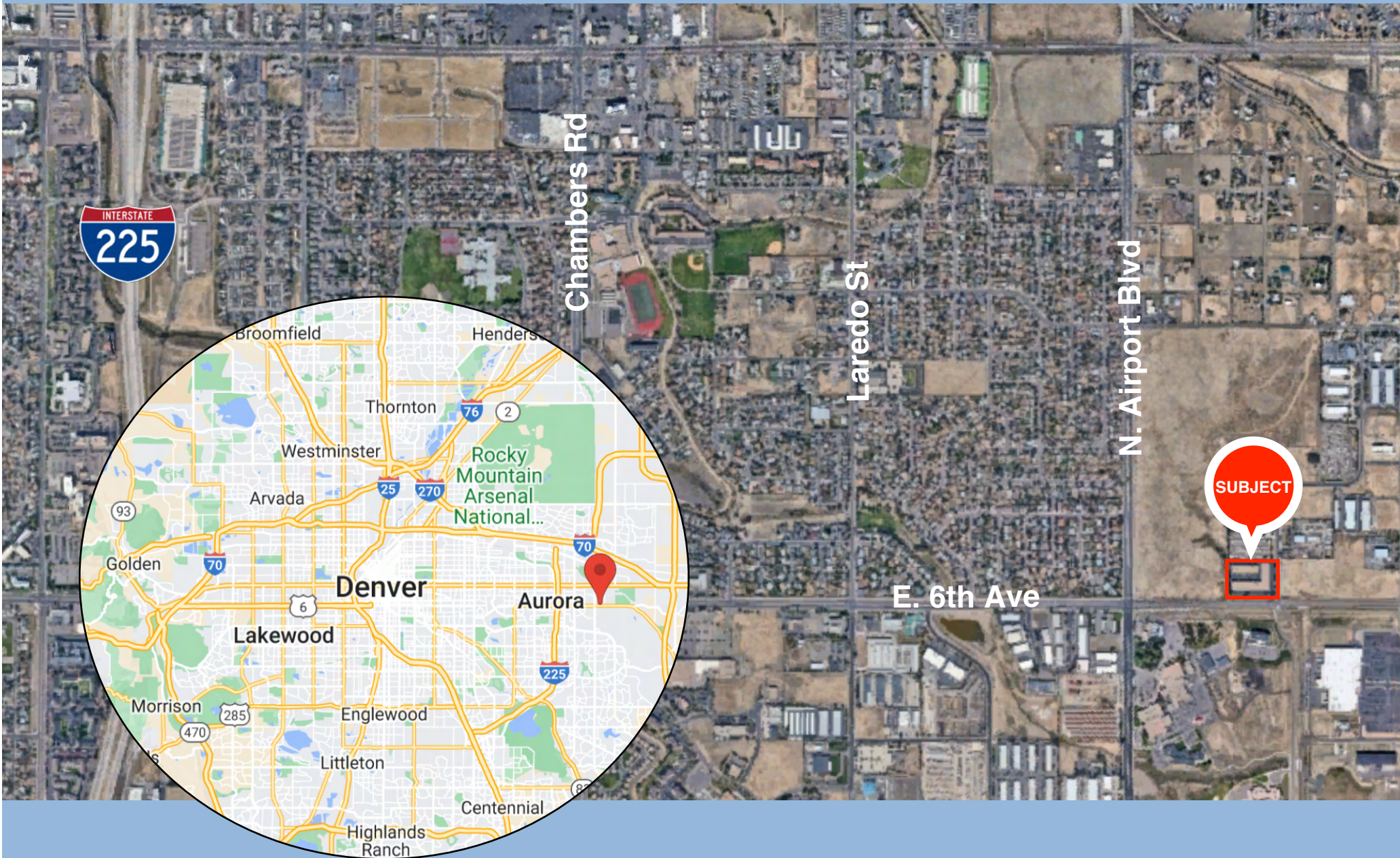

Ilya Klein
303-242-2077
ilya@novelcommercial.com

*Novel*Commercial