

101 North 10th Street

Williamsburg, Brooklyn, NY

Location: Between Wythe Ave and Berry St

Suite 301: 3,140 RSF

Ceiling Height: 11.5 FT

Highlights:

- Newly renovated fully built out office suite located in the heart of Williamsburg
- Lobby with elevator access
- Space built out with a Kitchenet, HVAC system, fire sprinkler system, and Verizon Fios
- Located three blocks from the **L** Train Station at Bedford Avenue & 5 Blocks from the **G** Train Station on Manhattan Avenue
- Surrounded by five major hotels – *The Williamsburg Hotel, Wythe Hotel, The William Vale, The Hoxton, and McCarren Hotel & Pool*



Neighboring Tenants:



Contact Exclusive Leasing Team



Harrison Balisky
516-672-4493
hb@olmstedre.com

Brad Krosser
862-368-7271
bk@olmstedre.com



101 North 10th Street

Photos

Williamsburg, Brooklyn, NY

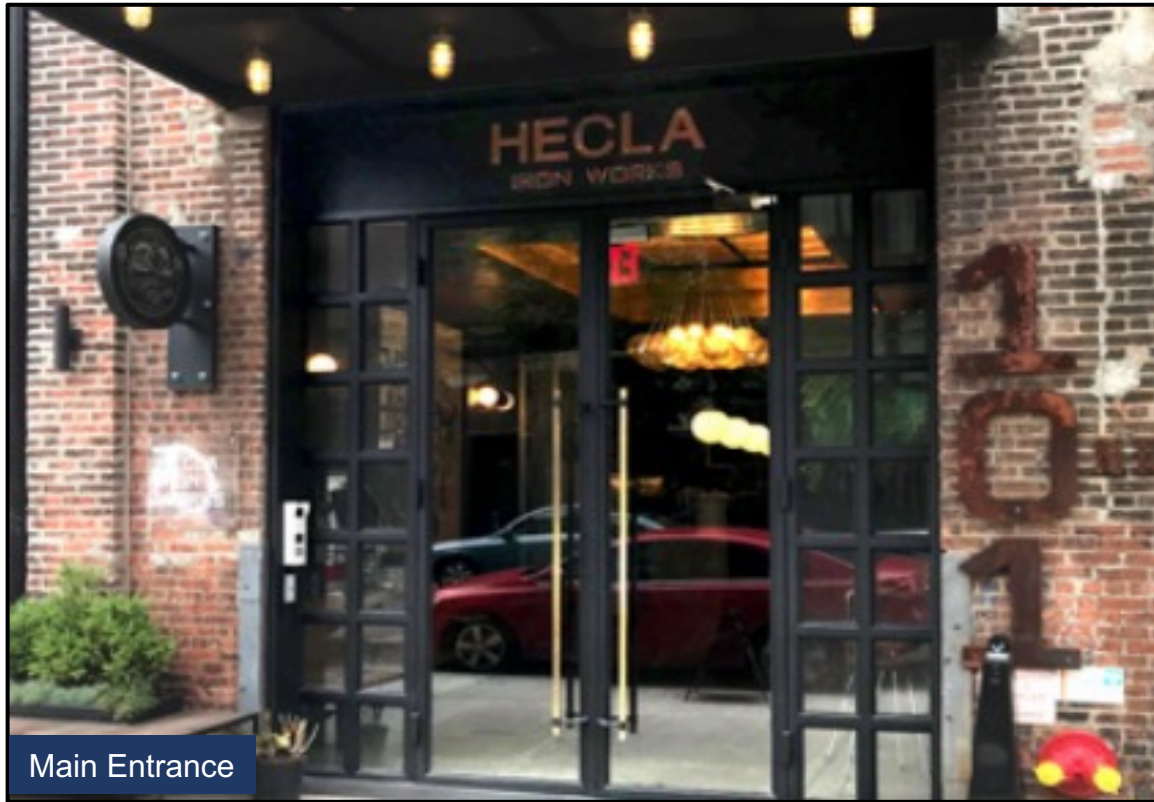

All information is from sources deemed reliable. No representation is made and we do not guarantee the accuracy of any information provided. All information must be independently verified. The value of any real estate investment is dependent on a variety of factors and should be evaluated carefully by prospective purchasers/ or tenants.



101 North 10th Street

Photos

Williamsburg, Brooklyn, NY



All information is from sources deemed reliable. No representation is made and we do not guarantee the accuracy of any information provided. All information must be independently verified. The value of any real estate investment is dependent on a variety of factors and should be evaluated carefully by prospective purchasers/ or tenants.



101 North 10th Street

Williamsburg, Brooklyn, NY

3rd Floorplan:

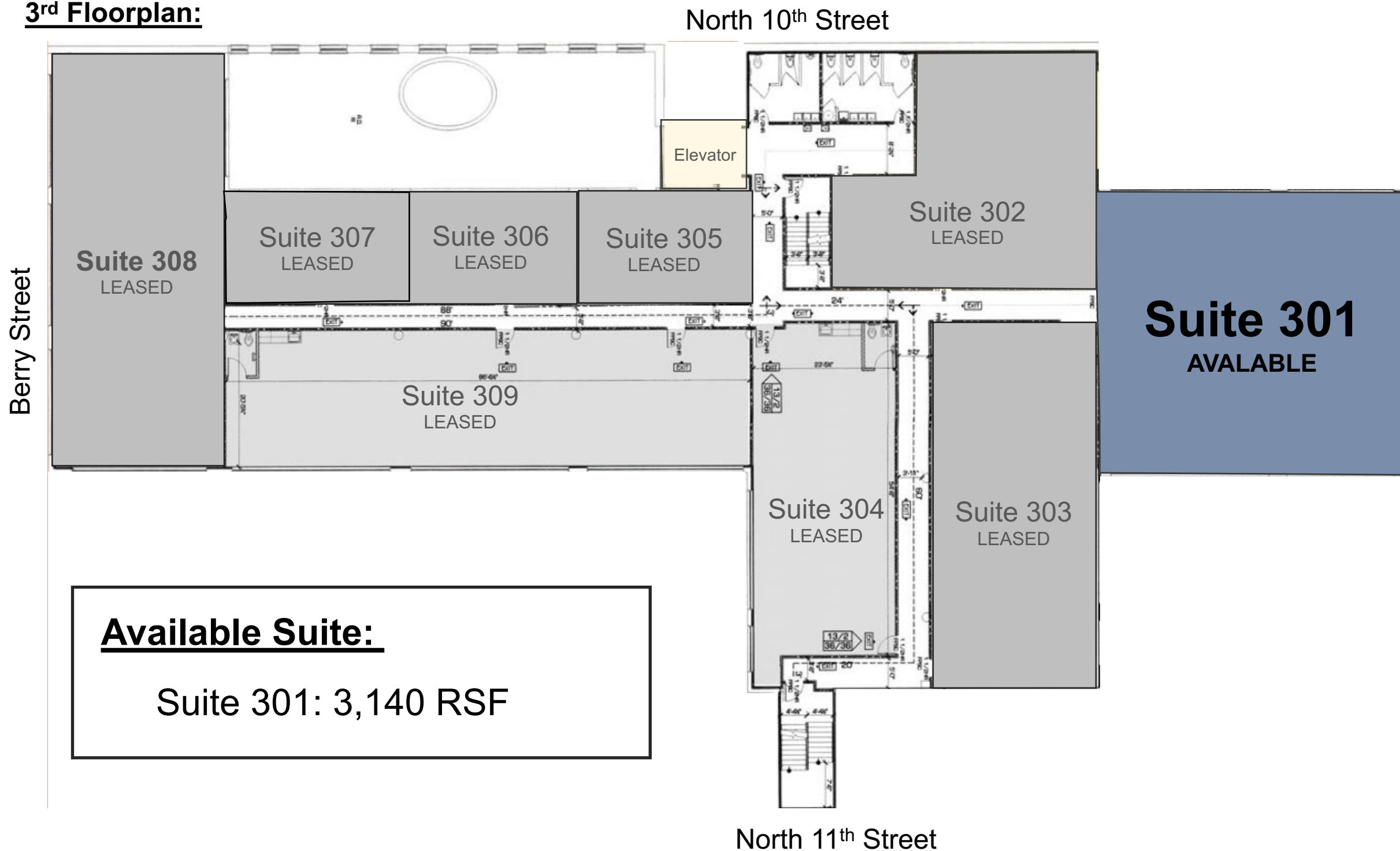

Available Suite:

Suite 301: 3,140 RSF



101 North 10th Street

Williamsburg, Brooklyn, NY

Retail Map:

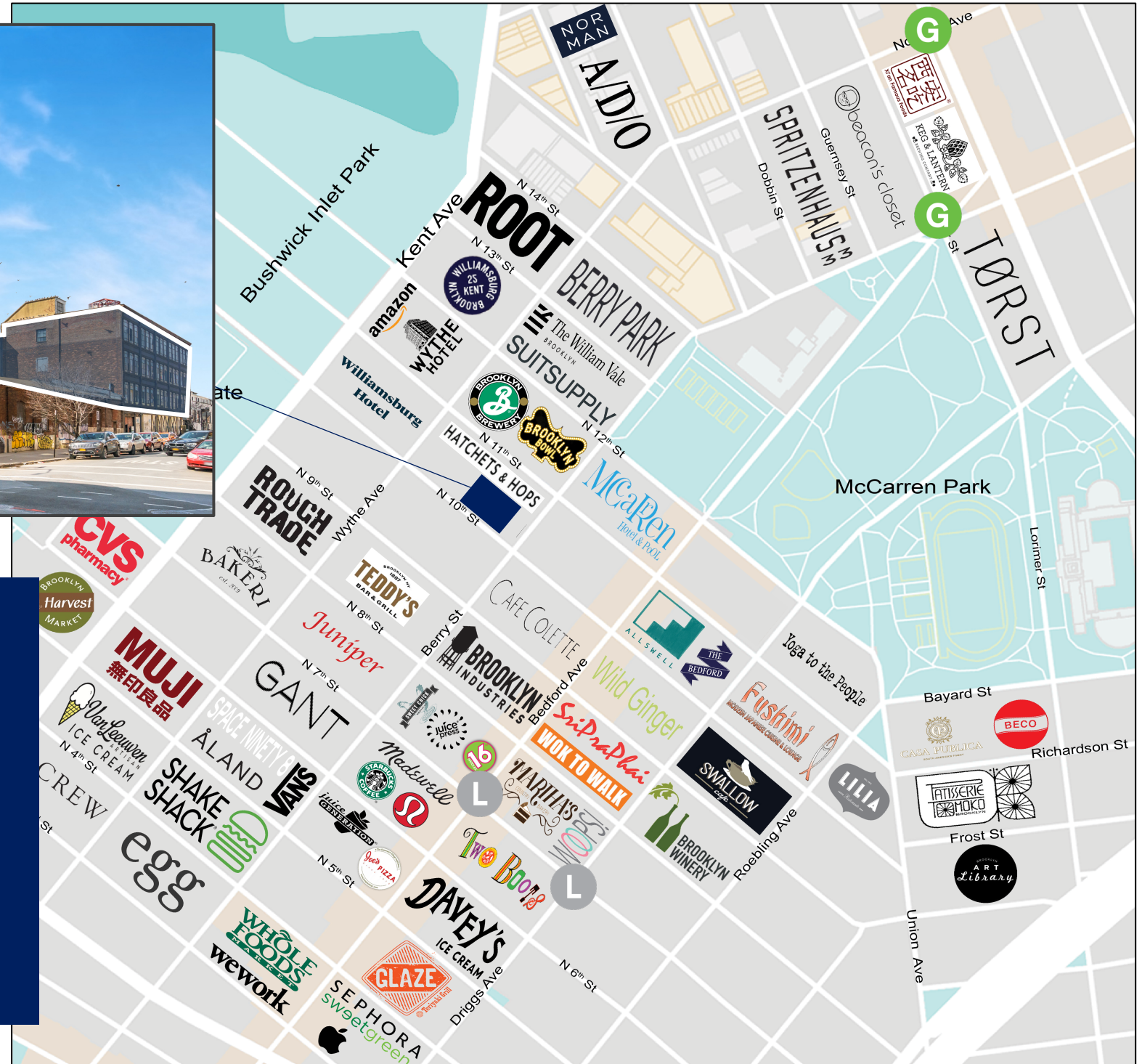

Annual Subway Ridership

- L** train is 5 min away at **Bedford Avenue** station with 9,892,516 annual ridership
- G** train is 8 min away at **Nassau Avenue** station with 2,880,235 annual ridership