

FOR LEASE | 11,697 SF
16018 ADELANTE ST, UNIT A
Irwindale, CA 91702



PROPERTY HIGHLIGHTS

Lease Rate/SF:	\$1.47 PSF NNN + \$0.28 estimated opex
Available SF:	11,697 SF
Office SF:	1,400 SF
Yard:	No
Sprinklered:	Yes
GL Doors/Dim:	1
DH Doors/Dim:	2
Parking Ratio:	1/1,000 SF
Vacancy:	Immediate Availability
Clearance Height:	24'

Immediate Access to (210) Freeway via Irwindale Avenue

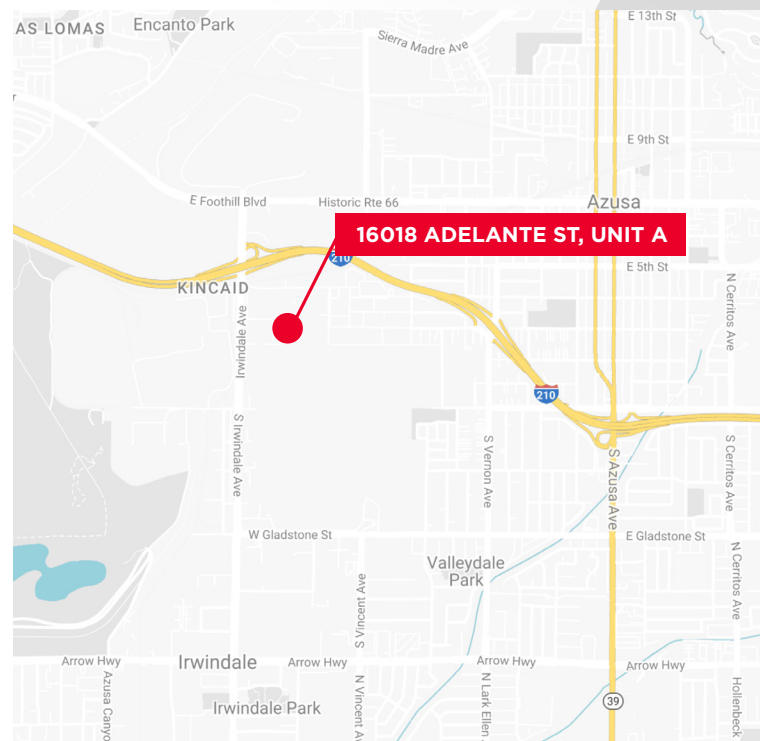

For more information contact:

CHRIS TOLLES

Executive Managing Director
Commercial Brokerage
+1 213 955 5129
chris.tolles@cushmanwakefield.com
CA Lic #01459899

900 Wilshire Blvd, Suite 2400
Los Angeles, CA 90017
+1 213 955 5100
cushmanwakefield.com



FOR LEASE

16018 Adelante St, Unit A

IRWINDALE, CA 91702

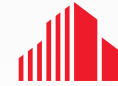

CUSHMAN &
WAKEFIELD

SITE PLAN

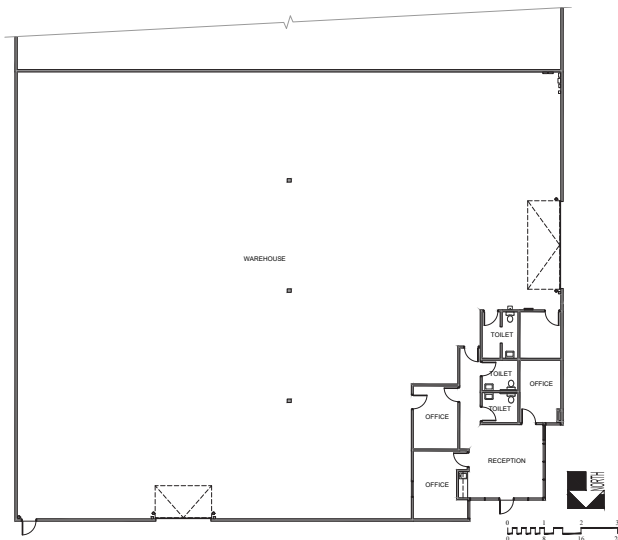

UNIT PHOTOS



AERIAL MAP



For more information contact:

CHRIS TOLLES

Executive Managing Director

Commercial Brokerage

+1 213 955 5129

chris.tolles@cushwake.com

CA Lic #01459899

900 Wilshire Blvd, Suite 2400

Los Angeles, CA 90017

+1 213 955 5100

cushmanwakefield.com

©2024 Cushman & Wakefield. All rights reserved. The information contained in this communication is strictly confidential. This information has been obtained from sources believed to be reliable but has not been verified. NO WARRANTY OR REPRESENTATION, EXPRESS OR IMPLIED, IS MADE AS TO THE CONDITION OF THE PROPERTY (OR PROPERTIES) REFERENCED HEREIN OR AS TO THE ACCURACY OR COMPLETENESS OF THE INFORMATION CONTAINED HEREIN, AND SAME IS SUBMITTED SUBJECT TO ERRORS, OMISSIONS, CHANGE OF PRICE, RENTAL OR OTHER CONDITIONS, WITHDRAWAL WITHOUT NOTICE, AND TO ANY SPECIAL LISTING CONDITIONS IMPOSED BY THE PROPERTY OWNER(S). ANY PROJECTIONS, OPINIONS OR ESTIMATES ARE SUBJECT TO UNCERTAINTY AND DO NOT SIGNIFY CURRENT OR FUTURE PROPERTY PERFORMANCE.