

OFFICE SPACE  
FOR LEASE

# 6302 Corporate Center

6302 E DR MARTIN LUTHER KING JR BLVD • TAMPA, FL • 33619



**BROKER  
BONUS!**  
Extra 1%  
Commission\*

\*On qualified leases  
signed by 3/31/25.  
Contact for details.

**NEWLY RENOVATED!**  
OVER 125,000 SF AVAILABLE WITH  
SPACES RANGING FROM 8,000-45,000 SF

## PROPERTY OVERVIEW

Property Type	Office / Flex
Property Size	350,000 sf
Year Built	1985, Renov 2023
Parking	5+/1,000

## PROPERTY FEATURES

- + 50-acre campus featuring 2 lakes
- + Renovated common areas, including an on-site conference facility and café serving breakfast, lunch, and dinner
- + 24/7 on-site security
- + Atrium lounge with free WiFi, TVs, and collaborative seating
- + Visibility from I-4 with a traffic count of 147,000 vpd
- + Non-flood / Non-evacuation zone location

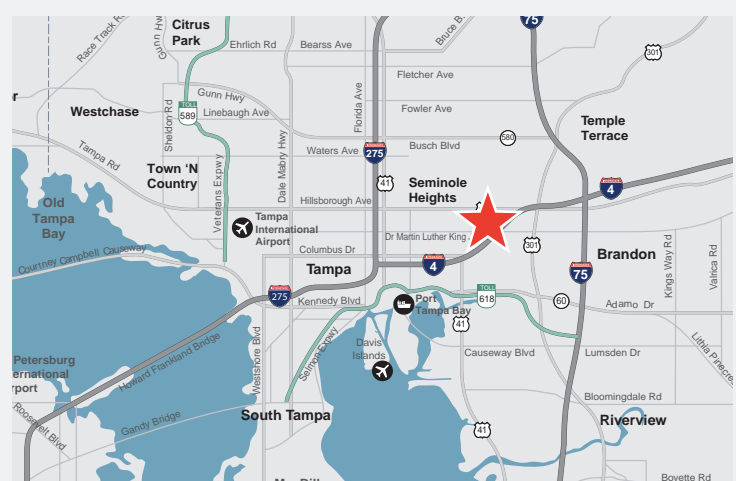

## LOCATION

- + Central location with immediate access to I-4, I-75, I-275, and the Leroy Selmon Expressway
- + 10 minutes from Downtown Tampa and 15 minutes from Tampa International Airport
- + Nearby amenities include banks, hotels, and restaurants
- + On-site Hartline bus stop along major route



**Thomas Hernandez, SIOR, CCIM**  
(813) 494-4090 mobile  
thernandez@ciminelli.com





OFFICE SPACE  
FOR LEASE

# 6302 Corporate Center

6302 E DR MARTIN LUTHER KING JR BLVD • TAMPA, FL • 33619

Newly renovated atrium lounge



## Campfired ON-SITE CAFE OPEN 7AM-7PM



Thomas Hernandez, SIOR, CCIM  
(813) 494-4090 mobile  
thernandez@ciminelli.com





OFFICE SPACE  
FOR LEASE

# 6302 Corporate Center

6302 E DR MARTIN LUTHER KING JR BLVD • TAMPA, FL • 33619

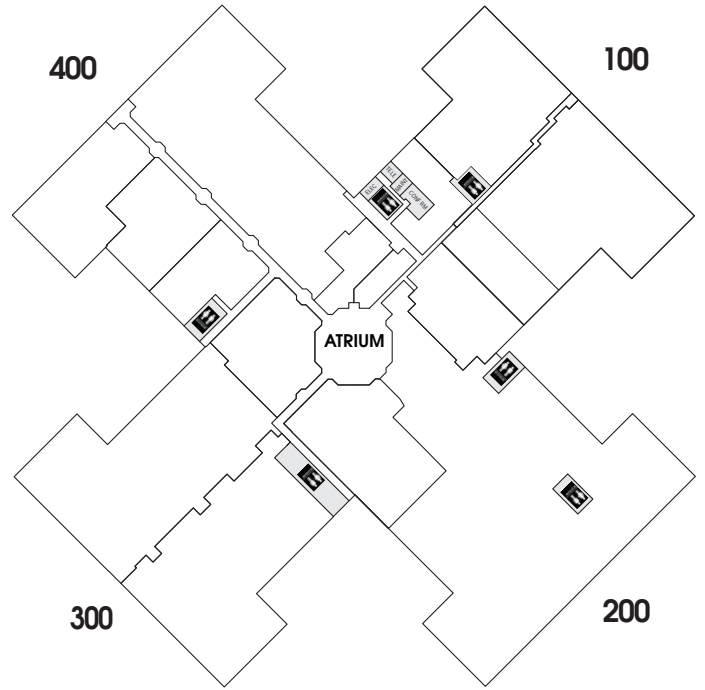

Thomas Hernandez, SIOR, CCIM  
(813) 494-4090 mobile  
thernandez@ciminelli.com





OFFICE SPACE  
FOR LEASE

# 6302 Corporate Center

6302 E DR MARTIN LUTHER KING JR BLVD • TAMPA, FL • 33619



6302 CORPORATE CENTER

TOWNEPLACE  
SUITES  
BY MARRIOTT

Fairfield  
BY MARRIOTT

E MLK JR BLVD

SEMINOLE  
Hard Rock  
HOTEL & CASINO

MIDFLORIDA  
CREDIT UNION  
AMPHITHEATRE  
AT THE FLORIDA STATE FAIRGROUNDS

FLORIDA  
STATE FAIR



## DRIVE TIMES

I-4	0.5 mi	2 mins
Seminole Hard Rock Hotel & Casino	1.5 mi	5 mins
MidFlorida Credit Union Amphitheatre	2.2 mi	7 mins
Florida State Fairgrounds	2.7 mi	6 mins
Downtown Tampa	6.1 mi	9 mins
Tampa International Airport	11.1 mi	15 mins

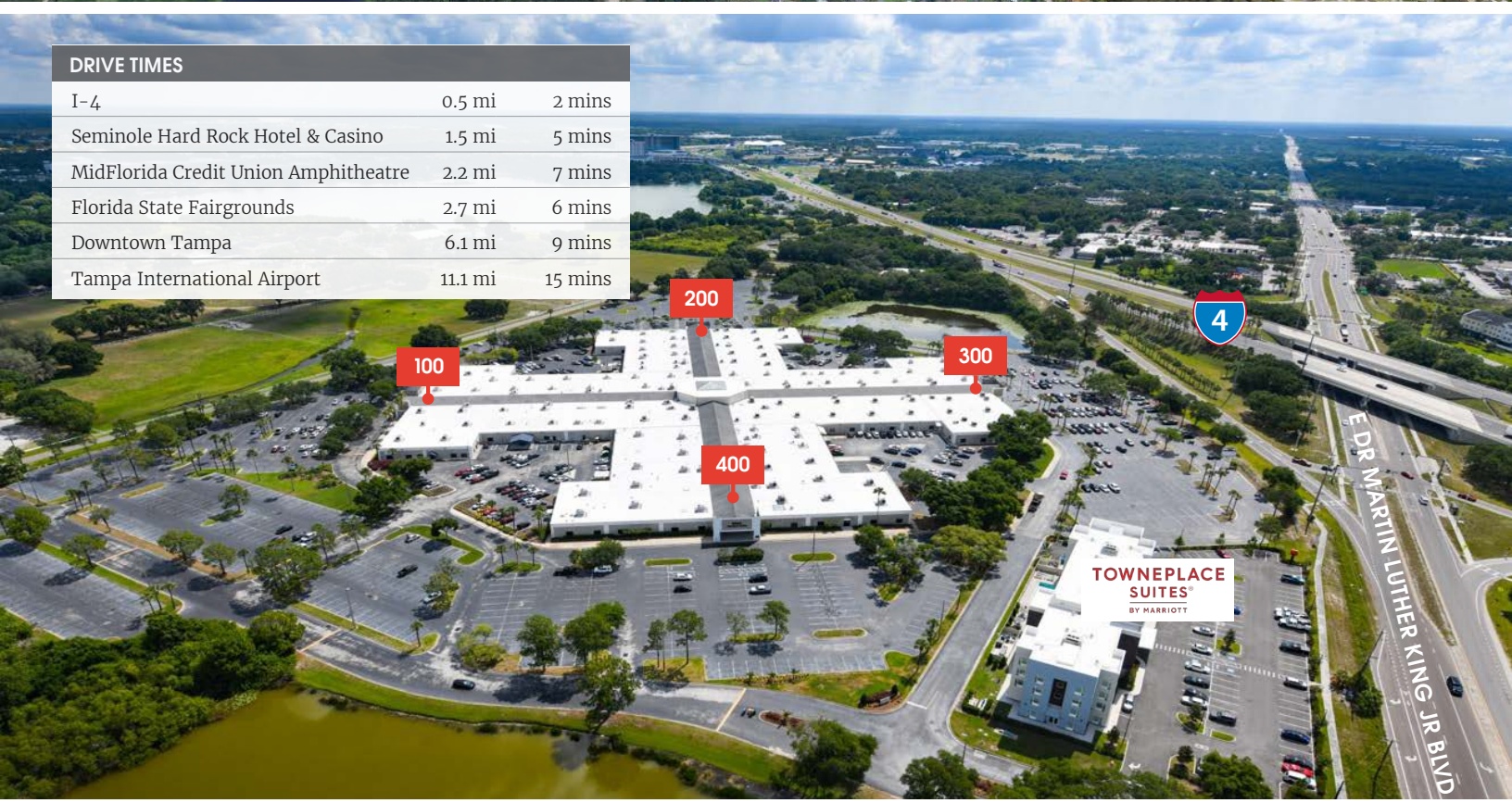

100

200

300

400

TOWNEPLACE  
SUITES  
BY MARRIOTT



E DR MARTIN LUTHER KING JR BLVD



Thomas Hernandez, SIOR, CCIM  
(813) 494-4090 mobile  
thernandez@ciminelli.com

 **Ciminelli**  
REAL ESTATE SERVICES

In Partnership with

 **TOROSE** EQUITIES