

INDUSTRIAL SPACE FOR LEASE - DIVISIBLE WITH HIGH POWER

1400 - 1450 N 25th AVE
MELROSE PARK, ILLINOIS

14,237 - 149,294 SF



INDUSTRIAL SPACE UP TO ±149,294 SF
1400-1450 N 25th AVENUE
MELROSE PARK, ILLINOIS

FOR LEASE

Property Features

- Building Size: 474,296 SF
- Available Size: Up to 149,294 SF
- Divisible to 14,237 SF
- Ceiling Height: 18'
- Up to 11 Docks (Expandable)
- Up to 4 Drive-in Doors (Expandable)
- Car Parking: 1/1,000 SF
- 2000 AMPS Power
- Warehouse with 100% A/C

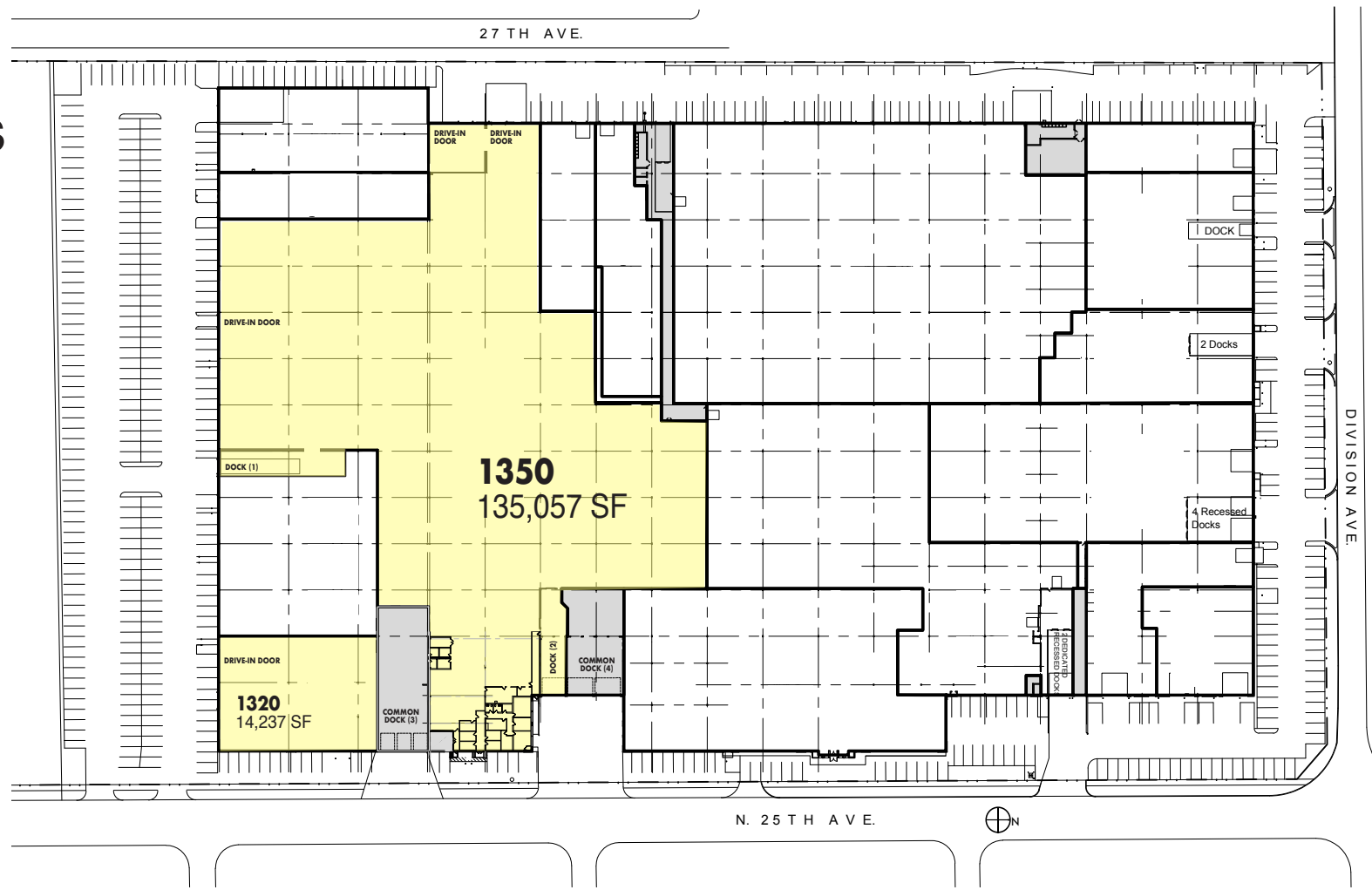

JASON SHIBATA
PARTNER
312.462.1022
JASON@JBSCRE.COM

BRIAN SILVERMAN
PARTNER
312.462.1023
BRIAN@JBSCRE.COM



ALL INFORMATION IS DEEMED TO BE RELIABLE BUT NOT GUARANTEED

INDUSTRIAL SPACE UP TO ±149,294 SF

1400-1450 N 25th AVENUE

MELROSE PARK, ILLINOIS

FOR LEASE

Conceptual Demising Plan

VACANCY A

- Up to 5 Docks
- 1 Ramped Dock
- 600 AMPS Power
- Warehouse with 100% A/C

VACANCY B

- Up to 10 Docks (Expandable)
- Up to 2 Drive-in Doors
- 1000 AMPS Power
- Warehouse with 100% A/C

VACANCY C

- Up to 4 Docks (Expandable)
- Up to 1 Drive-in Door (Expandable)
- 400 AMPS Power

UNIT 1320

- Up to 3 Docks
- Up to 1 Drive-in Door (Expandable)
- 400 AMPS Power

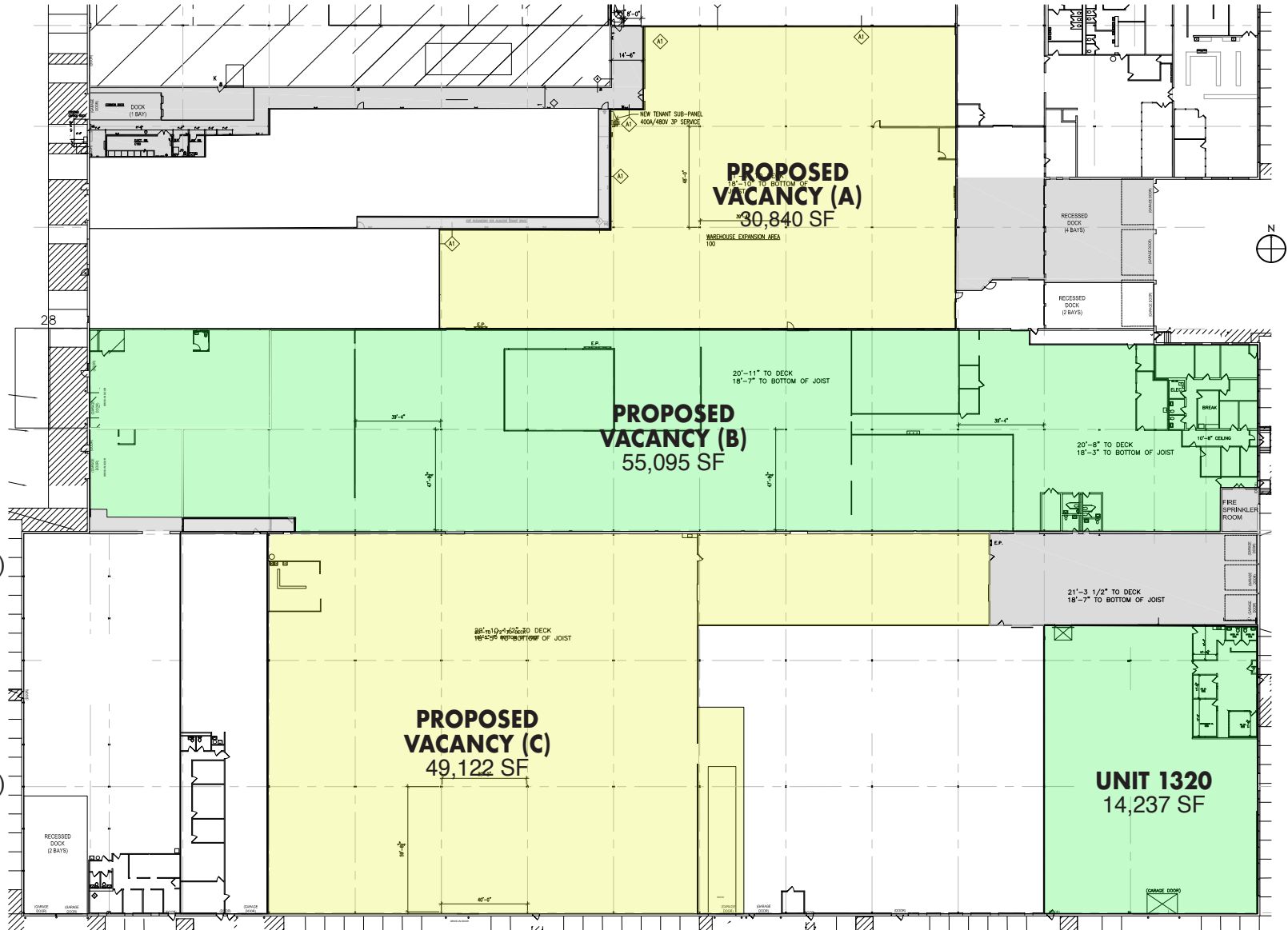

JASON SHIBATA
PARTNER
312.462.1022
JASON@JBSCRE.COM

BRIAN SILVERMAN
PARTNER
312.462.1023
BRIAN@JBSCRE.COM



ALL INFORMATION IS DEEMED TO BE RELIABLE BUT NOT GUARANTEED