



±38,988 SF Warehouse / Distribution Space with In-Place Racking

CROSSROADS LOGISTICS CENTER

19105 CHRISTOPHER WAY, UNIT 200

LATHROP, CA 95330



**FOR SUBLEASE
LED 3/31/2028**

AVAILABLE SIZE	±38,988 SF
PARCEL SIZE	±7.72 acres
OFFICE SIZE	±3,168 SF
OFFICE DESCRIPTION	9 private offices, break room and 2 restrooms
DOCK HIGH DOORS	6 doors (w/ bumpers)
GRADE LEVEL DOORS	1 door
EMPLOYEE PARKING	38 stalls
TRAILER PARKING	TBD
FIRE SUPPRESSION	ESFR
COLUMN SPACING	57' x 57'
CLEAR HEIGHT	29' - 32'
SKYLIGHTS	Yes
LIGHTING	LED w/ sensors
TRUCK COURT	116' - 188'
INDICATED POWER	225 amps, 277/480V, 3-phase
RACKING	In-place
WATER	City of Lathrop
SEWER	City of Lathrop
GAS & ELECTRIC	PG&E

EXCELLENT PROXIMITY TO BAY AREA, PORT OF OAKLAND AND BNSF & UP INTERMODAL FACILITIES

EASY ACCESS TO INTERSTATE 5, HIGHWAY 99 AND HIGHWAY 120



OFFICE SITE PLAN - ±3,168 SF

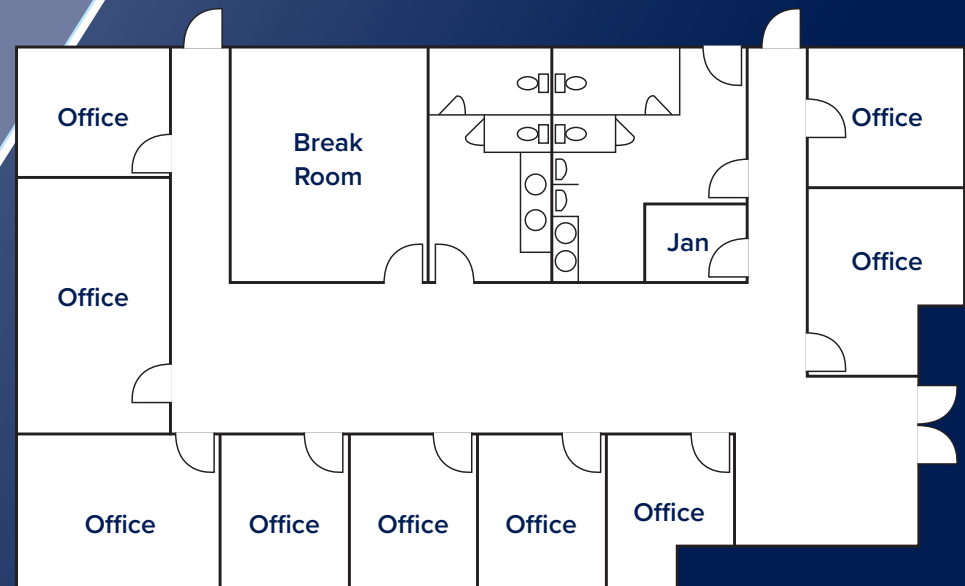

TRANSPORTATION & LOGISTICS

Colliers

City	STOCKTON	11 miles
	SACRAMENTO	58 miles
	OAKLAND	62 miles
	SAN JOSE	65 miles
	SAN FRANCISCO	73 miles
	FRESNO	117 miles
	RENO	192 miles
	LOS ANGELES	327 miles
	LAS VEGAS	511 miles
	PORTLAND	636 miles
	PHOENIX	697 miles
	SALT LAKE CITY	707 miles
	SEATTLE	809 miles
	DENVER	1,243 miles
Airport	PORT OF STOCKTON	14 miles
	PORT OF WEST SACRAMENTO	58 miles
	PORT OF OAKLAND	62 miles
	PORT OF SAN FRANCISCO	74 miles
	PORT OF LA & LONG BEACH	353 miles
	PORT OF SEATTLE	813 miles
Port	STOCKTON METRO AIRPORT	8 miles
	OAKLAND INT'L AIRPORT	56 miles
	SAN JOSE INT'L AIRPORT	62 miles
	SACRAMENTO INT'L AIRPORT	70 miles
	SAN FRANCISCO INT'L AIRPORT	75 miles
Rail	UP INTERMODAL FACILITY	7 miles
	BNSF INTERMODAL FACILITY	14 miles





3439 Brookside Road, Suite 108
Stockton, CA 95219
P: +1 209 475 5100
F: +1 209 475 5102
colliers.com

EXCLUSIVE BROKERS:

ALEX HOECK, SIOR

Executive Vice President
CA License No. 01943853
alex.hoeck@colliers.com
+1 209 851 1191

MIKE GOLDSTEIN, SIOR

Vice Chair
Executive Managing Director
CA License No. 01319234
michael.goldstein@colliers.com
+1 209 475 5106

RYAN MCSHANE, SIOR

Vice Chair
CA License No. 01295796
ryan.mcshane@colliers.com
+1 209 483 9851

WES WIDMER, SIOR

Executive Vice President
CA License No. 01315686
wes.widmer@colliers.com
+1 209 598 0331

BEN GIBBS, SIOR

Principal
CRESA
bgibbs@cresa.com
+1 325 370 4418

This document has been prepared by Colliers International for advertising and general information only. Colliers International makes no guarantees, representations or warranties of any kind, expressed or implied, regarding the information including, but not limited to, warranties of content, accuracy and reliability. Any interested party should undertake their own inquiries as to the accuracy of the information. Colliers International excludes unequivocally all inferred or implied terms, conditions and warranties arising out of this document and excludes all liability for loss and damages arising there from. This publication is the copyrighted property of Colliers International and/or its licensor(s). ©2026. All rights reserved.