



**913 N Market St
Wilmington, DE 19801
+/- 3,300 Rentable SF**

**Retail/Office
FOR Lease
~~\$28~~ \$23/sf Gross
Lease**



**For a limited time only
Ends 8/31/2025
we are offering the following:**

- 1) Price drop per square foot for year one.**
- 2) Full commission to cooperating brokers.**
- 3) Tenant Improvements allowance.**

The information presented is believed to be accurate, but the users must verify it for their own satisfaction. Price and availability are subject to change without prior notice. The Seller's/Owner's broker, any cooperating broker, and any salesperson working with either are representing the Seller's best interests and have fiduciary responsibilities to Seller, but are obligated to treat all parties fairly.

For More Information Please Contact:

Mitri S. Habash, CCIM, MICP
302-218-3025
Habash@HabashCommercial.com

Yasmin Bowman
302-438-8667
Yasmin@bowmanrealestatell.com

Habash Commercial Realty

205 Philadelphia Pike,
Wilmington, DE 19809
(302) 544-9144





913 N Market St
Wilmington, DE 19801
+/- 3,300 Rentable SF

Retail/Office
FOR Lease
~~\$28~~ \$23/sf Gross

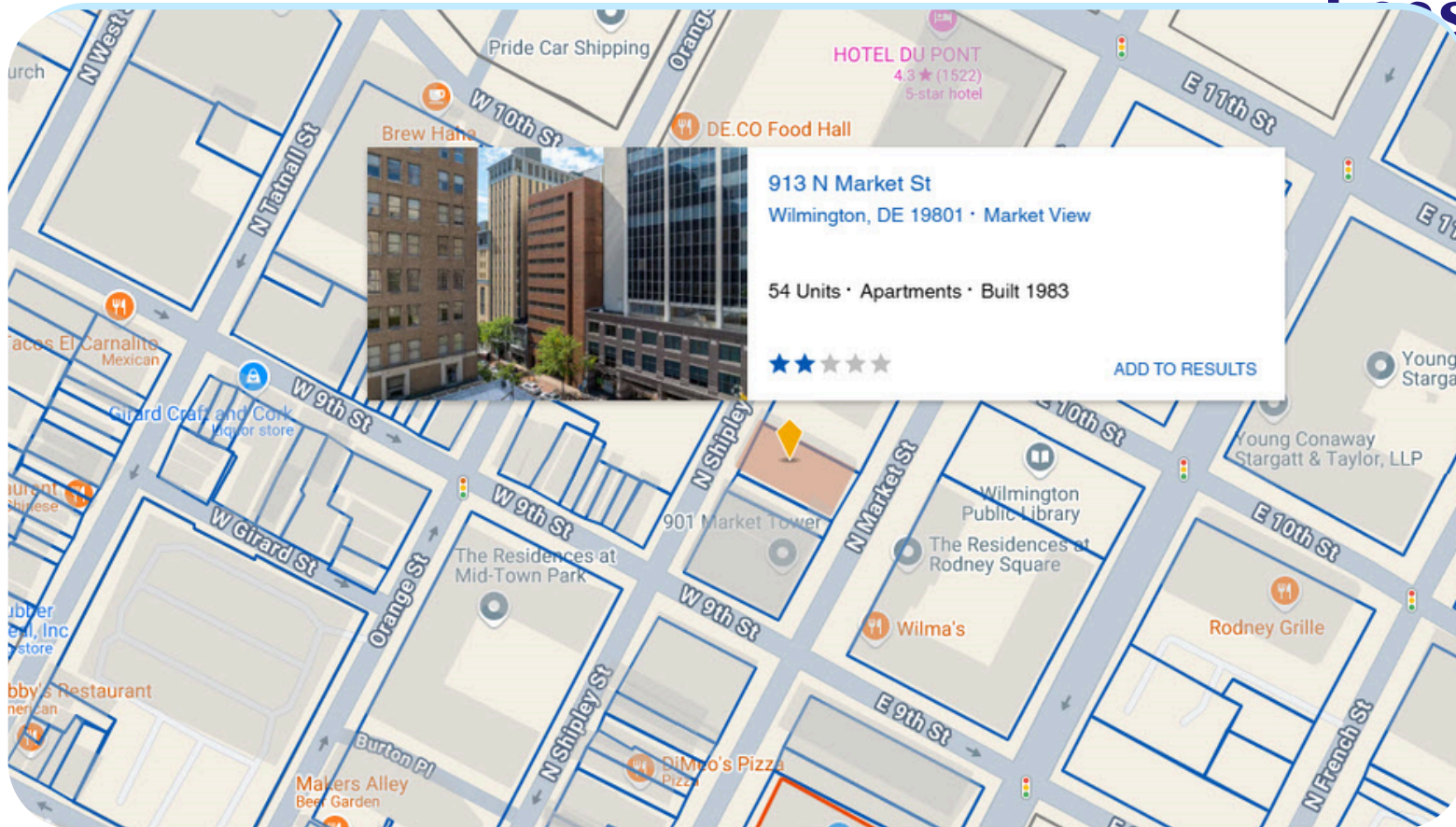

The information presented is believed to be accurate, but the users must verify it for their own satisfaction. Price and availability are subject to change without prior notice. The Seller's/Owner's broker, any cooperating broker, and any salesperson working with either are representing the Seller's best interests and have fiduciary responsibilities to Seller, but are obligated to treat all parties fairly.

For More Information Please Contact:

Mitri S. Habash, CCIM, MICP
302-218-3025
Habash@HabashCommercial.com

Yasmin Bowman
302-438-8667
Yasmin@bowmanrealestatell.com

Habash Commercial Realty

205 Philadelphia Pike,
Wilmington, DE 19809
(302) 544-9144



**1903 N Market St
Wilmington, DE 19801
+/- 3,300 Rentable Sf**

**Retail/Office
FOR Lease
~~\$28~~ \$23/sf Gross
Lease**



The information presented is believed to be accurate, but the users must verify it for their own satisfaction. Price and availability are subject to change without prior notice. The Seller's/Owner's broker, any cooperating broker, and any salesperson working with either are representing the Seller's best interests and have fiduciary responsibilities to Seller, but are obligated to treat all parties fairly.

For More Information Please Contact:

Mitri S. Habash, CCIM, MICP
302-218-3025
Habash@HabashCommercial.com

Yasmin Bowman
302-438-8667
Yasmin@bowmanrealestatell.com

Habash Commercial Realty

205 Philadelphia Pike,
Wilmington, DE 19809
(302) 544-9144



**913 N Market St
Wilmington, DE 19801
+/- 3,300 Rentable SF**

**Retail/Office
FOR Lease
~~\$28~~ \$23/sf Gross**

Property Overview

Prime Downtown Wilmington Retail/Office Space – 913 N Market Street

Unlock the potential of approximately 3,300 SF of high-visibility ground-floor space in the heart of Downtown Wilmington's Central Business District! Located just a half block from Rodney Square, the Hotel DuPont, and the Bankruptcy Court, this versatile property offers unmatched convenience and visibility in one of Wilmington's most vibrant corridors.

Lease

Property Highlights

Outstanding Location: Just steps from major landmarks including the Carvel State Office Building, New Castle County Courthouse, and Federal Building.

Strong Foot Traffic: Surrounded by bustling offices, restaurants, banks, and cultural institutions – ideal for retail, office, or service-based businesses.

Excellent Accessibility: Enjoy easy access to public transit and benefit from a brand-new parking garage located directly behind the building.

Brand Exposure: Prominent storefront with high visibility on N Market Street – a prime destination for professionals, visitors, and locals alike.

Dynamic Business Environment: Be part of Wilmington's walkable and revitalized business district, home to a mix of commerce, government, and the arts.

Whether you're launching a flagship retail location, opening a client-facing office, or establishing a new service hub, 913 N Market Street delivers the presence and positioning your business needs.



The information presented is believed to be accurate, but the users must verify it for their own satisfaction. Price and availability are subject to change without prior notice. The Seller's/Owner's broker, any cooperating broker, and any salesperson working with either are representing the Seller's best interests and have fiduciary responsibilities to Seller, but are obligated to treat all parties fairly.

For More Information Please Contact:

Mitri S. Habash, CCIM, MICP
302-218-3025
Habash@HabashCommercial.com

Yasmin Bowman
302-438-8667
Yasmin@bowmanrealestatell.com

Habash Commercial Realty

205 Philadelphia Pike,
Wilmington, DE 19809
(302) 544-9144



**913 N Markest St
Wilmington, DE 19801
+/- 3,300 Rentable SF**

**Retail/Office
FOR Lease
~~\$28~~ \$23/sf Gross
Lease**

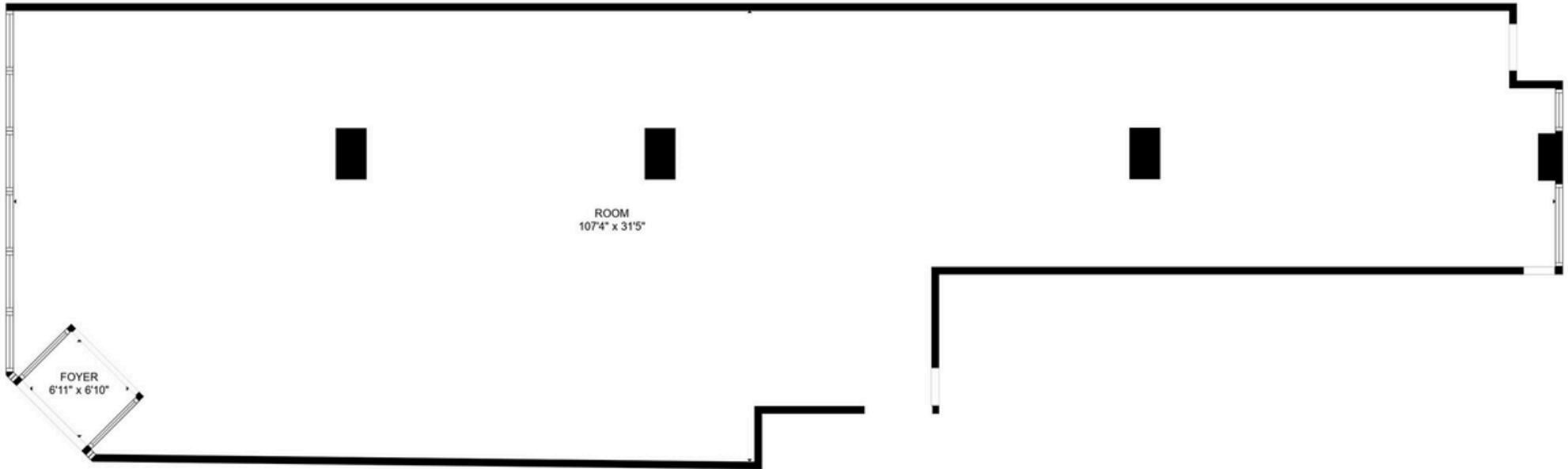

The information presented is believed to be accurate, but the users must verify it for their own satisfaction. Price and availability are subject to change without prior notice. The Seller's/Owner's broker, any cooperating broker, and any salesperson working with either are representing the Seller's best interests and have fiduciary responsibilities to Seller, but are obligated to treat all parties fairly.

For More Information Please Contact:

Mitri S. Habash, CCIM, MICP
302-218-3025
Habash@HabashCommercial.com

Yasmin Bowman
302-438-8667
Yasmin@bowmanrealestatell.com

Habash Commercial Realty

205 Philadelphia Pike,
Wilmington, DE 19809
(302) 544-9144



**913 N Markest St
Wilmington, DE 19801
+/- 3,300 Rentable SF**

**Retail/Office
FOR Lease
~~\$28~~ \$23/sf Gross
Lease**



Site Map

913 N Market St, Wilmington, Delaware, 19801 2
913 N Market St, Wilmington, Delaware, 19801
Rings: 1, 2, 3 mile radii

Prepared by Esri
Latitude: 39.74522
Longitude: -75.54840

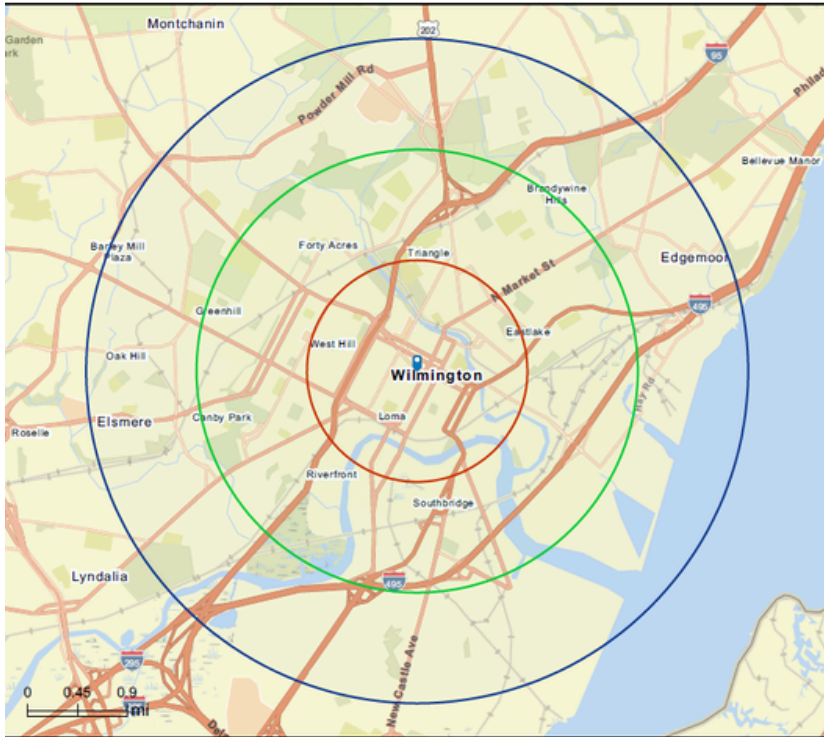

The information presented is believed to be accurate, but the users must verify it for their own satisfaction. Price and availability are subject to change without prior notice. The Seller's/Owner's broker, any cooperating broker, and any salesperson working with either are representing the Seller's best interests and have fiduciary responsibilities to Seller, but are obligated to treat all parties fairly.

For More Information Please Contact:

Mitri S. Habash, CCIM, MICP
302-218-3025
Habash@HabashCommercial.com

Yasmin Bowman
302-438-8667
Yasmin@bowmanrealestatell.com

Habash Commercial Realty

205 Philadelphia Pike,
Wilmington, DE 19809
(302) 544-9144