

# 1440 NORTH MILWAUKEE AVENUE

wicker park / chicago, il



MID-AMERICA® URBAN

AVAILABLE IMMEDIATELY



CONCEPTUAL RENDERING



# 1440 NORTH MILWAUKEE AVENUE

wicker park / chicago, il

## SPACE DETAILS

### ADDRESS

1440 N. Milwaukee Avenue  
Chicago, Illinois 60622

### NEIGHBORS



### AVAILABILITY

2,834 SF - Ground Floor

1,894 SF - Lower Level

### FEATURES

Join Supreme and Tacombi on the Milwaukee Corridor in Wicker Park

Newly redeveloped retail opportunity including new storefront, MEP, subfloor and drywall

Surrounded by a unique mix of international, national and local retailers and restaurateurs

Monthly parking available for additional fee

Additional 1,894 square feet of lower level storage space included

All uses will be considered

### DEMOGRAPHICS

	0.5 Miles	1 Miles	1.5 Miles
POPULATION	20,460	63,941	127,559
HOUSEHOLDS	10,256	31,540	61,001
AVG HOUSEHOLD INCOME	\$204,658	\$182,893	\$178,007
DAYTIME POPULATION	17,023	52,366	118,171

# 1440 NORTH MILWAUKEE AVENUE

wicker park / chicago, il

## STREET LEVEL SITE PLAN

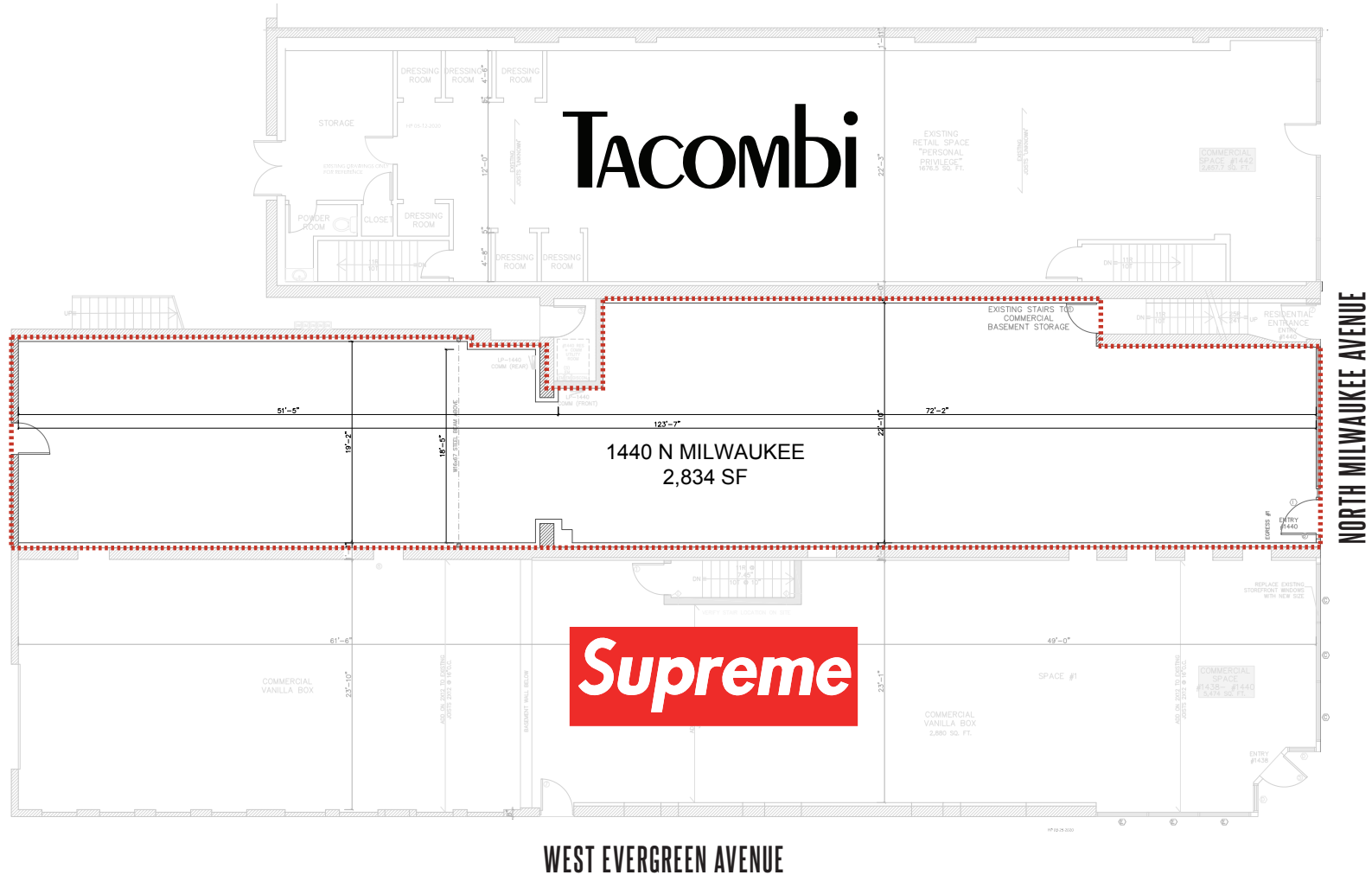

## SPACE DETAILS

2,834 SF - Ground Floor



# 1440 NORTH MILWAUKEE AVENUE

wicker park / chicago, il

LOWER LEVEL SITE PLAN

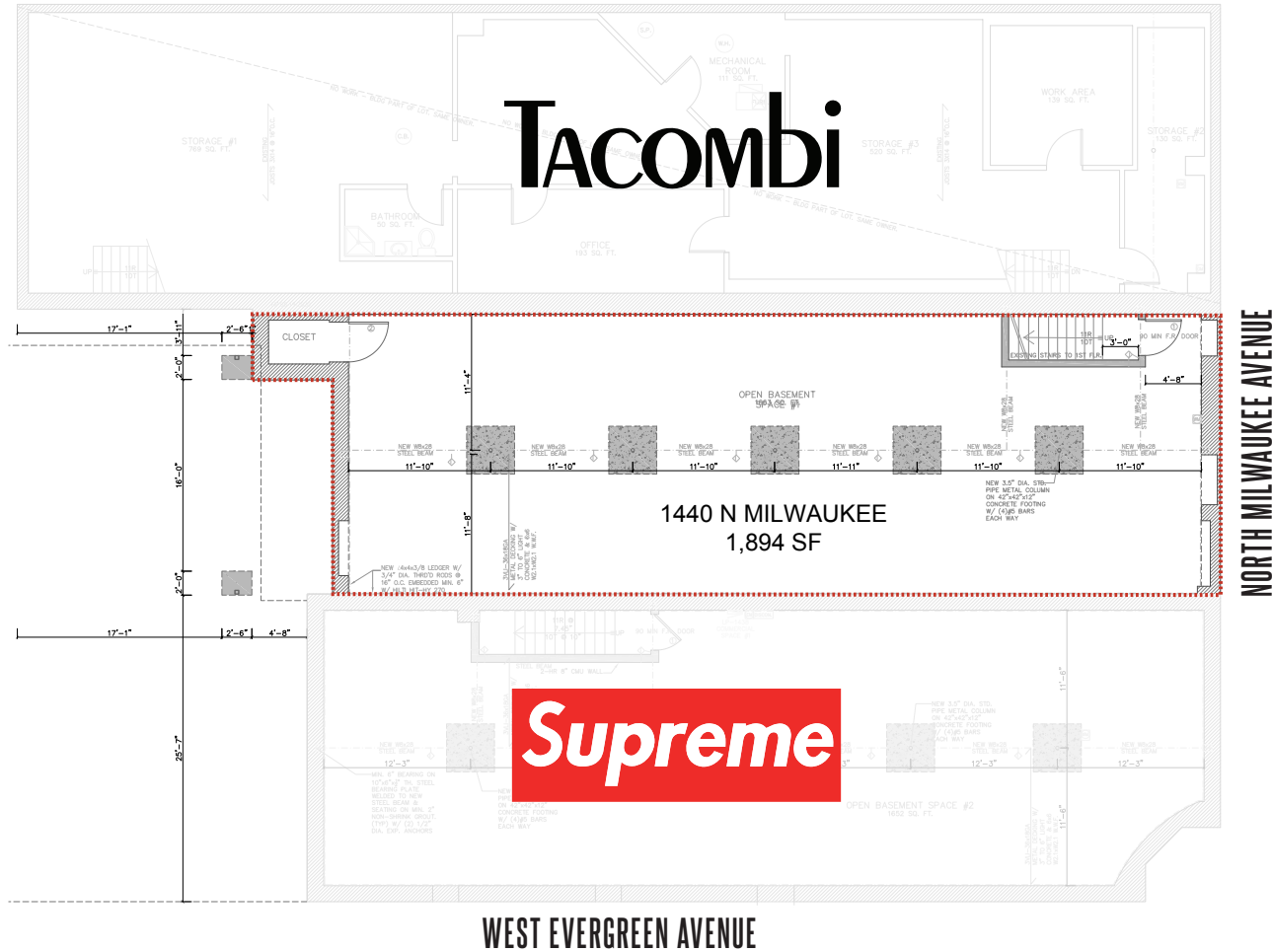

## SPACE DETAILS

1,894 SF - Lower Level





# 1440 NORTH MILWAUKEE AVENUE

wicker park / chicago, il

TRADE AREA MAP



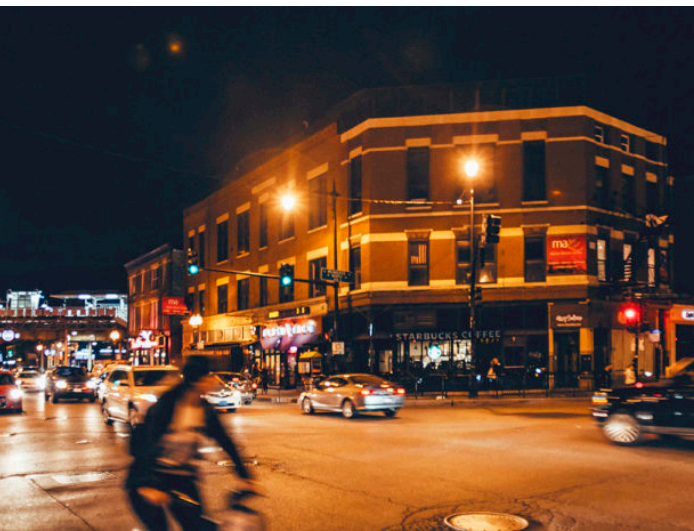

let's  
talk. **BIG**  
**IDEAS?**

**LARA KEENE**

Mid-America Real Estate Corporation

630.481.4038

LKeene@MidAmericaGrp.com

**WESTIN KANE**

Mid-America Real Estate Corporation

630.954.7447

WKane@MidAmericaGrp.com



**MID-AMERICA<sup>®</sup> URBAN**