

3241 Route 112

Building 7, Suite 1, Medford, New York



Property Information

- | | | | |
|----------------|----------------------------|----------------------|---|
| + Size: | 15,080 SF | + Comments: | - Plug & Play with all FF&E remaining |
| + Term: | Sublease through 8/31/2031 | + Property Features: | - Full Building Opportunity |
| + Possession: | Arranged | | - Divisions to be considered |
| + Asking Rent: | Available Upon Request | | - Eighty (80) unreserved parking spaces |

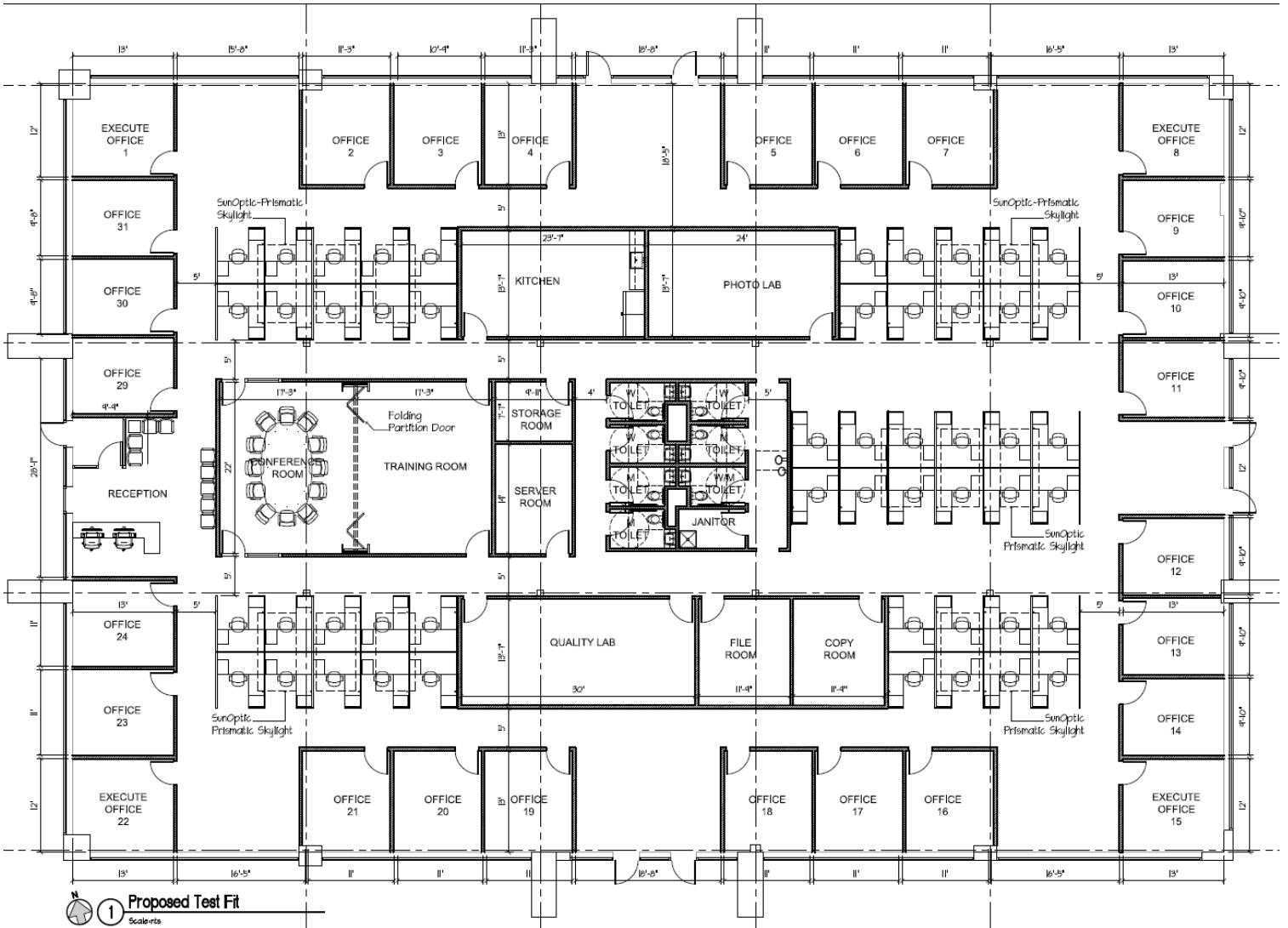



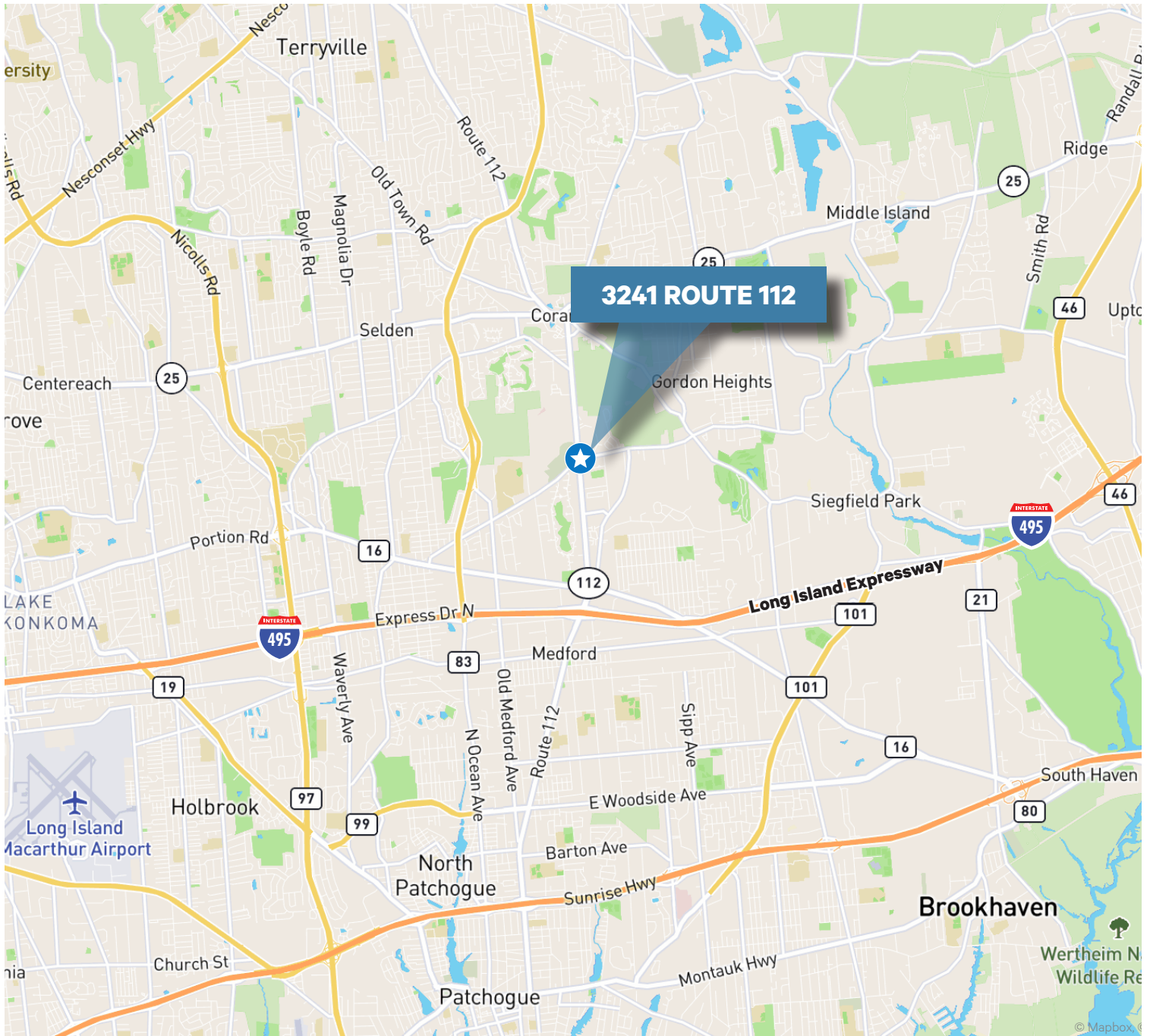

Contact Us

Domenico Maffei

Associate
+1 631 370 6062
domenico.maffei@cbre.com

Matt Manoogian

First Vice President
+1 631 370 6063
matt.manoogian@cbre.com

© 2024 CBRE, Inc. All rights reserved. This information has been obtained from sources believed reliable, but has not been verified for accuracy or completeness. You should conduct a careful, independent investigation of the property and verify all information. Any reliance on this information is solely at your own risk. CBRE and the CBRE logo are service marks of CBRE, Inc. All other marks displayed on this document are the property of their respective owners, and the use of such logos does not imply any affiliation with or endorsement of CBRE. Photos herein are the property of their respective owners. Use of these images without the express written consent of the owner is prohibited.

